





# BSP



**30.01**  
**CASQUILHO M/M BSP**



**30.02**  
**CASQUILHO M/M BSP/NPT**



**30.03**  
**CASQ. REDUCAO M/M BSP**



**30.04**  
**ADAPTADOR M/F BSP**



**30.05**  
**REDUCAO BSP M/F**



**30.07**  
**PROLONGAMENTO M/F BSP  
LONGO**



**30.08**  
**PROLONGAMENTO F/F BSP**



**30.09**  
**CASQ. TRESPASSE M/M BSP**



**30.10**  
**UNIAO M/F GIRATORIA**



**30.11**  
**UNIAO F/F GIRATORIA BSP**



**30.35**  
**JOELHO M/M BSP-BSPT**



**30.20**  
**JOELHO 90º M/M  
ORIENTAVEL BSP**



**30.21**  
**JOELHO M/F GIRATORIO BSP**



**30.34**  
**JOELHO M/F BSP ORIENTÁVEL  
/ GIRATÓRIO**



**30.15**  
**UNIAO CURVA M/F**



**30.36**  
**JOELHO FF BSP**



**30.19**  
**UNIAO CURVA F/F**



**30.40**  
**JOELHO F/F GIRATORIO BSP**



**30.22**  
**JOELHO 45º M/M  
ORIENTAVEL BSP**



**30.23**  
**JOELHO 45º M/F BSPT/BSPT  
GIRATÓRIO**

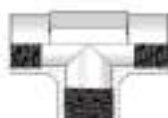

**30.37**  
**TE FEMEA BSP**

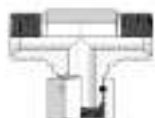

**30.25**  
**TE BSP M/M FEMEA CENTRAL**



**30.26**  
**TE BSP M/M FEMEA LATERAL**



**30.38**  
**TE M/M BSP ORIENTAVEL  
LATERAL**



**30.24**  
**TE MACHO BSP**



**30.39**  
**TE M/M BSP ORIENTAVEL  
CENTRAL**



**30.70**  
**CASQUILHO M/M**



**30.72**  
**CASQUILHO REDUÇÃO M/M  
BSP/MÉTRICO 60°**



**30.74**  
**ADAPTADOR M/F BSP x MET.**



**30.27**  
**TAMPAO MACHO BSP**



**25.81**  
**VSTI TAMPAO MACHO BSP**



**30.28**  
**TAMPAO GIRATORIO FEMEA  
BSP**



**30.41**  
**Tampão Macho Cônico  
DIN906**



**30.42**  
**Tampão Macho Cônico  
DIN906**



**30.12**  
**PARAFUSO BANJO BSP**



**30.13**  
**PARAFUSO BANJO DUPLO  
BSP**



**30.14**  
**PARAFUSO BANJO MET.**



**30.50**  
**PARAFUSO BANJO DUPLO  
MET.**



**30.16**  
**BANJO C/ROSCA GAS**



**30.17**  
**BANJO C/ROSCA MET.**



**30.33**  
**PORCA BSP**



**30.30**  
**TAMPAO FEMEA MET**



**30.29**  
**TAMPAO MACHO MET**

## JIC



**31.09**  
**UNIÃO F/F GIRATÓRIA JIC**



**31.02**  
**CASQUILHO JIC**



**31.03**  
**CASQUILHO JIC X JIC**



**31.04**  
**CASQUILHO TRESPASSE JIC**



**31.32**  
**CASQUILHO JIC x BSP**



**31.34**  
**CASQUILHO JIC x BSPT**



**31.24**  
**CASQUILHO M/M JIC x UNF**



**31.48**  
**CASQUILHO JIC x MET**



**31.38**  
**RACORD JIC x F. BSP**



**31.23**  
**CASQ. M/F GIRATORIO JIC x JIC**



**31.25**  
**ADAPTADOR M/F GIRATORIO UNF x JIC**



**31.36**  
**RACORD F. GIRATORIO JIC x M. BSP**



**31.26**  
**JOELHO 45° JIC x UNF ORIENT.**



**31.40**  
**JOELHO 45° JIC x BSP ORIENT.**



**31.49**  
**JOELHO 45° JIC x MET ORIENT.**



**31.10**  
**JOELHO 45° M/F GIRATÓRIO JIC**



**31.06**  
**JOELHO JIC**



**31.44**  
**JOELHO JIC x BSPT**



**31.28**  
**JOELHO M/M JIC x UNF ORIENT.**



**31.42**  
**JOELHO JIC x BSP ORIENT.**



**31.50**  
**JOELHO JIC x MET ORIENT.**



**31.43**  
**JOELHO BSP x UNF ORIENT.**



**31.08**  
**JOELHO 90° TRESPASSE JIC**



**31.12**  
**JOELHO M/F GIRATORIO JIC**



**31.14**  
**T JIC**



**31.31**  
**T M/M JIC X UNF CENTRAL ORIENT.**



**31.30**  
**T JIC M/M ORIENT. LATERAL UNF**



**31.46**  
**T JIC x BSP CENTRAL**



**31.47**  
**T JIC x BSP LATERAL**



**31.18**  
**T JIC M/M FEMEA CENTRAL**



**31.16**  
**T JIC M/M FEMEA LATERAL**



**31.20**  
**PORCA JIC**



**31.22**  
**BICONE JIC**



**31.33**  
**PORCA JIC**



**31.80**  
**TAMPAO MACHO JIC**



**31.82**  
**TAMPAO FEMEA JIC**

## ORFS



**32.22**  
**CASQUILHO M/M ORFS BSP**



**32.02**  
**CASQUILHO M/M ORFS**



**32.04**  
**CASQUILHO TRESPASSE  
ORFS**



**32.06**  
**JOELHO M/M ORFS**



**32.08**  
**JOELHO M/F ORFS**

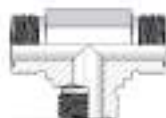

**32.10**  
**T M/M ORFS**



**32.12**  
**T ORFS M/M FEMEA LATERAL**



**32.14**  
**T ORFS M/M FEMEA CENTRAL**



**32.16**  
**CASQUILHO M/M ORFS x UNF**



**32.18**  
**JOELHO 45° M/M ORFS x UNF**



**32.20**  
**JOELHO 90° ORFS x UNF  
ORIENTAVEL**



**32.21**  
**T M/M ORFS x UNF CENTRAL**



**32.24**  
**JOELHO 45° M/M ORFS x BSP**



**32.26**  
**JOELHO 90° ORFS x BSP  
ORIENTAVEL**



**32.28**  
**ADAPTADOR M/F BSP x ORFS**



**32.70**  
**CASQUILHO ORFS x MÉTRICO**



**32.72**  
**JOELHO 90º ORFS x MÉTRICO**  
**ORIENT.**



**32.30**  
**TAMPAO MACHO ORFS**



**32.32**  
**TAMPAO FEMEA ORFS**

## DIN



**25.01**  
**BICONE**



**25.02**  
**PORCA**



**25.03**  
**GE TUBO BSP**



**25.04**  
**GE TUBO MÉTRICA**



**25.05**  
**GE TUBO BSPT**



**25.50**  
**GE TUBO BSP - WD (Vedante)**



**25.11**  
**G JUNCAO TUBO TUBO**



**25.14**  
**GR REDUCAO TUBO TUBO**



**25.08**  
**MAVE JUNCAO MANOMETRO.**



**25.44**  
**GAI JUNCAO TUBO / ROSCA**  
**BSP**



**25.46**  
**GAI JUNCAO TUBO / ROSCA**  
**MET.**



**25.07**  
**MAV JUNCAO MANOMETRO**



**25.06**  
**EGE JUNCAO REGULAVEL BSP**



**25.30**  
**EGE JUNCAO REGULAVEL**  
**MET.**



**25.12**  
**SV JUNCAO TRESPASSE**



**25.26**  
**RHD VALV. DE RETENÇÃO**



**25.79**  
**GZ UNIAO F/F**



**25.80**  
**BUTZEN**



**25.13**  
**KOR REDUCAO REGULAVEL**



**25.10**  
**WE JOELHO TUBO BSPT**



**25.28**  
**WE JOELHO TUBO MET**



**25.15**  
**W JOELHO TUBO TUBO**



**25.17**  
**EW JOELHO REGULAVEL**

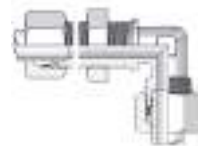

**25.16**  
**WSV JOELHO TRESPASSE**



**25.34**  
**CBB JOELHO TUBO BSP**  
**ORIENT.**



**25.09**  
**SWVE BANJO BSP**



**25.24**  
**SWVE BANJO MÉTRICO**



**25.25**  
**SWVE WHS**  
**BANJO**



**25.18**  
**T TUBO TUBO**

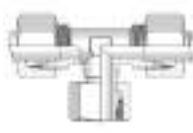

**25.19**  
**ET REGULAVEL**



**25.20**  
**EL REGULAVEL**



**25.22**  
**K CRUZETA**



**25.84**  
**VSTI TAMPAO MACHO**



**25.81**  
**VSTI TAMPAO MACHO BSP**



**25.82**  
**FEMEA KML**

## FLANGES



**30.95**  
**PAR FLANGE SAE3000**



**30.96**  
**PAR FLANGE SAE6000**



**30.92**  
**FLANGE SAE3000 ROSCA**  
**FÊMEA BSP**



**30.93**  
**Flange SAE6000 ROSCA**  
**FÊMEA BSP**



**30.90**  
**CONTRA-FLANGE SAE3000**  
**ROSCA FÊMEA BSP**

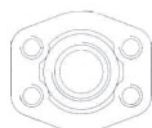

**30.91**  
**CONTRA-FLANGE SAE6000**  
**ROSCA FÊMEA BSP**



## ANILHAS E USITOS



**30.98**  
**ANILHA DE COBRE BSP**



**30.94**  
**USITO METRICO**



**30.99**  
**ANILHA DE COBRE**



**30.97**  
**USITO BSP**



**30.87**  
**ANILHA CARTAO BSP**  
**Rollmart**



**30.KIT**  
**KIT ANILHAS E USITOS**

## O-RING



**OR.KIT**  
**KIT O-RING**

# BSP

## CASQUILHO M/M BSP

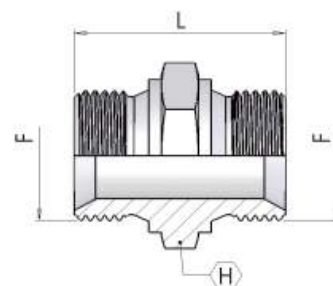
**30.01**

	MACHO	DIMENSÕES		PRESSÃO TRABALHO
CÓDIGO	F	H	L	BAR
30.01.02.02	1/8"	14	24	350
30.01.04.04	1/4"	19	32	350
30.01.06.06	3/8"	22	36	350
30.01.08.08	1/2"	27	42	315
30.01.10.10	5/8"	30	40	315
30.01.12.12	3/4"	32	42	250
30.01.16.16	1"	41	52	200
30.01.20.20	1.1/4"	50	57	160
30.01.22.22	M 22 x 1.5	22	35.5	160
30.01.24.24	1.1/2"	55	60	125
30.01.32.32	2"	70	71	80
30.01.40.40	2.1/2"	85	72	80
30.01.48.48	3"	95	75	80

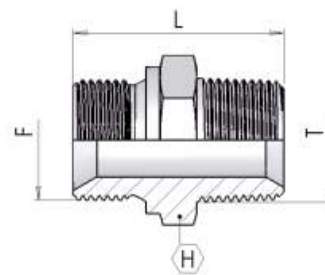
**CASQUILHO M/M BSP/NPT**
**30.02**

	MACHO	MACHO	DIMENSÕES		PRESSÃO TRABALHO
CÓDIGO	T	F	H	L	BAR
30.02.02.02	1/8"	1/8"	14	26	
30.02.04.04	1/4"	1/4"	19	35	350
30.02.06.06	3/8"	3/8"	22	36	350
30.02.08.08	1/2"	1/2"	27	44	315
30.02.12.12	3/4"	3/4"	32	48	250
30.02.16.16	1"	1"	41	55	200
30.02.20.20	1.1/4"	1-1/4"	50	59	160
30.02.24.24	1.1/2"	1.1/2"	55	63	125
30.02.32.32	2"	2"	70	69	80

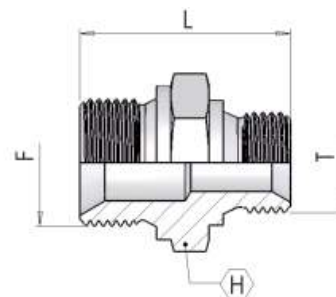
**CASQ. REDUCAO M/M BSP**
**30.03**

	MACHO	MACHO	DIMENSÕES		PRESSÃO TRABALHO
CÓDIGO	F	T	H	L	BAR
30.03.04.02	1/4"	1/8"	19	29	350
30.03.06.02	3/8"	1/8"	22	30	350
30.03.06.04	3/8"	1/4"	22	34	350
30.03.08.04	1/2"	1/4"	27	35	315
30.03.08.06	1/2"	3/8"	27	40	315
30.03.10.06	5/8"	3/8"	30	42	315
30.03.10.08	5/8"	1/2"	30	44	315
30.03.12.06	3/4"	3/8"	32	42	250
30.03.12.08	3/4"	1/2"	32	44	250
30.03.12.10	3/4"	5/8"	32	46	250
30.03.16.06	1"	3/8"	38	45	200
30.03.16.08	1"	1/2"	41	47	200
30.03.16.12	1"	3/4"	41	49	200
30.03.20.12	1.1/4"	3/4"	50	52	160
30.03.20.16	1.1/4"	1"	50	55	160
30.03.24.12	1.1/2"	3/4"	55	54	125
30.03.24.16	1.1/2"	1"	55	58	125
30.03.24.20	1.1/2"	1.1/4"	55	58	125
30.03.32.16	2"	1"	70	64	80
30.03.32.20	2"	1.1/4"	70	66	80
30.03.32.24	2"	1.1/2"	70	68	80
30.03.40.32	2.1/2"	2"	85	68	
30.03.48.32	3"	2."	95		
30.03.48.40	3"	2.1/2"	95	74	

# ADAPTADOR M/F BSP

30.04

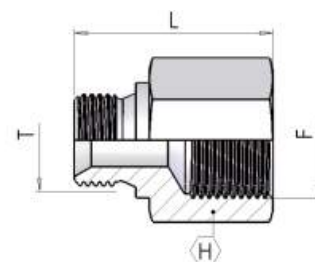

	MACHO	FÊMEA	DIMENSÕES		
CÓDIGO	T	F	L	H	BAR
30.04.02.04	1/8"	1/4"	28	19	350
30.04.02.06	1/8"	3/8"	32	22	350
30.04.04.02	1/4"	1/8"	29	19	350
30.04.04.06	1/4"	3/8"	35	22	350
30.04.04.08	1/4"	1/2"	36	27	315
30.04.04.12	1/4"	3/4"	42	32	315
30.04.06.04	3/8"	1/4"	33	22	315
30.04.06.08	3/8"	1/2"	37	27	315
30.04.06.12	3/8"	3/4"	43	32	250
30.04.08.04	1/2"	1/4"	37	27	250
30.04.08.06	1/2"	3/8"	39	27	250
30.04.08.12	1/2"	3/4"	45	32	250
30.04.08.16	1/2"	1"	45	41	250
30.04.12.06	3/4"	3/8"	39	32	200
30.04.12.08	3/4"	1/2"	38	32	200
30.04.12.16	3/4"	1"	47	41	200
30.04.12.20	3/4"	1.1/4"	51	50	200
30.04.16.08	1"	1/2"	42	41	
30.04.16.12	1"	3/4"	49	41	
30.04.16.20	1"	1.1/4"	53	50	
30.04.16.24	1"	1.1/2"	53	50	
30.04.20.16	1.1/4"	1"	51	50	
30.04.20.24	1.1/4"	1.1/2"	52	55	
30.04.20.32	1.1/4"	1.1/2"	52	55	
30.04.24.20	1.1/2"	1.1/4"	57	55	
30.04.24.32	1.1/4"	1.1/2"	52	55	

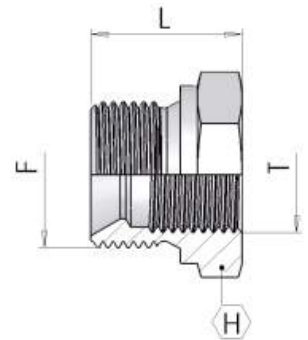
**REDUCAO BSP M/F**
**30.05**

	MACHO	FÊMEA	DIMENSÕES		PRESSÃO TRABALHO
CÓDIGO	F	T	L	H	BAR
30.05.04.02	1/4"	1/8"	22	19	350
30.05.06.02	3/8"	1/8"	22	22	350
30.05.06.04	3/8	1/4"	22	22	350
30.05.08.02	1/2	1/8"	25	27	315
30.05.08.04	1/2	1/4"	25	27	315
30.05.08.06	1/2	3/8"	29	27	315
30.05.12.04	3/4"	1/4"	27	32	250
30.05.12.06	3/4	3/8"	27	32	250
30.05.12.08	3/4	1/2"	27	32	250
30.05.16.06	1	3/8"	30	41	200
30.05.16.08	1	1/2"	30	41	200
30.05.16.12	1	3/4"	30	41	200
30.05.20.08	1.1/4	1/2"	50	32	160
30.05.20.12	1.1/4	3/4"	34	50	160
30.05.20.16	1.1/4	1"	34	50	160
30.05.24.08	1.1/2	1/2"	55	35	125
30.05.24.12	1.1/2	3/4"	55	36	125
30.05.24.16	1.1/2	1"	35	55	125
30.05.24.20	1.1/2	1.1/4"	39	55	125
30.05.32.16	2"	1"	43	70	
30.05.32.20	2	1.1/4"	43	70	80
30.05.32.24	2	1.1/2"	43	70	80
30.05.40.32					

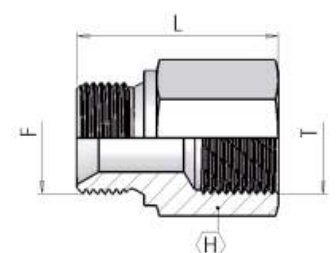
**PROLONGAMENTO M/F BSP LONGO**
**30.07**

	MACHO	FÊMEA	DIMENSÕES		PRESSÃO TRABALHO
CÓDIGO	F	T	L	H	BAR
30.07.02.02/026	1/8	1/8"	26	14	350
30.07.02.02/038	1/8	1/8"	38	14	350
30.07.04.04/033	1/4	1/4"	33	19	350
30.07.04.04/042	1/4	1/4"	42	19	350
30.07.04.04/055	1/4	1/4"	55	19	350
30.07.06.06/035	3/8	3/8"	35	22	350
30.07.06.06/054	3/8	3/8"	54	22	350
30.07.06.06/065	3/8	3/8"	65	22	350
30.07.08.08/045	1/2	1/2"	45	27	315
30.07.08.08/060	1/2	1/2"	60	27	315
30.07.08.08/080	1/2	1/2"	80	27	315
30.07.10.10/046	5/8	5/8"	41	30	250
30.07.10.10/060	5/8	5/8"	60	30	250
30.07.12.12/048	3/4	3/4"	48	32	250
30.07.12.12/075	3/4	3/4"	75	32	250
30.07.16.16/050	1"	1"	50	41	200
30.07.16.16/090	1	1"	90	41	200
30.07.20.20/062	1.1/4"	1.1/4"	62	50	160
30.07.24.24/055	1.1/2"	1.1/2"	62	50	160
30.07.32.32/063	2"	2"	62	50	160

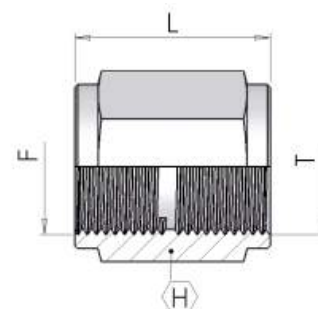
**PROLONGAMENTO F/F BSP**
**30.08**

	FÊMEA	FÊMEA	DIMENSÕES		PRESSÃO TRABALHO
CÓDIGO	F	T	L	H	BAR
30.08.02.02/021	1/8"	1/8"	21	14	350
30.08.04.04/029	1/4"	1/4"	29	19	350
30.08.04.04/066	1/4"	1/4"	66	19	350
30.08.06.06/029	3/8"	3/8"	29	22	350
30.08.06.06/070	3/8"	3/8"	70	22	350
30.08.08.08/034	1/2"	1/2"	34	27	315
30.08.08.08/080	1/2"	1/2"	80	27	350
30.08.12.12/038	3/4"	3/4"	38	32	250
30.08.12.12/100	3/4"	3/4"	100	32	300
30.08.16.16/043	1"	1"	43	41	200
30.08.20.20/047	1.1/4"	1.1/4"	47	50	160
30.08.24.24/051	1.1/2"	1.1/2"	51	55	125
30.08.32.32/057	2"	2"	57	70	80



**CASQ. TRESPASSE M/M BSP**

**30.09**

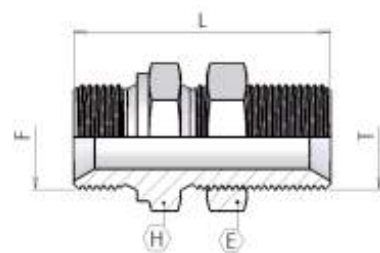

	MACHO	MACHO	DIMENSÕES			PRESSÃO TRABALHO
CÓDIGO	T	F	L	H	E	BAR
30.09.04.04	1/4"	1/4	46	19	19	350
30.09.06.06	3/8"	3/8	54	22	22	350
30.09.08.08	1/2"	1/2	57	27	27	315
30.09.12.12	3/4"	3/4	65	32	32	250
30.09.16.16	1"	1"	73	41	41	200
30.09.20.20	1.1/4"	1.1/4	79	50	50	125

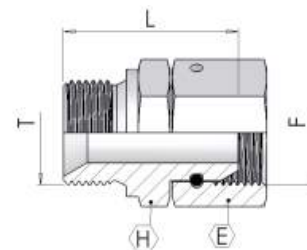
**UNIAO M/F GIRATORIA**
**30.10**

	MACHO	FÊMEA	DIMENSÕES			PRESSÃO TRABALHO
CÓDIGO	T	F	E	L	H	BAR
30.10.02.02	1/8"	1/8"	14	22.50	14	
30.10.02.04	1/8"	1/4"	19	27	14	350
30.10.04.04	1/4"	1/4"	19	32	19	350
30.10.04.06	1/4"	3/8"	22	33	19	350
30.10.06.04	3/8"	1/4"	19	31	22	350
30.10.06.06	3/8"	3/8"	22	35	22	350
30.10.06.08	3/8"	1/2"	27	36	22	315
30.10.08.06	1/2"	3/8"	22	38	27	315
30.10.08.08	1/2"	1/2"	27	40	27	315
30.10.08.10	1/2"	5/8"	30	37	27	315
30.10.08.12	1/2"	3/4"	32	42	27	315
30.10.10.10	5/8"	5/8"	30	41	30	315
30.10.12.12	3/4"	3/4"	32	44	32	250
30.10.12.16	3/4"	1"	38	44	32	200
30.10.16.12	1"	3/4"	32	47	41	200
30.10.16.16	1"	1"	38	49	41	200
30.10.20.20	1.1/4"	1.1/4"	50	55	50	160

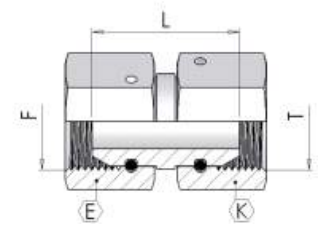
**UNIAO F/F GIRATORIA BSP**
**30.11**

	FÊMEA	FÊMEA	DIMENSÕES			PRESSÃO TRABALHO
CÓDIGO	F	T	E	L	K	BAR
30.11.02.02	1/8"	1/8"				
30.11.04.04	1/4"	1/4"	19	22	19	350
30.11.06.06	3/8"	3/8"	22	29	22	350
30.11.08.08	1/2"	1/2"	27	32	27	315
30.11.12.12	3/4"	3/4"	32	37	32	250
30.11.16.16	1"	1"	38	43	38	200
30.11.20.20	1.1/4"	1.1/4"	50	50	50	160
30.11.24.24						
30.11.32.32	2"	2"				160

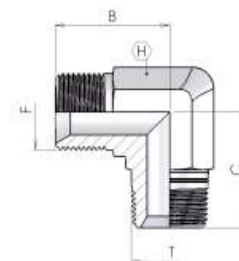
**JOELHO M/M BSP-BSPT**
**30.35**

	MACHO	MACHO	DIMENSÕES			PRESSÃO TRABALHO
CÓDIGO	F	T	B	C	H	BAR
30.35.0202	1/8"	1/8"	20	20	12	350
30.35.0404	1/4"	1/4"	27	27	14	350
30.35.0606	3/8"	3/8"	30	30	19	350
30.35.0808	1/2"	1/2"	37	37	22	350
30.35.1212	3/4"	3/4"	40	40	27	350
30.35.1616	1"	1"	50	50	33	350
30.35.2020	1.1/4"	1.1/4"	52	52	41	210
30.35.2424	1.1/2"	1.1/2"	60	63	48	
30.35.3232	2"	2"	70	75	65	

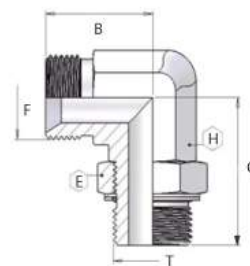
**JOELHO 90º M/M ORIENTAVEL BSP**
**30.20**

	MACHO	MACHO	DIMENSÕES				PRESSÃO TRABALHO
CÓDIGO	T	F	B	C	E	H	BAR
30.20.0404	1/4"	1/4"	27	31.5	19	14	350
30.20.0406	1/4"	3/8"	31.5	33.5	19	19	320
30.20.0604	3/8"	1/4"	27	37	22	19	320
30.20.0606	3/8"	3/8"	31.5	37	22	19	260
30.20.0608	3/8"	1/2"	37.5	39.5	22	22	260
30.20.0806	1/2"	3/8"	31.5	43	27	22	260
30.20.0808	1/2"	1/2"	36.5	43	27	22	260
30.20.0812	1/2"	3/4"	40	45.5	27	27	260
30.20.1208	3/4"	1/2"	37	49	36	27	260
30.20.1212	3/4"	3/4"	40	49	36	27	260
30.20.1216	3/4"	1"	50	49	36	33	260
30.20.1612	1"	3/4"	45	52	41	33	
30.20.1616	1"	1"	50	52	41	33	210
30.20.1620	1"	1.1/4"	52	52	41	41	210
30.20.2016	1.1/4"	1"	51	57	50	41	
30.20.2020	1.1/4"	1.1/4"	52	57	50	41	160
30.20.2424	1.1/2"	1.1/2"	59	61	55	48	120

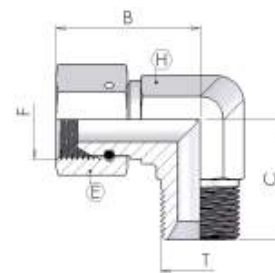
**JOELHO M/F GIRATORIO BSP**
**30.21**

	FÊMEA	MACHO	DIMENSÕES				PRESSÃO TRABALHO
CÓDIGO	F	T	B	C	H	E	BAR
30.21.0404	1/4	1/4"	29	27	14	19	350
30.21.0606	3/8	3/8"	34	31.5	19	22	350
30.21.0808	1/2	1/2"	40	37	22	27	315
30.21.1010	5/8"	5/8"	42	36	27	30	310
30.21.1212	3/4	3/4"	46	40	27	32	310
30.21.1616	1	1"	51.5	50	33	41	240
30.21.2020	1.1/4	1.1/4"	57	52	41	50	200
30.21.2424	1.1/2	1.1/2"	64	59	48	55	140
30.21.3232	2	2"	70	68	65	70	

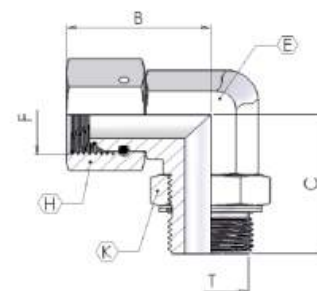
**JOELHO M/F BSP ORIENTÁVEL / GIRATÓRIO**
**30.34**

	FÊMEA	MACHO	DIMENSÕES					PRESSÃO TRABALHO
CÓDIGO	F	T	B	C	E	H	K	BAR
30.34.0404	1/4"	1/4"	29	31.5	14	19	19	350
30.34.0606	3/8"	3/8"	34	37	19	22	22	320
30.34.0808	1/2"	1/2"	40	43	22	27	27	260
30.34.1212	3/4"	3/4"	46	49	27	32	36	260
30.34.1616	1"	1"	51.5	52	33	41	41	210
30.34.2020	1.1/4"	1.1/4"	57	57	41	50	50	160

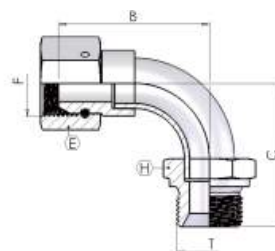
**UNIAO CURVA M/F**
**30.15**

	MACHO	FÊMEA	DIMENSÕES				PRESSÃO TRABALHO
CÓDIGO	F	T	B	C	H	E	BAR
30.15.04.04	1/4	1/4"	30	32	19	19	350
30.15.06.06	3/8	3/8"	37	38	22	22	350
30.15.08.08	1/2	1/2"	44	43	27	27	315
30.15.12.12	3/4	3/4"	59	62	32	32	250
30.15.16.16	1	1"	66	68	41	38	200
30.15.20.20	1.1/4	1.1/4"	71	76	50	50	160
30.15.24.24	1.1/2"	1.1/2"	86	86	55	55	
30.15.32.32	2"	2"					

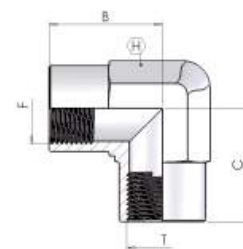

**JOELHO FF BSP**
**30.36**

	FÊMEA	FÊMEA	DIMENSÕES			PRESSÃO TRABALHO
CÓDIGO	F	T	B	C	H	BAR
30.36.02	1/8		17	17	14	350
30.36.04	1/4	1/4	22	22	19	350
30.36.06	3/8	3/8	26	26	22	350
30.36.08	1/2	1/2	31	31	27	315
30.36.12	3/4	3/4	35	35	33	250
30.36.16	1"	1	44	44	41	200
30.36.20	1.1/4	1.1/4	52	52	48	200
30.36.24	1.1/2"	1.1/2"	52	52	60	
30.36.32	2"	2"	60	60	70	

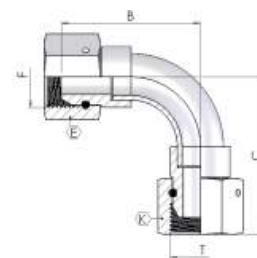
**UNIAO CURVA F/F**
**30.19**

	FÊMEA	FÊMEA	DIMENSÕES				PRESSÃO TRABALHO
CÓDIGO	F	T	B	C	K	E	BAR
30.19.04.04	1/4	1/4"	30	35	19	19	350
30.19.06.06	3/8	3/8"	37	43	22	22	350
30.19.08.08	1/2	1/2"	44	19	27	27	315
30.19.12.12	3/4	3/4"	59	67	32	32	250
30.19.16.16	1	1"	66	76	38	38	200
30.19.20.20	1.1/4	1.1/4"	71	50	50	50	160

# JOELHO F/F GIRATORIO BSP

30.40

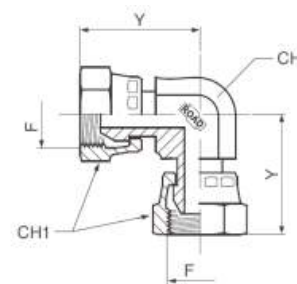

	ROSCA	DIMENSÕES			PRESSÃO
CÓDIGO	F	Y	CH	CH1	BAR
30.40.04	1/4	29	14	19	350
30.40.06	3/8	34	19	22	350
30.40.08	1/2"	40	22	27	350
30.40.12	3/4	42	27	30	350
30.40.16	1"	51.5	33	41	350

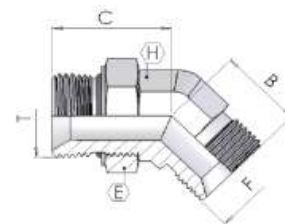
**JOELHO 45º M/M ORIENTAVEL BSP**
**30.22**

	MACHO	MACHO	DIMENSÕES				PRESSÃO TRABALHO
CÓDIGO	T	F	C	B	E	H	BAR
30.22.0404	1/4"	1/4"	29	21	19	14	350
30.22.0606	3/8"	3/8"	35	25	22	19	260
30.22.0808	1/2"	1/2"	38	28	27	22	260
30.22.1212	3/4"	3/4"	44	33	36	27	260
30.22.1616	1"	1"	47	37	41	33	210
30.22.2020	1.1/4"	1.1/4"	37	40	50	41	

# JOELHO 45º M/F BSPT/BSP GIRATÓRIO

30.23

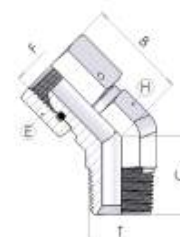

	MACHO	FÊMEA	DIMENSÕES				PRESSÃO TRABALHO
CÓDIGO	T	F	B	C	H	E	BAR
30.23.0404	1/4"	1/4"	21	21	14	19	350
30.23.0606	3/8"	3/8"	25	25	19	22	350
30.23.0808	1/2"	1/2"	28	28	22	27	315
30.23.1212	3/4"	3/4"	33	33	27	32	250
30.23.1616	1"	1"	37	37	33	38	200
30.23.2020	1.1/4"	1.1/4"	46	42	41	50	160
30.23.2424	1.1/2"	1.1/2"	50	50	41	55	160

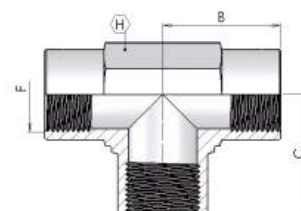
**TE FEMEA BSP**
**30.37**

	FÊMEA	DIMENSÕES			PRESSÃO TRABALHO
CÓDIGO	F	B	C	H	BAR
30.37.02	1/8	17	17	14	350
30.37.04	1/4	22	22	19	350
30.37.06	3/8	26	26	22	350
30.37.08	1/2	31	31	27	210
30.37.12	3/4	35	35	33	210
30.37.16	1	44	44	41	140
30.37.20	1.1/4"	50	50	48	100
30.37.24	1.1/2"	52	52	60	
30.37.32	2"	60	60	70	60

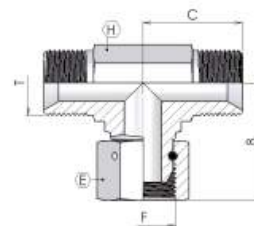
**TE BSP M/M FEMEA CENTRAL**
**30.25**

	FÊMEA	MACHO	DIMENSÕES				PRESSÃO TRABALHO
CÓDIGO	F	T	B	C	E	H	BAR
30.25.0404	1/4	1/4"	27	29	19	14	350
30.25.0606	3/8	3/8"	31.5	34	22	19	350
30.25.0808	1/2	1/2"	37	40	27	22	310
30.25.1212	3/4	3/4"	40	46	27	32	310
30.25.1616	1	1"	50	52	33	41	200
30.25.2020	1.1/4	1.1/4"	52	57	41	50	200
30.25.2424							

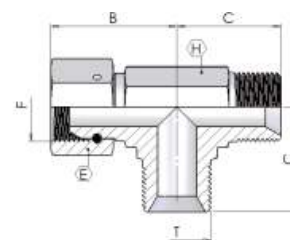
**TE BSP M/M FEMEA LATERAL**
**30.26**

	FÊMEA	MACHO	DIMENSÕES				PRESSÃO TRABALHO
CÓDIGO	F	T	B	C	E	H	BAR
30.26.0404	1/4	1/4"	27	31	19	14	350
30.26.0606	3/8	3/8"	31.5	34	22	19	350
30.26.0808	1/2	1/2"	37	40	27	22	350
30.26.1212	3/4	3/4"	40	46	32	27	310
30.26.1616	1	1"	50	52	41	33	240
30.26.2020	1.1/4	1.1/4"	61	52	50	41	200
30.26.2424	1.1/2"	1.1/2"	59	61	55	48	140

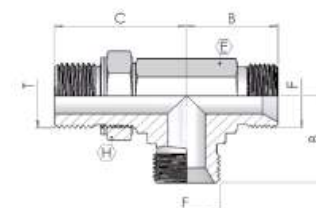

**TE M/M BSP ORIENTAVEL LATERAL**
**30.38**

	MACHO	MACHO	DIMENSÕES				PRESSÃO TRABALHO
CÓDIGO	T	F	B	C	H	E	BAR
30.38.0404	1/4	1/4"	27	31.5	14	19	350
30.38.0606	3/8	3/8"	31.5	36.5	22	19	260
30.38.0808	1/2	1/2"	37	43	27	22	260
30.38.1212	3/4	3/4"	40	49	36	27	260
30.38.1616	1	1"	50	52	41	33	210
30.38.2020	1.1/4	1.1/4"	52	57	50	41	160

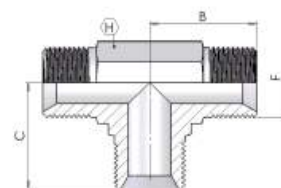
**TE MACHO BSP**
**30.24**

	MACHO	DIMENSÕES			PRESSÃO TRABALHO
CÓDIGO	F	B	C	H	BAR
30.24.02	1/8	20	20	12	350
30.24.04	1/4	27	27	14	350
30.24.06	3/8	28	28	19	350
30.24.08	1/2	34	34	22	350
30.24.12	3/4	40	40	27	310
30.24.16	1	50	50	33	260
30.24.20	1.1/4	52	52	41	180
30.24.24	1.1/2	59	59	48	150
30.24.32	2"	70	70	65	

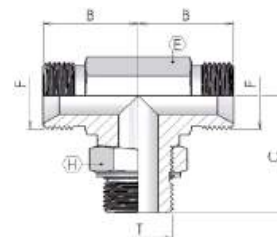
**TE M/M BSP ORIENTAVEL CENTRAL**
**30.39**

	MACHO	MACHO	DIMENSÕES				PRESSÃO TRABALHO
CÓDIGO	F	T	B	C	H	E	BAR
30.39.0404	1/4"	1/4	27	31.5	19	14	350
30.39.0604	3/8"	1/4	31.5	33.5	19	27.5	260
30.39.0606	3/8"	3/8	31.5	36.5	22	27.5	260
30.39.0808	1/2"	1/2	37	43	27	22	260
30.39.1212	3/4"	3/4	40	49	36	27	260
30.39.1616	1"	1	50	52	41	33	210
30.39.2020	1.1/4"	1.1/4	52	57	50	41	160

**CASQUILHO M/M**

**30.70**

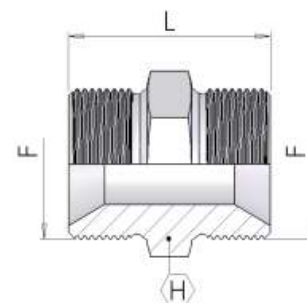

	MACHO	DIMENSÕES		PRESSÃO TRABALHO
CÓDIGO	F	L	H	BAR
30.70.14	M14x1.5	24	19	350
30.70.16	M 16 x 1.5	34	22	350
30.70.18	M18x1.5	24	24	350
30.70.20	M 20 x 1.5		27	350
30.70.22	M22x1.5	24	27	315
30.70.30	M 30x1.5	47.30	36	

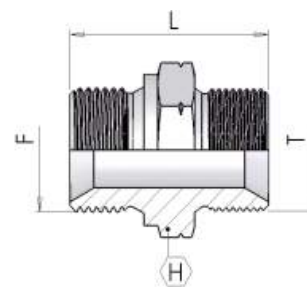
**CASQUILHO REDUÇÃO M/M BSP/MÉTRICO 60º**
**30.72**

	MACHO	MACHO	DIMENSÕES		PRESSÃO TRABALHO
CÓDIGO	T	F	L	H	BAR
30.72.0414	1/4"	M14x1.5	32	19	350
30.72.0616	3/8"	M16x1.5	33	22	350
30.72.0618	3/8"	M18x1.5	36	24	350
30.72.0816	1/2"	M16x1.5	37	27	315
30.72.0818	1/2"	M18 x1.5	38	27	315
30.72.0822	1/2	M22x1.5	38	27	315

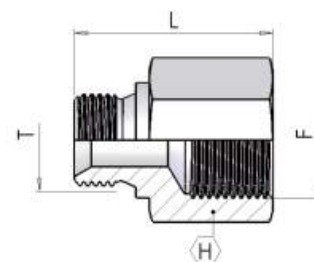
**ADAPTADOR M/F BSP x MET.**
**30.74**

	MACHO	FÊMEA	DIMENSÕES		PRESSÃO TRABALHO
CÓDIGO	T	F	L	H	BAR
30.74.04.M16	1/4"	M16x1.5			
30.74.06.M16	3/8"	M16 x1.5	35	24	250
30.74.06.M18	3/8"	M18x1.5	35	25	250
30.74.08.M16	1/2"	M16 x1.5	40	27	250
30.74.08.M18	1/2"	M18x1.5	37	27	250
30.74.08.M22	1/2"	M22x1.5	38	27	250
30.74.M16.06	M 16 x 1.5	3/8	35	24	250
30.74.M18.06	M18 x 1.5	3/8	35	24	250
30.74.M22.06	M 22 x 1.5	3/8"	35	25	250
30.74.M22.08	M 22x1.5	1/2	41	27	250
30.74.M22.M16	M22x1.5	M16x1.5	35	27	250
30.74.M22.M18	M22x1.5	M18x1.5	35	27	250

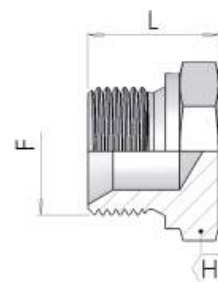
**TAMPAO MACHO BSP**
**30.27**

	MACHO	DIMENSÕES		PRESSÃO TRABALHO
CÓDIGO	F	L	H	BAR
30.27.02	1/8	15	14	350
30.27.04	1/4	19	19	350
30.27.06	3/8	22	22	350
30.27.08	1/2	25	27	315
30.27.10	5/8	27	30	315
30.27.12	3/4	27	32	250
30.27.16	1	30	41	200
30.27.20	1.1/4	34	50	160
30.27.24	1.1/2	39	55	125
30.27.32	2	43	70	80

# VSTI TAMPAO MACHO BSP

25.81

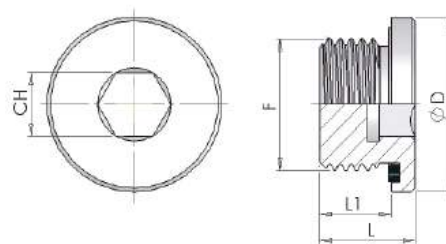

	ROSCA					PRESSÃO
CÓDIGO	R	Ø D	CH	L	L1	
25.81.02	1/8"	14	5	12	8	400
25.81.04	1/4"	19	6	17	12	400
25.81.06	3/8"	22	8	17	12	400
25.81.08	1/2"	27	10	19	14	400
25.81.12	3/4"	32	12	21	16	400
25.81.16	1"	40	17	22.50	16	400
25.81.20	1.1/4"	50	22	22.50	16	250
25.81.24	1.1/2"	55	24	22.50	16	250
25.81.32	2"	72	32	34,5	24	160

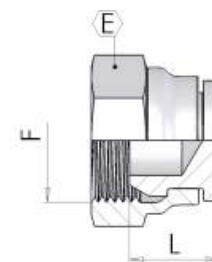

**TAMPAO GIRATORIO FEMEA BSP**
**30.28**

	FÊMEA	DIMENSÕES		PRESSÃO TRABALHO
CÓDIGO	F	L	E	BAR
30.28.02	1/8	11	14	350
30.28.04	1/4	14	19	350
30.28.06	3/8	15	22	350
30.28.08	1/2	16	27	315
30.28.10	5/8	16	30	315
30.28.12	3/4	18	32	250
30.28.16	1	20	38	200
30.28.20	1.1/4	24	50	160
30.28.24	1.1/2	27	55	125
30.28.32	2	24	70	80

## Tampão Macho Cônico DIN906

30.41

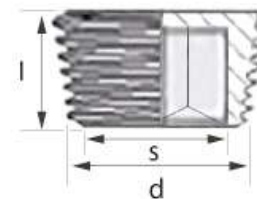

CÓDIGO	DIMENSÕES		
	d	l	s
30.41.02	1/8	8	5
30.41.04	1/4	10	7
30.41.06	3/8	10	8
30.41.08	1/2	10	10
30.41.12	3/4	12	12

**Tampão Macho Cônico DIN906**

**30.42**

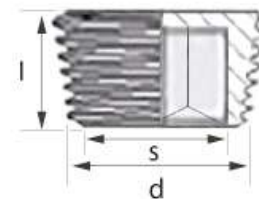

	DIMENSÕES		
CÓDIGO	d	l	s
30.42.20	M20x1.5c	10	10

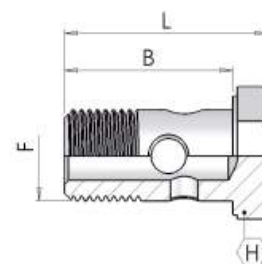
**PARAFUSO BANJO BSP**
**30.12**

	DIMENSÕES				PRESSÃO TRABALHO
CÓDIGO	F	B	H	L	BAR
30.12.02	1/8"	19	14	24	350
30.12.04	1/4"	29	19	34	350
30.12.06	3/8"	33	22	41	350
30.12.08	1/2"	38	27	46	315
30.12.12	3/4"	47	32	56	250
30.12.16	1"	58	38	69	200

# PARAFUSO BANJO DUPLO BSP

30.13

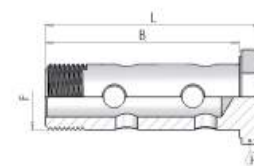

	DIMENSÕES				PRESSÃO TRABALHO
CÓDIGO	F	B	H	L	BAR
30.13.04	1/4"	43	19	49	350
30.13.06	3/8"	49	22	57	350
30.13.08	1/2"	64	27	73	315
30.13.12	3/4"	78	32	87	250

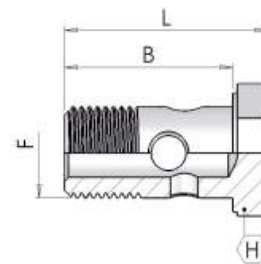
**PARAFUSO BANJO MET.**
**30.14**

CÓDIGO	DIMENSÕES				PRESSÃO TRABALHO
	F	B	L	E	BAR
30.14.08	M8 x 1.0	17	22	12	350
30.14.09	M8 x 1.25	17	22	12	350
30.14.10	M10 x 1.0	19	24	14	350
30.14.11	M10 x 1.5	19	25		350
30.14.12	M12 x 1.5	26	31	17	350
30.14.14	M14 x 1.5	29	34	19	350
30.14.16	M16 x 1.5	33	41	22	350
30.14.18	M18 x 1.5	37	44	24	350
30.14.20	M20 x 1.5	38	46	27	315
30.14.22	M22 x 1.5	38	46	27	315
30.14.25					

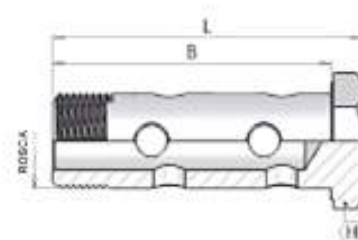
**PARAFUSO BANJO DUPLO MET.**
**30.50**

CÓDIGO	ROSCA	DE (mm)	H	B (mm)	L (mm)
30.50.08	M 8 x 1.0	8	12	27	32
30.50.10	M 10 x 1.0	10	14	30	36
30.50.12	M 12 x 1.5	12	17	38	44
30.50.14	M 14x 1.5	14	19	42	48
30.50.16	M 16x 1.5	16	22	46	52
30.50.18	M 18x 1.5	18	24	53	58
30.50.22	M 22x 1.5	22	27	69	75

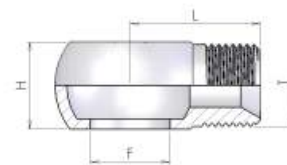
**BANJO C/ROSCA GAS**
**30.16**

	DIMENSÕES				PRESSÃO TRABALHO
CÓDIGO	T	F (Olhal)	L	H	BAR
30.16.04.04	1/4"	1/4	24	14.5	350
30.16.04.14	M14x1.5	1/4	25	14	350
30.16.06.04	1/4"	3/8	26	17	350
30.16.06.06	3/8"	3/8	28	17	350
30.16.06.08	1/2"	3/8	28	22	315
30.16.06.18	M18x1.5	3/8	28	17	350
30.16.08.06	3/8"	1/2	30	22	315
30.16.08.08	1/2"	1/2	32	22	315
30.16.12.12	3/4"	3/4	38	29	250

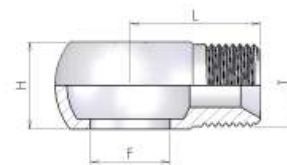

**BANJO C/ROSCA MET.**
**30.17**

	DIMENSÕES				PRESSÃO TRABALHO
CÓDIGO	T	F (Olhal)	L	H	BAR
30.17.14.14	M 14 x 1.5	14 mm	24	14	350
30.17.16.16	M 16 x 1.5	16 mm	28	18	350
30.17.18.18	M 18x1.5	18 mm	30	20	350
30.17.22.22	M 22x1.5	22 mm	36	22	315

**PORCA BSP**
**30.33**

	ROSCA	DIMENSÕES	
CÓDIGO	R	CH1	L
30.33.04	1/4"	14	5
30.33.06	3/8"	22	8
30.33.08	1/2"	27	9.0
30.33.10	5/8"	30	9
30.33.12	3/4"	32	10
30.33.16	1"	41	11.0
30.33.20	1.1/4"	50	13.0
30.33.24	1.1/2"	55	13.0

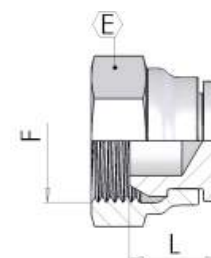
**TAMPAO FEMEA MET**
**30.30**

	FÊMEA	DIMENSÕES		PRESSÃO TRABALHO
CÓDIGO	F	L	E	BAR
30.30.12	M12 x 1.5	11	17	350
30.30.14	M14 x 1.5	12	19	350
30.30.16	M16 x 1.5	15	22	350
30.30.18	M18 x 1.5	15	24	350
30.30.20	M20 x 1.5	18	27	315
30.30.22	M22 x 1.5	18	27	315
30.30.26	M26 x 1.5	20	32	250

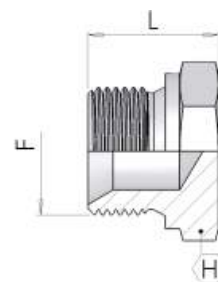
**TAMPAO MACHO MET**
**30.29**

	FÊMEA	DIMENSÕES	
CÓDIGO	F	H	L
30.29.10	M 10 x 1.0	14	13
30.29.12	M 12 x 1.5	17	19
30.29.14	M 14 x 1.5	19	19
30.29.16	M 16 x 1.5	22	19
30.29.18	M 18 x 1.5	24	20
30.29.20	M 20 x 1.5	27	22
30.29.22	M 22 x 1.5	27	22
30.29.24	M 24 x 1.5	30	22
30.29.26	M 26 x 1.5	32	24
30.29.27	M 27 x 1.5		
30.29.30	M 30 x 1.5	36	26
30.29.42	M 42 x 2.0	46	32

# JIC

## UNIÃO F/F GIRATÓRIA JIC

31.09

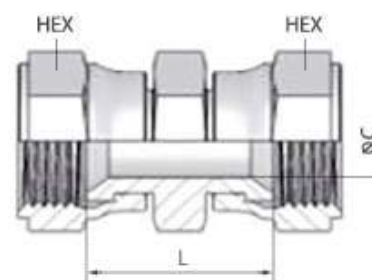

CÓDIGO	Ø TUBO	DIMENSÕES		
	in	L	HEX	C
31.09.0404	7/16"	21	14	4
31.09.0505	1/2"	30	24	10
31.09.0606	9/16"	25	19	6
31.09.0808	3/4"	30	24	10
31.09.1010	7/8"	31.4	27	12
31.09.1212	1.1/16"	36	32	15
31.09.1616	1.5/16"	36	41	20

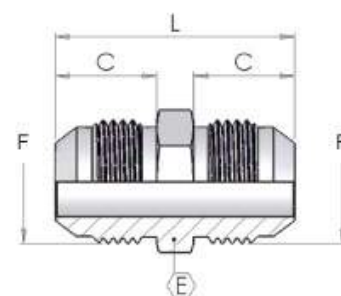
**CASQUILHO JIC**
**31.02**

	MACHO	DIMENSÕES			PRESSÃO TRABALHO
CÓDIGO	F	C	E	L	BAR
31.02.04	7/16"	14	14	34	350
31.02.05	1/2"	14	14	34.5	350
31.02.06	9/16"	14	17	35.5	350
31.02.08	3/4"	17	22	41	350
31.02.10	7/8"	19.5	24	47.5	350
31.02.12	1.1/16"	22	30	55	350
31.02.14	1.3/16"	22	32	56	280
31.02.16	1.5/16"	23	36	57	280
31.02.20	1.5/8"	24.5	46	61.5	210
31.02.24	1.7/8"	27.5	50	69.5	140

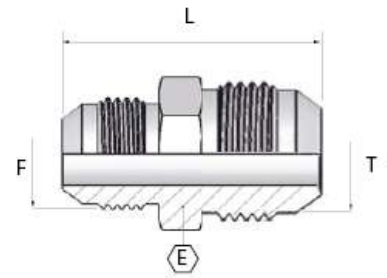
**CASQUILHO JIC X JIC**
**31.03**

	MACHO	MACHO	DIMENSÕES		PRESÃO TRABALHO
CÓDIGO	T	F	L	E	BAR
31.03.0608	3/4	9/16	38.6	19	350
31.03.0810	7/8	3/4	47.5	24	350
31.03.1012	1.1/16	7/8	55	30	350
31.03.1216	1.5/16	1.1/16	57.6	36	350

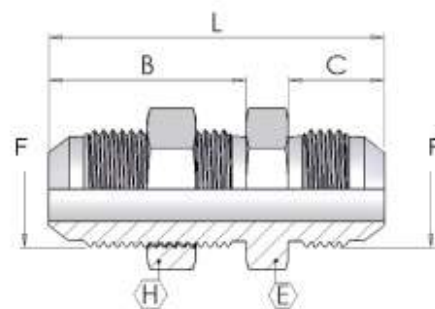
**CASQUILHO TRESPASSE JIC**
**31.04**

	MACHO	DIMENSÕES					PRESSÃO TRABALHO
CÓDIGO	F	L	C	B	H	E	BAR
31.04.04	7/16"	52.5	14	30.5	17	17	350
31.04.05	1/2"	52.5	14	30.5	19	19	350
31.04.06	9/16"	55.5	14	32.5	22	22	350
31.04.08	3/4"	62	17	36.5	24	24	350
31.04.10	7/8"	69.5	19.5	40	30	30	350
31.04.12	1.1/6"	78.5	22	45.5	36	36	350
31.04.16	1.5/16"	80	23	44.5	36	36	280
31.04.20	1.5/8"	84	24.5	45.7	50	50	210
31.04.24	1.7/8"	89.5	27.5	46	55	55	140

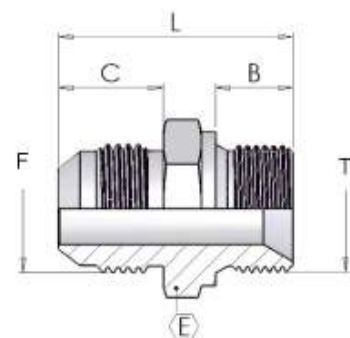
**CASQUILHO JIC x BSP**
**31.32**

	MACHO	MACHO	DIMENSÕES				PRESSÃO TRABALHO
CÓDIGO	F	T	C	L	B	E	BAR
31.32.0402	7/16"	1/8"	14	29	7	16	350
31.32.0404	7/16"	1/4"	14	34.5	10	19	350
31.32.0406	7/16"	3/8"	14	34.5	10	22	350
31.32.0408	7/16"	1/2"	14	38	12	30	350
31.32.0504	1/2"	1/4"	14	34.5	10	19	350
31.32.0506	1/2"	3/8"	14	34.5	10	22	350
31.32.0604	9/16"	1/4"	14	34.5	10	19	350
31.32.0606	9/16"	3/8"	14	34.5	10	22	350
31.32.0608	9/16"	1/2"	14	38	12	30	350
31.32.0804	3/4"	1/4"	17	37.5	10	22	350
31.32.0806	3/4"	3/8"	17	37.5	10	22	350
31.32.0808	3/4"	1/2"	17	41	12	30	350
31.32.0812	3/4"	3/4"	17	45	14	36	350
31.32.1006	7/8"	3/8"	19.5	40.5	10	24	350
31.32.1008	7/8"	1/2"	19.5	43.5	12	30	350
31.32.1008/H27	7/8"	1/2"	19.3	43.5	14	27	250
31.32.1012	7/8"	3/4"	19.5	47.5	16	36	250
31.32.1208	1.1/16"	1/2"	22	47	12	30	350
31.32.1212	1.1/16"	3/4"	22	50	14	36	250
31.32.1216	1.1/16"	1"	22	52.5	15.5	46	250
31.32.1612	1.5/16"	3/4"	23	51	14	36	250
31.32.1616	1.5/16"	1"	23	53.5	15.5	46	250
31.32.1620	1.5/16"	1.1/4"	23	57	17.5	50	180
31.32.2020	1.5/8"	1.1/4"	24.5	58.5	17.5	50	180
31.32.2024							
31.32.2420	1.7/8"	1.1/4"	27.5	61.5	17.5	50	140
31.32.2424	1.7/8"	1.1/2"	27.5	65.5	19.5	60	140

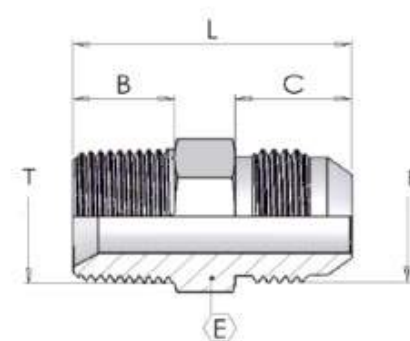

**CASQUILHO JIC x BSPT**
**31.34**

	MACHO	MACHO	DIMENSÕES				PRESSÃO TRABALHO
CÓDIGO	F	T	L	B	C	E	BAR
31.34.0402	7/16"	1/8"	31	8	14	14	350
31.34.0404	7/16"	1/4"	35.5	12	14	14	350
31.34.0502	1/2"	1/8"	31	8	14	14	350
31.34.0504	1/2"	1/4"	35.5	12	14	14	350
31.34.0602	9/16"	1/8"	36	8	14	17	350
31.34.0604	9/16"	1/4"	36	12	14	17	350
31.34.0606	9/16"	3/8"	36	12	14	19	350
31.34.0806	3/4"	3/8"	38	12	17	19	350
31.34.0808	3/4"	1/2"	43.5	14	17	22	350
31.34.1008	7/8"	1/2"	48	14	19.5	24	350
31.34.1212	1.1/16"	3/4"	52.5	16	22	27	350
31.34.1616	1.5/16"	1"	58.5	18	23	36	280
31.34.2020	1.5/8"	1.1/4"	62	20	24.5	46	210

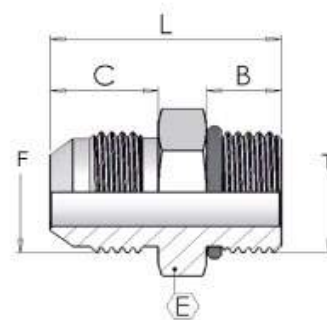
**CASQUILHO M/M JIC x UNF**
**31.24**

	MACHO	MACHO	DIMENSÕES				PRESSÃO TRABALHO
CÓDIGO	F	T	C	L	B	E	BAR
31.24.0404	7/16"-20	7/16"-20	14	31	9.5	14	350
31.24.0405	7/16"-20	1/2"-20	14	31	9.5	14	350
31.24.0406	7/16"-20	9/16"-18	14	33	10	17	350
31.24.0505	1/2"-20	1/2"-20	14	31	9.5	17	350
31.24.0604	9/16"	7/16"	14	9	9.5	17	350
31.24.0606	9/16"-18	9/16"-18	14	33	10	17	350
31.24.0608	9/16"-18	3/4"-16	14	34.5	11.5	22	350
31.24.0806	3/4"	9/16"	17	35	10	22	350
31.24.0808	3/4"-16	3/4"-16	17	37.5	11.5	22	350
31.24.0810	3/4"-16	7/8"-14	17	40.5	13	27	350
31.24.0812							
31.24.1008	7/8"-14	3/4"-16	19.5	40.5	11.5	24	350
31.24.1010	7/8"-14	7/8"-14	19.5	43	13	27	350
31.24.1012	7/8"-14	1.1/16"-12	19.5	47.5	15.5	32	350
31.24.1210	1.1/16"-12	7/8"-14	22	46.5	13	27	350
31.24.1212	1.1/16"-12	1.1/16"-12	22	50	15.5	32	350
31.24.1612	1.5/16"-12	1.1/16"-12	23	51	15.5	36	280
31.24.1616	1.5/16"-12	1.5/16"-12	23	52	15.5	38	280
31.24.2020	1.5/8"-12	1.5/8"-12	24.5	55	15.5	50	210
31.24.2424	1.7/8"-12	1.7/8"-12	27.5	60	15.5	55	140

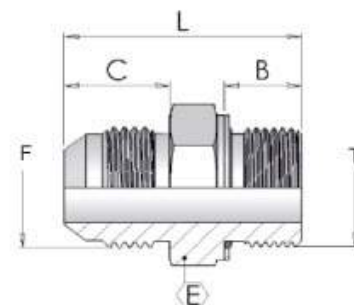
**CASQUILHO JIC x MET**
**31.48**

	MACHO	FÊMEA	DIMENSÕES				PRESSÃO TRABALHO
CÓDIGO	F	T	L	B	C	E	BAR
31.48.0410	7/16"	M10 x 1	30	9	14	17	350
31.48.0412	7/16"	M12 x 1.5	33	12	14	17	350
31.48.0510	1/2"	M10 x 1	30	9	14	16	350
31.48.0512	1/2"	M12 x 1.5	33	12	14	19	350
31.48.0612							
31.48.0614	9/16"	M14 x 1.5	34	12	14	19	350
31.48.0616	9/16"	M16 x 1.5	35	13	14	22	350
31.48.0816	3/4"	M16 x 1.5	38	13	17	22	350
31.48.0818	3/4"	M18 x 1.5	40	14	17	24	350
31.48.1018	7/8"	M18 x 1.5	42	14	20	24	350
31.48.1022	7/8"	M22 X 1.5	45	15	20	30	350
31.48.1222	1.1/16"	M22 x 1.5	48	15	22	30	350

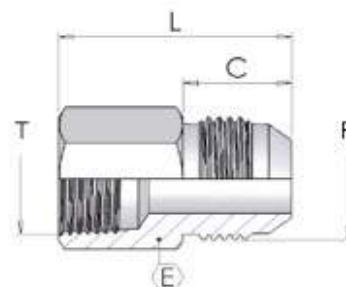
**RACORD JIC x F. BSP**
**31.38**

	MACHO	FÊMEA	DIMENSÕES			PRESSÃO TRABALHO
CÓDIGO	F	T	C	L	E	BAR
31.38.0402	7/16"	1/8"	14	30	14	350
31.38.0404	7/16"	1/4"	14	35.5	19	350
31.38.0502	1/2"	1/8"	14	30	14	350
31.38.0504	1/2"	1/4"	14	35.5	19	350
31.38.0604	9/16"	1/4"	14	33.5	19	350
31.38.0606	9/16"	3/8"	14	36.5	22.5	350
31.38.0806	3/4"	3/8"	17	39.5	22	350
31.38.0808	3/4"	1/2"	17	45.5	30	350
31.38.1008	7/8"	1/2"	19.5	48	30	350
31.38.1208	1.1/16"	1/2"	22	50.5	30	350
31.38.1212	1.1/16"	3/4"	22	52.5	36	350
31.38.1616	1.5/16"	1"	23	59.5	41	280
31.38.2020	1.5/8"	1.1/4"	24.5	63	50	210
31.38.2424	1.7/8"	1.1/2"	27.5	66.5	60	140

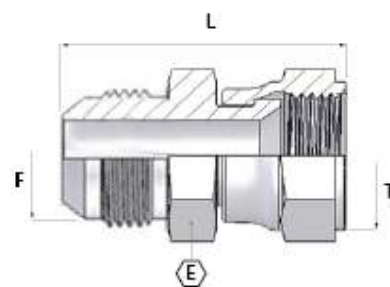
**CASQ. M/F GIRATORIO JIC x JIC**
**31.23**

	MACHO	FÊMEA	DIMENSÕES	
CÓDIGO	F	T	E	L
31.23.0606	9/16	9/16	17	37.7
31.23.0608	9/16	3/4	19	33
31.23.0806	3/4	7/8	22	48.7
31.23.0808	3/4	3/4	22	46
31.23.0810	3/4	7/8	22	48.7
31.23.0812	3/4	1.1/16	27	53
31.23.1010	7/8	7/8	24	50.5
31.23.1012	7/8	1.1/16	27	55.8
31.23.1212	1.1/16	1.1/16	30	58
31.23.1216	1.1/16	1.5/16	36	60.4
31.23.1616	1.5/16	1.5/16	36	61.5

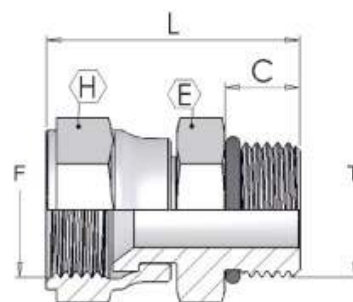
**ADAPTADOR M/F GIRATORIO UNF x JIC**
**31.25**

	MACHO	FÊMEA	DIMENSÕES				PRESSÃO TRABALHO
CÓDIGO	T	F	B	C	H	L	Bar
31.25.0404	7/16"	7/16"	15	9	15	34	350
31.25.0505	1/2"	1/2"	19	9	17	35.5	350
31.25.0606	9/16"	9/16"	17	10	17	38	350
31.25.0808	3/4"	3/4"	24	11	17	42.5	350
31.25.1010	7/8"	7/8"	27	12.5	17	48	350
31.25.1212	1.1/16"	1.1/16"	32	15	22	53.5	350
31.25.1616	1.5/16"	1.5/16"	38	15	27	57	280
31.25.2020	1.5/8"	1.5/8"	50	15	32	63.5	210

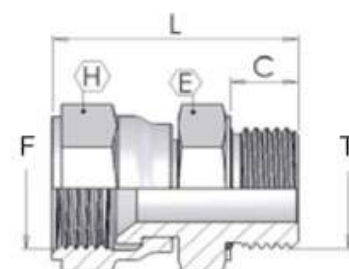
**RACORD F. GIRATORIO JIC x M. BSP**
**31.36**

	FÊMEA	FÊMEA	DIMENSÕES				PRESSÃO TRABALHO
CÓDIGO	F	T	C	E	H	L	BAR
31.36.0402	7/16"	1/8"	6.5	17	15	32	350
31.36.0404	7/16"	1/4"	10	19	15	36	350
31.36.0504	1/2"	1/4"	9.5	19	17	36.5	350
31.36.0604	9/16"	1/4"	9.5	19	19	37	350
31.36.0606	9/16"	3/8"	9.5	22	19	38	350
31.36.0804							
31.36.0806	3/4"	3/8"	9.5	22	24	41	350
31.36.0808	3/4"	1/2"	14	30	24	36	350
31.36.1006	7/8"	3/8"	11	22	27	43	350
31.36.1008	7/8"	1/2"	13	30	27	48	350
31.36.1012	7/8"	3/4"	15	32	27	51	350
31.36.1208	1.1/16"	1/2"	14	30	32	38	350
31.36.1212	1.1/16"	3/4"	13	36	32	51.5	350
31.36.1616	1.5/16"	1"	16	46	41	59.5	280
31.36.2020	1.5/8"	1.1/4"	16	50	50	64.5	210
31.36.2424							

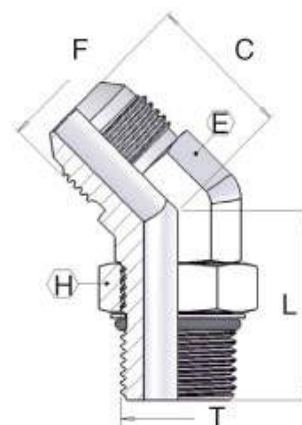
**JOELHO 45º JIC x UNF ORIENT.**
**31.26**

	MACHO	MACHO	DIMENSÕES				PRESSÃO TRABALHO
CÓDIGO	F	T	C	L	H	E	BAR
31.26.0404	7/16"	7/16"	19	26	14	12	350
31.26.0505	1/2"	1/2"	19.5	26.5	17	14	350
31.26.0606	9/16"	9/16"	21	29	19	14	350
31.26.0808	3/4"	3/4"	25	33	24	19	350
31.26.1010	7/8"	7/8"	28	38.5	27	22	350
31.26.1212	1.1/16"	1.1/16"	35	44	32	27	350
31.26.1216	1.1/16"	1.5/16"	36	47.2	41	33	350
31.26.1616	1.5/16"	1.5/16"	37	47	38	33	350
31.26.1620	1.5/16"	1.5/8"	39.1	48.5	50	41	170
31.26.2020	1.5/8"	1.5/8"	40	49	48	43	170

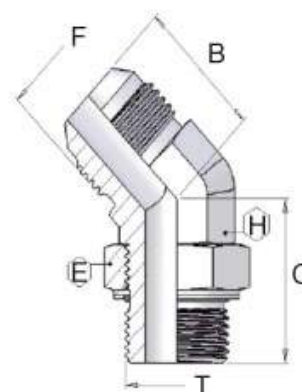

**JOELHO 45º JIC x BSP ORIENT.**
**31.40**

	MACHO	MACHO	DIMENSÕES			PRESSÃO TRABALHO
CÓDIGO	F	T	B	C	H	BAR
31.40.0402	7/16"	1/8"	18	26.5	12	350
31.40.0404	7/16"	1/4"	25	28	14	350
31.40.0504	1/2"	1/4"	21	29	19	350
31.40.0604	9/16"	1/4"	21	29	19	350
31.40.0606	9/16"	3/8"	25.5	35	19	350
31.40.0806	3/4"	3/8"	25	33	19	350
31.40.0808	3/4"	1/2"	25.5	38.5	22	350
31.40.1008	7/8"	1/2"	28	38.5	22	350
31.40.1012	7/8"	3/4"	34.5	40.5	27	350
31.40.1208	1.1/16"	1/2"	32.5	40.5	22	350
31.40.1212	1.1/16"	3/4"	32.5	44	27	250
31.40.1616	1.5/16"	1"	37	47	33	250

**JOELHO 45º JIC x MET ORIENT.**

**31.49**

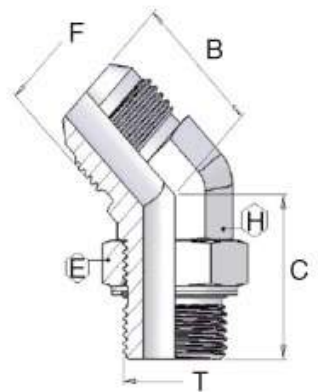

	MACHO	MACHO	DIMENSÕES			
CÓDIGO	T	F	B	C	H	E
31.49.0510	M 10 x 1.0	1/2"	20	26	14	14
31.49.0614	M 14 x 1.5	9/16"	22	28	14	19

# JOELHO 45º M/F GIRATÓRIO JIC

31.10

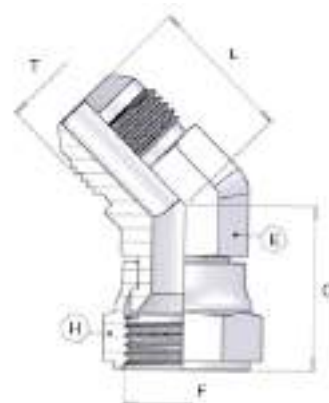

	FÊMEA	MACHO	DIMENSÕES				PRESSÃO TRABALHO
CÓDIGO	F	T	C	E	H	L	BAR
31.10.0404	7/16"	7/16"	24.5	12	15	18	350
31.10.0505	1/2"	1/2"	26.5	14	17	19.5	350
31.10.0606	9/16"	9/16"	28.5	14	19	21	350
31.10.0808	3/4"	3/4"	32	19	24	25	350
31.10.1010	7/8"	7/8"	37	22	27	28	350
31.10.1212	1.1/16"	1.1/16"	45.5	27	32	32.5	350
31.10.1616	1.5/16"	1.5/16"	45	33	41	37	280
31.10.2020	1.5/8"	1.5/8"	52	41	51	41	280

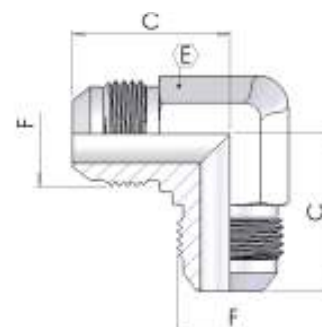
**JOELHO JIC**
**31.06**

	MACHO	DIMENSÕES		PRESSÃO TRABALHO
CÓDIGO	F	C	E	BAR
31.06.04	7/16"	22.5	12	350
31.06.05	1/2"	22.5	14	350
31.06.06	9/16"	27	14	350
31.06.08	3/4"	31.5	19	350
31.06.10	7/8"	36.5	22	350
31.06.12	1.1/16"	42	27	350
31.06.16	1.5/16"	46	33	280
31.06.20	1.5/8"	52	41	210
31.06.24	1.7/8"	59	48	140

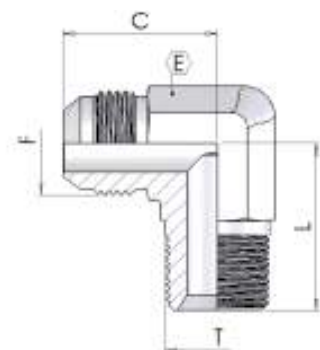
**JOELHO JIC x BSPT**
**31.44**

	MACHO	MACHO	DIMENSÕES			PRESSÃO TRABALHO
CÓDIGO	F	T	C	L	E	BAR
31.44.0402	7/16"	1/8"	22.5	19.5	12	350
31.44.0404	7/16"	1/4"	27	27.5	14	350
31.44.0502	1/2"	1/8"	24	19.5	12	350
31.44.0504	1/2"	1/4"	27	27.5	14	350
31.44.0604	9/16"	1/4"	27	27.5	14	350
31.44.0606	9/16"	3/8"	28.5	31	19	350
31.44.0608	9/16"	3/8"	31	37	22	350
31.44.0804	3/4"	1/4"	31.5	31	19	350
31.44.0806	3/4"	3/8"	31.5	31	19	350
31.44.0808	3/4"	1/2"	34	37	22	350
31.44.0812						
31.44.1006	7/8"	3/8"	36.5	32	22	350
31.44.1008	7/8"	1/2"	36.5	37	22	350
31.44.1212	1.1/16"	3/4"	42	40.5	27	350
31.44.1216						
31.44.1616	1.5/16"	1"	46	46	33	210

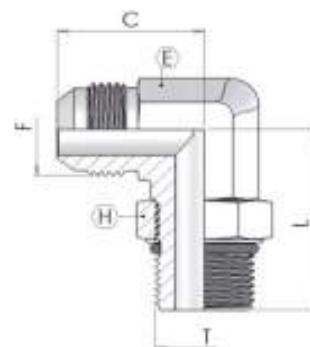
**JOELHO M/M JIC x UNF ORIENT.**
**31.28**

	MACHO	MACHO	DIMENSÕES				PRESSÃO TRABALHO
CÓDIGO	F	T	C	L	H	E	BAR
31.28.0404	7/16"	7/16"	22.5	26	12	14	350
31.28.0405	7/16"	1/2"	24	27.5	17	14	350
31.28.0406	7/16"	9/16"	27	31.5	19	14	350
31.28.0505	1/2"	1/2"	24	27.5	17	14	350
31.28.0506	1/2"	9/16"	26.6	31.8	17	14	350
31.28.0604	9/16"	7/16"	26	30	14	14	350
31.28.0606	9/16"	9/16"	27	31.5	19	14	350
31.28.0608	9/16"	3/4"	28.5	36	24	19	350
31.28.0806	3/4"	9/16"	32	32	19	19	350
31.28.0808	3/4"	3/4"	31.5	36.5	24	19	350
31.28.0810	3/4"	7/8"	34	43	27	19	350
31.28.0812	3/4"	1.1/16"	36.1	49.3	32	27	350
31.28.1008	7/8"	3/4"	36.5	39.5	24	22	350
31.28.1010	7/8"	7/8"	36.5	43	27	22	350
31.28.1210	1.1/16"	7/8"	42	45.5	32	27	350
31.28.1212	1.1/16"	1.1/16"	42	49	32	27	450
31.28.1216							
31.28.1612	1.5/16"	1.1/16"	46	52	32	33	280
31.28.1616	1.5/16"	1.5/16"	46	52	38	33	280
31.28.2016	1.5/16"	1.5/16"	46	52	38	33	280
31.28.2020	1.5/8"	1.5/8"	52	57	50	41	210
31.28.2424	1.7/8"	1.7/8"	59	61	55	48	140

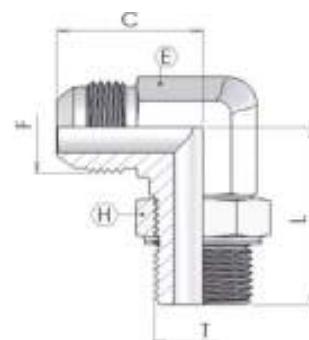
**JOELHO JIC x BSP ORIENT.**
**31.42**

	MACHO	MACHO	DIMENSÕES			PRESSÃO TRABALHO
CÓDIGO	F	T	C	H	E	BAR
31.42.0402	7/16"	1/8"	22.5	14	12	350
31.42.0404	7/16"	1/4"	27	19	14	350
31.42.0502	1/2"	1/8"	24	14	14	350
31.42.0504	1/2"	1/4"	24	14	14	350
31.42.0604	9/16"	1/4"	27	19	14	350
31.42.0606	9/16"	3/8"	28.5	22	19	350
31.42.0608	9/16"	1/2"	31	27	22	350
31.42.0804	3/4"	1/4"	31.5	19	19	350
31.42.0806	3/4"	3/8"	31.5	22	19	350
31.42.0808	3/4"	1/2"	34	27	22	350
31.42.1006	7/8"	3/8"	38	22	22	350
31.42.1008	7/8"	1/2"	36.5	27	22	350
31.42.1012	7/8"	3/4"	36.5	36	27	260
31.42.1208	1.1/16"	1/2"	42	27	27	350
31.42.1212	1.1/16"	3/4"	42	36	27	250
31.42.1216	1.1/16"	1"	44.5	41	33	250
31.42.1612	1.5/16"	3/4"	46	36	33	250
31.42.1616	1.5/16"	1"	46	41	33	250
31.42.1620	1.5/16"	1.1/4"	51	50	41	210
31.42.2016	1.5/8"	1"	52	41	41	210
31.42.2020	1.5/8"	1.1/4"	52	50	41	160
31.42.2424	1.7/8"	1.1/2"	59	55	48	140

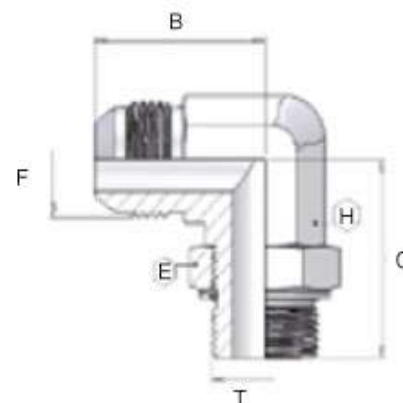
**JOELHO JIC x MET ORIENT.**
**31.50**

	MACHO	MACHO	DIMENSÕES				PRESSÃO TRABALHO
CÓDIGO	F	T	B	C	E	H	BAR
31.50.0410	7/16"	M10 x 1	25	29	14	12	350
31.50.0412	7/16"	M12 x 1.5	32	14	17		350
31.50.0510	1/2"	M10 x 1	27	14	14		350
31.50.0512	1/2"	M12 x 1.5	25	29	14	12	350
31.50.0614	9/16"	M14 x 1.5	27	31.5	19	14	350
31.50.0616	9/16"	M16 x 1.5	33.5	34.5	17	14	350
31.50.0816	3/4"	M16 x 1.5	31.5	36.5	22	19	350
31.50.0818	3/4"	M18 x 1.5	31.5	36.5	24	19	350
31.50.1018	7/8"	M18 x 1.5	36.5	39.5	24	22	350
31.50.1022	7/8"	M22 x 1.5	36.5	43	27	22	350
31.50.1222	1.1/16"	M22 x 1.5	42	45.5	27	27	350
31.50.1627	1.5/16"	M27 X 2	52	49	32	33	350

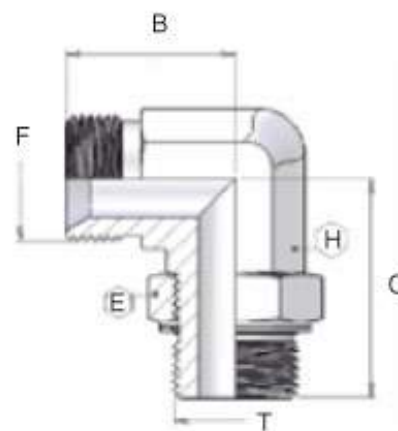

**JOELHO BSP x UNF ORIENT.**
**31.43**

	MACHO	MACHO	DIMENSÕES		
CÓDIGO	T	F	C	E	H
31.43.0204	7/16-20	1/8"	23	12	14
31.43.0205	1/2-20	1/8"	24	14	16
31.43.0406	9/16-18	1/4	27	14	19
31.43.0408	3/4-16	1/4	29	29	22
31.43.0606	9/16-18	3/8	27	14	19
31.43.0608	3/4-16	3/8	31.8	17	19
31.43.0610	7/8-14	3/8	34	22	27
31.43.0808	3/4-16	1/2	37	22	22
31.43.0810	7/8-14	1/2	37	22	27
31.43.0812	1.1/16-12	1/2	40	27	32
31.43.1210	7/8	3/4	42	27	27
31.43.1212	1.1/16-12	3/4	42	27	32
31.43.1216	1.5/16-12	3/4	45	33	41
31.43.1616	1.5/16-12	1	46	33	41

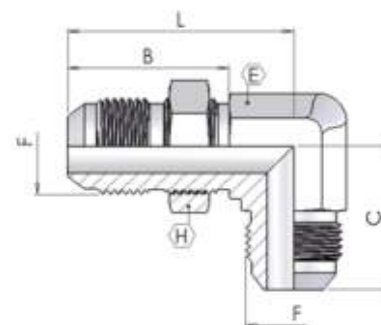
**JOELHO 90º TRESPASSE JIC**
**31.08**

	MACHO	DIMENSÕES					PRESSÃO TRABALHO
CÓDIGO	F	C	B	L	H	E	BAR
31.08.04	7/16"	24.5	28.5	40.5	17	14	350
31.08.05	1/2"	26	28.5	41	19	14	350
31.08.06	9/16"	27.5	30	46	22	14	350
31.08.08	3/4"	34.5	35	53.5	24	19	350
31.08.10	7/8"	39.5	38.5	60.5	30	22	350
31.08.12	1.1/16"	45	42.5	68	36	27	350
31.08.16	1.5/16"	49	42.5	71	41	33	280

# JOELHO M/F GIRATORIO JIC

31.12

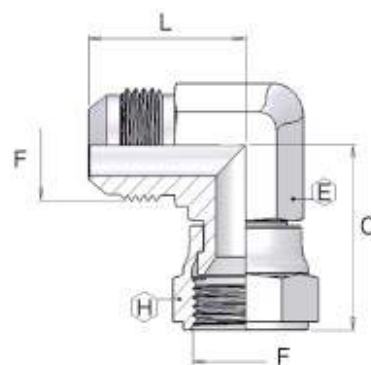

		FÊMEA	MACHO	DIMENSÕES				PRESSÃO TRABALHO
CÓDIGO	Desc.	F	T	C	E	H	L	BAR
31.12.0404	JOELHO M/F GIRATORIO 7/16 JIC	7/16"	7/16"	26	12	15	22.5	350
31.12.0505	JOELHO M/F GIRATORIO 1/2 JIC	1/2"	1/2"	28.5	14	17	24	350
31.12.0606	JOELHO M/F GIRATORIO 9/16 JIC	9/16"	9/16"	30	14	19	27	350
31.12.0808	JOELHO M/F GIRATORIO 3/4 JIC	3/4"	3/4"	35.5	19	24	31.5	350
31.12.1010	JOELHO M/F GIRATORIO 7/8 JIC	7/8"	7/8"	42	22	27	36.5	350
31.12.1212	JOELHO M/F GIRATORIO 1.1/16 JIC	1.1/16"	1.1/16"	44.5	27	32	42	500
31.12.1616	JOELHO M/F GIRATORIO 1.5/16 JIC	1.5/16"	1.5/16"	50	33	41	46	280
31.12.2020	JOELHO M/F GIRATORIO 1.5/8 JIC	1.5/8"	1.5/8"	59	41	50	52.5	210
31.12.2424	JOELHO M/F GIRATORIO 1.7/8 JIC	1.7/8"	1.7/8"	66	48	55	59	140

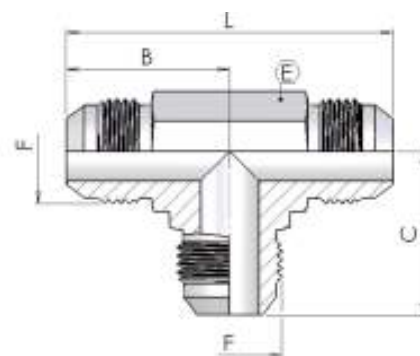
**T JIC**
**31.14**

	MACHO	DIMENSÕES				PRESSÃO TRABALHO
CÓDIGO	F	C	B	E	L	BAR
31.14.04	7/16"	22.5	22.5	12	45	350
31.14.05	1/2"	24	24	14	48	350
31.14.06	9/16"	27	27	14	54	350
31.14.08	3/4"	31.5	31.5	19	63	350
31.14.10	7/8"	36.5	36.5	22	73	350
31.14.12	1.1/16"	42	42	27	84	350
31.14.16	1.5/16"	46	46	33	92	280
31.14.20	1.5/8"	52	52	41	104	210
31.14.24	1.7/8"	59	59	48	118	140

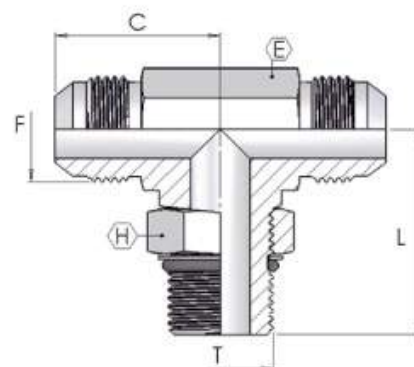
**T M/M JIC X UNF CENTRAL ORIENT.**
**31.31**

	MACHO	MACHO	DIMENSÕES				PRESSÃO TRABALHO
CÓDIGO	F	T	C	L	H	E	BAR
31.31.0404	7/16"	7/16"	22.5	26	14	12	350
31.31.0505	1/2"	1/2"	24	27.5	17	14	350
31.31.0606	9/16"	9/16"	27	31.5	19	14	350
31.31.0808	3/4"	3/4"	31.5	36.5	24	19	350
31.31.1010	7/8"	7/8"	36.5	43	27	22	350
31.31.1212	1.1/16"	1.1/16"	42	49	32	27	350
31.31.1616	1.1/16"	1.1/16"	46	52	38	33	280

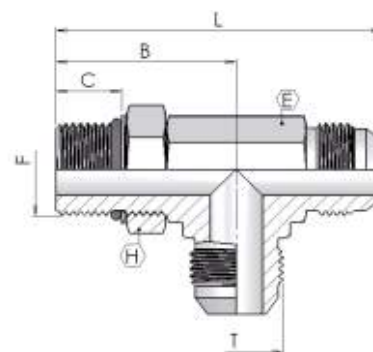
**T JIC M/M ORINT. LATERAL UNF**
**31.30**

	MACHO	MACHO	DIMENSÕES					PRESSÃO TRABALHO
CÓDIGO	F	T	C	B	E	H	L	BAR
31.30.0404	7/16"	7/162	10	26	12	14	48.5	350
31.30.0505	1/2"	1/2"	11	27.5	14	17	51.5	350
31.30.0606	9/16	9/16"	11	31.5	14	19	58.5	350
31.30.0808	3/4"	3/4"	13	36.5	19	24	68	350
31.30.1010	7/8"	7/8"	14	43	22	27	79.5	350
31.30.1212	1.1/16"	1.1/16"	17	49	27	32	91	350
31.30.1616	1.5/16"	1.5/16"	17	52	33	38	98	280

# T JIC x BSP CENTRAL

31.46

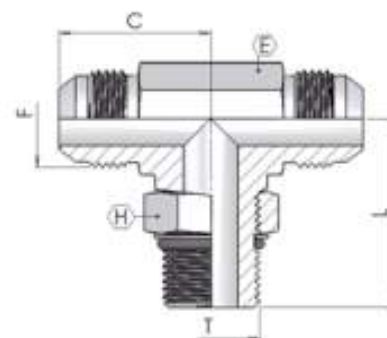

	MACHO	MACHO	DIMENSÕES				PRESSÃO TRABALHO
CÓDIGO	T	F	C	L	E	H	BAR
31.46.0402	1/8"	7/16"	22	26	12	14	350
31.46.0404	1/4"	7/16"	27	31.5	14	19	350
31.46.0504	1/4"	1/2"	27	31.5	14	19	350
31.46.0604	1/4"	9/16"	27	31.5	14	19	350
31.46.0606	3/8"	9/16"	27.5	36	19	22	350
31.46.0806	3/8"	3/4"	31.5	36.5	19	22	350
31.46.0808	3/4"	1/2"	35	43	22	27	350
31.46.1008	1/2"	7/8"	36.5	43	22	27	350
31.46.1212	3/4"	1.1/16"	42	49	27	36	350
31.46.1616	1"	1.5/16"	46	52	33	41	250

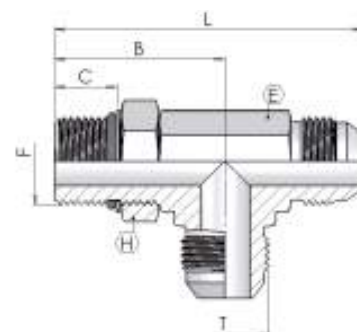
**T JIC x BSP LATERAL**
**31.47**

	MACHO	MACHO	DIMENSÕES					PRESSÃO TRABALHO
CÓDIGO	T	F	C	L	B	H	E	BAR
31.47.0402	7/16"	1/8"	6	48.5	26	14	12	350
31.47.0404	7/16"	1/4"	10	58.5	31.5	19	14	350
31.47.0504	1/2"	1/42	11	58.5	31.5	19	14	350
31.47.0604	9/16"	1/4"	11	58.5	31.5	19	14	350
31.47.0606	9/16"	3/8"	11	67	37	22	18.5	350
31.47.0806	3/4"	3/8"	11	68	36.5	22	19	350
31.47.1008	7/8"	1/2"	13	79.5	43	27	22	350
31.47.1212	1.1/16"	3/4"	13	91	49	36	27	250
31.47.1616	1.5/16"	1"	16	98	52	41	33	250

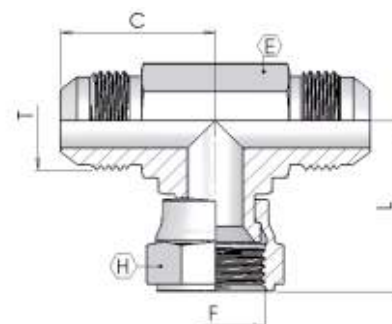

**T JIC M/M FEMEA CENTRAL**
**31.18**

	FÊMEA	MACHO	DIMENSÕES				PRESSÃO TRABALHO
CÓDIGO	F	T	C	E	H	L	BAR
31.18.0404	7/16"	7/16"	22.5	12	15	26	350
31.18.0505	1/2"	1/2"	24	14	17	28	350
31.18.0606	9/16"	9/16"	27	14	19	31	350
31.18.0808	3/4"	3/4"	31.5	19	24	35.5	350
31.18.1010	7/8"	7/8"	36.5	22	27	42	350
31.18.1212	1.1/16"	1.1/16"	42	27	32	45.5	350
31.18.1616	1.5/16"	1.5/16"	46	33	41	51.5	250
31.18.2020	1.5/8"	1.5/8"	52.5	41	50	59	210
31.18.2424	1.7/8"	1.7/8"	59	48	55	65.5	140

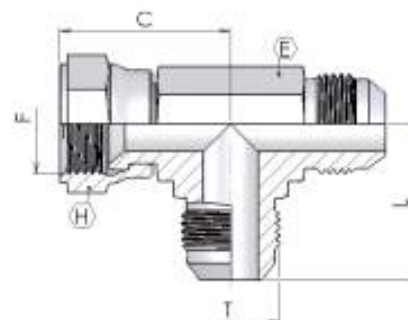
**T JIC M/M FEMEA LATERAL**
**31.16**

	FÊMEA	MACHO	DIMENSÕES				PRESSÃO TRABALHO
CÓDIGO	F	T	C	E	H	L	BAR
31.16.0404	7/16"	7/16"	26	12	15	22.5	350
31.16.0505	1/2"	1/2"	28	14	17	24	350
31.16.0606	9/16"	9/16"	31	14	19	27	350
31.16.0808	3/4"	3/4"	35.5	19	24	31.5	350
31.16.1010	7/8"	7/8"	42	22	27	36.5	350
31.16.1212	1.1/16"	1.1/16"	45.5	27	32	42	350
31.16.1616	1.5/16"	1.5/16"	51.5	33	41	46	250
31.16.2020	1.5/8"	1.5/8"	59	41	50	52.5	210
31.16.2424	1.7/8"	1.7/8"	65.5	48	55	59	140

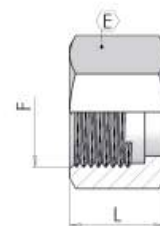
**PORCA JIC**
**31.20**

	Ø TUBO	DIMENSÕES			PRESSÃO TRABALHO
CÓDIGO	mm	F	L	E	BAR
31.20.0604	06	7/16"-20	15.5	14	250
31.20.0805	08	1/2"-20	17	16	250
31.20.1006	10	9/16" -18	18.5	19	250
31.20.1208	12	3/4" -16	21.5	22	250
31.20.1610	16	7/8" -14	24.5	27	200
31.20.2012	20	1.1/16"-12	26	32	200
31.20.2516	25	1.5/16"-12	28.5	38	160

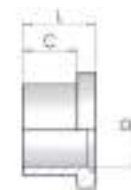
**BICONE JIC**
**31.22**

	Ø TUBO	DIMENSÕES		PRESSÃO TRABALHO
CÓDIGO	mm	L	C	BAR
31.22.06	06	10.5		250
31.22.08	08	11.5		250
31.22.10	10	12.5	8	250
31.22.12	12	14.5	9	250
31.22.14	14	16.5	11	200
31.22.16	16	16.5	11	200
31.22.20	20	17	11	160
31.22.25	25	19.5	13	160

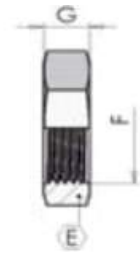
**PORCA JIC**
**31.33**

CÓDIGO	DIMENSÕES		
	F	E	G
31.33.04	7/16" - 20	17	7
31.33.05	1/2"-20	19	7
31.33.06	9/16"-18	22	7
31.33.08	3/4"-16	24	8
31.33.10	7/8"-14	30	10
31.33.12	1.1/16"-12	36	11
31.33.16	1.5/16"-12	41	11
31.33.20	1.5/8"-12	50	11
31.33.24	1.7/8"-12	55	11

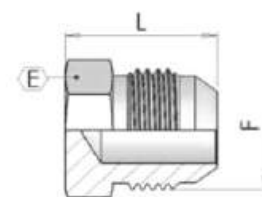
**TAMPAO MACHO JIC**
**31.80**

	MACHO	DIMENSÕES		PRESSÃO TRABALHO
CÓDIGO	F	E	L	BAR
31.80.04	7/16"-20	14	20.5	350
31.80.05	1/2"-20	14	20.5	350
31.80.06	9/16"-18	17	21.5	350
31.80.08	3/4"-16	19	24.5	350
31.80.10	7/8"-14	24	28	350
31.80.12	1.1/16"-12	27	32.5	350
31.80.16	1.5/16"-12	36	34	280
31.80.20	1.5/8"-12	46	37	210
31.80.24	1.7/8"	50	42	140

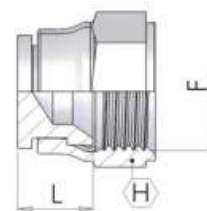
**TAMPAO FEMEA JIC**
**31.82**

	MACHO	DIMENSÕES		PRESSÃO TRABALHO
CÓDIGO	F	H	L	BAR
31.82.04	7/16"-20	14	18	350
31.82.05	1/2"-20	16	20	350
31.82.06	9/16"-18	19	22	350
31.82.08	3/4"-16	22	24	350
31.82.10	7/8"-14	27	27	350
31.82.12	1.1/16"-12	32	30	350
31.82.16	1.5/16"-12	38	31.5	280
31.82.20	1.5/8"-12	50	33	210
31.82.24	1.7/8"-12	60	39	210

# ORFS

## CASQUILO M/M ORFS BSP

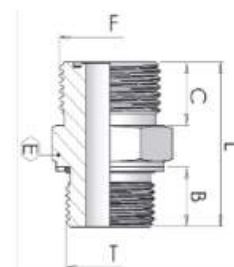
**32.22**

	MACHO	MACHO	DIMENSÕES				PRESSÃO TRABALHO
CÓDIGO	F	T	B	C	L	E	BAR
32.22.0602	9/16"	1/8"	8	10	25.5	17	630
32.22.0604	9/16"	1/4"	12	10	30.5	19	630
32.22.0606	9/16"	3/8"	12	10	31.5	22	630
32.22.0904	11/16"	1/4"	12	11	32	19	630
32.22.0906	11/16"	3/8"	12	11	33	22	630
32.22.0908	11/16"	1/2"	14	11	37	27	630
32.22.1104	13/16"	1/4"	12	13	34.5	22	630
32.22.1106	13/16"	3/8"	12	13	34.5	22	630
32.22.1108	13/16"	1/2"	14	13	38.5	27	630
32.22.1112	13/16"	3/4"	16	13	42	32	400
32.22.1306	1"	3/8"	12	16	43	27	400
32.22.1308	1"	1/2"	14	16	41	27	400
32.22.1312	1"	3/4"	16	16	44.5	32	400
32.22.1408	1.3/16"	1/2"	14	17	48.5	32	400
32.22.1412	1.3/16"	3/4"	16	17	46	32	400
32.22.1416	1.3/16"	1"	18	17	49	41	400
32.22.1512	1.7/16"	3/4"	16	18	52	41	400
32.22.1516	1.7/16"	1"	18	18	50	41	400
32.22.1520	1.7/162	1.1/4"	20	18	54	50	400
32.22.2120	1.11/16"	1.1/4"	20	18	54	50	250

## CASQUILHO M/M ORFS

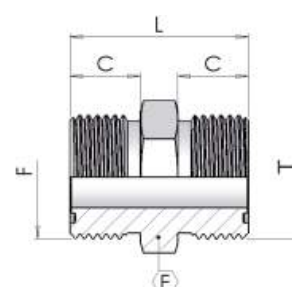
**32.02**



	MACHO	MACHO	DIMENSÕES			PRESSÃO TRABALHO
CÓDIGO	F	T	C	E	L	BAR
32.02.0606	9/16	9/16	10	17	27.5	630
32.02.0609	9/16	11/16	10/11	19	29.5	630
32.02.0909	11/16	11/16	11	19	31	630
32.02.0911	11/16	13/16	11/13	22	34	630
32.02.1111	13/16	13/16	13	22	35.5	630
32.02.1113	13/16	1	13/16	27	40	400
32.02.1313	1"	1"	16	27	42.5	400
32.02.1314	1"	1.3/16	16/17	32	45.5	400
32.02.1414	1.3/16	1.3/16	17	32	47	400
32.02.1415	1.3/16	1.7/16	17/18	41	49.5	400
32.02.1515	1.7/16	1.7/16	18	41	49.5	400
32.02.2121	1.11/16	1.11/16	18	46	51.5	250

## CASQUILHO TRESPASSE ORFS

32.04

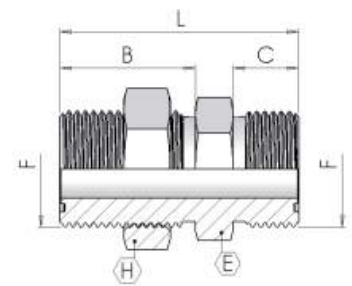

	MACHO	DIMENSÕES					PRESSÃO TRABALHO
CÓDIGO	F	C	L	B	E	H	BAR
32.04.0606	9/16	10	48	31.5	22	22	630
32.04.0909	11/16"	11	53	34	27	27	630
32.04.1111	13/16"	13	58.5	36.5	30	30	630
32.04.1313	1"	16	66.5	40.5	36	36	400
32.04.1414	1.3/16"	17	70	42	41	41	400
32.04.1515	1.7/16"	18	70	42	46	46	400
32.04.2121	1.11/16"	18	70	42	50	50	250

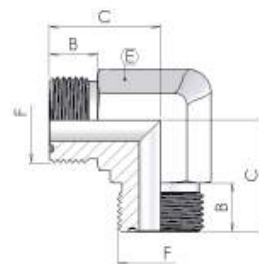
**JOELHO M/M ORFS**
**32.06**

	MACHO	DIMENSÕES			PRESSÃO TRABALHO
CÓDIGO	F	C	B	E	BAR
32.06.0606	9/16"	12.5	10	14	630
32.06.0909	11/16"	25	11	19	630
32.06.1111	13/16"	28	13	19	630
32.06.1313	1"	33.5	16	27	400
32.06.1414	1.3/16"	37.5	17	30	400
32.06.1515	1.7/16"	37.5	18	30	400
32.06.2121	1.11/16"	44.5	18	41	250

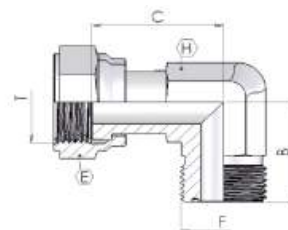
**JOELHO M/F ORFS**
**32.08**

	MACHO	FÊMEA	DIMENSÕES				
CÓDIGO	F	T	B	C	H	E	BAR
32.08.0606	9/16"	9/16"	22	27	14	19	400
32.08.0909	11/16"	11/16"	25	29	19	22	400
32.08.1111	13/16"	13/16"	28	38	19	24	400
32.08.1313	1"	1"	34	41	27	30	400
32.08.1414	1.3/16"	1.3/16"	38	47	30	36	400
32.08.1515	1.7/16"	1.7/16"	42	54	37	41	400
32.08.2121	1.11/16"	1.11/16"	45	58	41	50	250

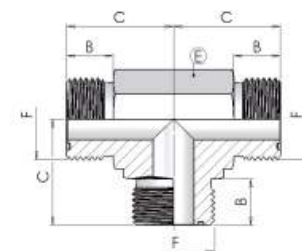
**T M/M ORFS**
**32.10**

	MACHO	DIMENSÕES			PRESSÃO TRABALHO
CÓDIGO	F	B	C	E	BAR
32.10.0606	9/16"	10	21.5	14	630
32.10.0909	11/16"	11	25	19	630
32.10.1111	13/16"	13	28	19	630
32.10.1313	1"	16	33.5	27	400
32.10.1414	1.3/16"	17	37.5	30	400
32.10.1515	1.7/16"	17	41.5	36	400
32.10.2121	1.11/16"	18	44.5	41	250

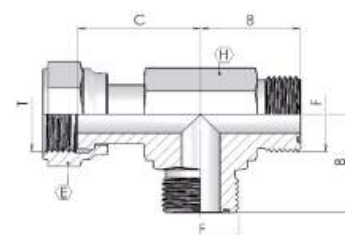
**T ORFS M/M FEMEA LATERAL**
**32.12**

	FÊMEA	MACHO	DIMENSÕES			
CÓDIGO	T	F	B	C	H	BAR
32.12.0606	9/16"	9/16"	22	27	14	400
32.12.0909	11/16"	11/16"	25	29	19	400
32.12.1111	13/16"	13/16"	28	38	19	400
32.12.1313	1"	1"	34	41	27	400
32.12.1414	1.3/16"	1.3/16"	38	47	30	400
32.12.1515	1.7/16"	1.7/16"	42	54	37	400
32.12.2121	1.11/16"	1.11/16"	45	58	41	250

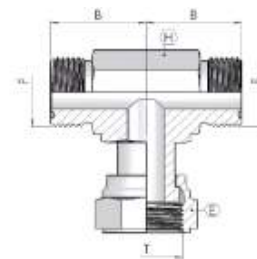
**T ORFS M/M FEMEA CENTRAL**
**32.14**

	MACHO	FÊMEA	DIMENSÕES				PRESSÃO TRABALHO
CÓDIGO	F	T	B	C	E	H	PRESSÃO BAR
32.14.0606	9/16"	9/16"	22	27	19	14	400
32.14.0909	11/16"	11/16"	25	29	22	19	400
32.14.1111	13/16"	13/16"	28	38	24	19	400
32.14.1313	1"	1"	34	41	30	27	400
32.14.1414	1.3/16"	1.3/16"	38	47	36	30	400
32.14.1515	1.7/16"	1.7/16"	42	54	41	37	400
32.14.2121	1.11/16"	1.11/16"	45	58	50	41	250

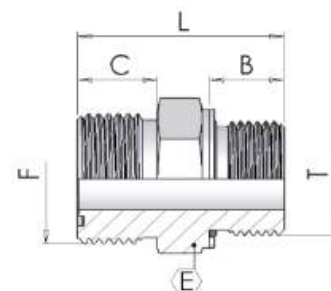
**CASQUILHO M/M ORFS x UNF**
**32.16**

	MACHO	MACHO	DIMENSÕES				PRESSÃO TRABALHO
CÓDIGO	T	F	C	L	B	E	BAR
32.16.0604	9/16"	7/16"	10	28.7	11	17	630
32.16.0605							
32.16.0606	9/16"	9/16"	10	30.5	12	19	630
32.16.0906	11/16"	9/16"	11	32	12	19	630
32.16.0908	11/16"	3/4"	11	35	14	22	630
32.16.1106	13/16"	9/16"	13	37.5	12	22	630
32.16.1108	13/16"	3/4"	13	36.5	14	22	630
32.16.1110	13/16"	7/8"	13	40.4	16	27	630
32.16.1308	1"	3/4"	16	45	14	27	400
32.16.1310	1"	7/8"	16	43	16	27	400
32.16.1312	1"	1.1/16"	16	47	19	32	400
32.16.1412	1.3/16"	1.1/16"	17	44.4	19	32	400
32.16.1416	1.3/16"	1.5/16"	17	45.5	19	38	400
32.16.1512	1.7/16"	1.1/16"	18	56	19	38	400
32.16.1516	1.7/16"	1.5/16"	18	50	19	38	400
32.16.1520	1.7/16"	1.5/8"	18	52.5	19	46	250

**JOELHO 45º M/M ORFS x UNF**
**32.18**



	MACHO	MACHO	DIMENSÕES					PRESSÃO TRABALHO
CÓDIGO	F	T	B	C	L	H	E	BAR
32.18.0604	9/16"	7/16"	10	16	30	14	19	400
32.18.0606	9/16"	9/16"	10	17.3	33	19	19	400

	MACHO	MACHO	DIMENSÕES					PRESSÃO TRABALHO
CÓDIGO	F	T	B	C	L	H	E	BAR
32.18.0904	11/16"	7/16"	12	19	31	14	19	400
32.18.0906	11/16"	9/16"	12	19	33	18	19	400
32.18.0908	11/16"	3/4"	12	19	36.3	24	19	400
32.18.1106	13/16"	9/16"	12	20.5		19	19	400
32.18.1108	13/16"	3/4"	13	20.5	36.3	24	19	400
32.18.1110	13/16"	7/8"	13	27	44.7	27	27	400
32.18.1308	1"	3/4"	14	24.4	40.4	24	27	400
32.18.1310	1"	7/8"	14	23.5	44.7	27	27	400
32.18.1312	1"	1.1/16"	14	24.9	50	32	30	400
32.18.1410	1.3/16"	7/8"	17	24.9	50	32	30	400
32.18.1412	1.3/16"	1.1/16"	17	26	50	32	36	400
32.18.1416	1.3/16"	1.5/16"	17	29.5	52.5	38	36	380
32.18.1512	1.7/16"	1.1/16"	17	30	51.6	32	36	400
32.18.1516	1.7/16"	1.5/16"	17	30	52.5	38	36	380
32.18.2120	1.11/16"	1.5/8"	17	32	53.5	50	41	250

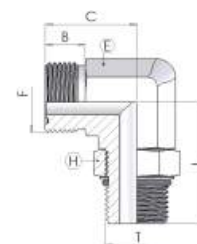

**JOELHO 90º ORFS x UNF ORIENTAVEL**
**32.20**

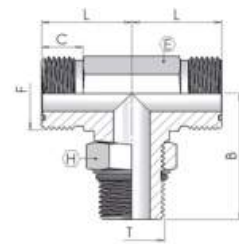
	MACHO	MACHO	DIMENSÕES					PRESSÃO TRABALHO
CÓDIGO	F	T	C	L	B	H	E	BAR
32.20.0604	9/16"	7/16"	21.5	33	10	14	14	400
32.20.0606	9/16"	9/16"	23.5	36.8	10	19	19	400
32.20.0904	11/16"	7/16"	25	34.8	11	14	19	400
32.20.0906	11/16"	9/16"	25	36.8	11	19	19	400
32.20.0908	11/16"	3/4"	26.5	40.6	11	24	19	400
32.20.1106	13/16"	9/16"	28	38.5	13	19	10	400
32.20.1108	13/16"	3/4"	28	40.6	13	24	19	400
32.20.1110	13/16"	7/8"	38.8	50	13	27	27	400
32.20.1308	1"	3/4"	33.5	45.7	16	24	27	400
32.20.1310	1"	7/8"	33.5	50	16	27	27	400
32.20.1312	1"	1.1/16"	35.8	55.1	16	32	30	400
32.20.1410	1.3/16"	7/8"	37.5	51	17	27	30	400
32.20.1412	1.3/16"	1.1/16"	38.5	55.1	17	32	30	400
32.20.1416	1.3/16"	1.5/16"	41.2	59.7	17	38	36	400
32.20.1512	1.7/16"	1.1/16"	41.5	59		32	36	400
32.20.1516	1.7/16"	1.5/16"	41.5	59.7	18	38	36	400
32.20.2120	1.11/16"	1.5/8"	44.5	62.3	18	50	41	250

**T M/M ORFS x UNF CENTRAL**
**32.21**

	MACHO	MACHO	DIMENSÕES					PRESSÃO TRABALHO
CÓDIGO	F	T	B	C	E	H	L	BAR
32.21.0604	9/16"	7/16"	33	10	14	14	21.5	400
32.21.0906	11/16"	9/16"	36.8	11	19	19	25	400
32.21.1108	13/16"	3/4"	40.6	13	19	24	28	400
32.21.1310	1"	7/8"	50	16	27	27	33.5	400
32.21.1412	1.3/16"	1.1/16"	55	17	30	32	37.5	400
32.21.1516	1.7/16"	1.5/16"	59.7	18	37	38	41.5	400
32.21.2120	1.11/16"	1.5/8"	62.3	18	41	50	44.5	250

**JOELHO 45º M/M ORFS x BSP**
**32.24**

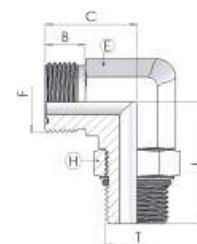

	MACHO	MACHO	DIMENSÕES				PRESSÃO TRABALHO
CÓDIGO	F	T	B	C	E	H	BAR
32.24.0604	9/16"	1/4"	16	30	19	19	320
32.24.0606	9/16"	3/8"	25	34	19	24	320
32.24.0904	11/16"	1/4"	18	32	19	19	320
32.24.0906	11/16"	3/8"	18	33.5	19	23	320
32.24.0908	11/16"	1/2"	19.5	43.5	27	27	320
32.24.1106	13/16"	3/8"	20.5	33.5	19	22	320
32.24.1108	13/16"	1/2"	31	42	27	27	320
32.24.1308	1"	1/2"	23.5	43.5	27	27	320
32.24.1312	1"	3/4"	24.5	46.5	30	36	320
32.24.1412	1.3/16"	3/4"	26	46.5	30	36	250
32.24.1416	1.3/16"	1"	41	44.5	36	41	250
32.24.1512	1.7/16"	3/4"	42	47	37	36	250
32.24.1516	1.7/16"	1"	30	51	36	41	250

**JOELHO 90º ORFS x BSP ORIENTAVEL**
**32.26**

	MACHO	MACHO	DIMENSÕES				PRESSÃO TRABALHO
CÓDIGO	F	T	B	C	E	H	BAR
32.26.0602	9/16"	1/8"	21.5	30.2	14	14	320
32.26.0604	9/16"	1/4"	23.5	33.5	19	19	320
32.26.0606	9/16"	3/8"	23.5	38	22	19	320
32.26.0904	11/16"	1/4"	25	35.5	19	19	320
32.26.0906	11/16"	3/8"	26.5	38	22	19	320
32.26.0908	11/16"	1/2"	29.2	48.6	27	27	320
32.26.1104	13/16"	1/4"	28	35.5	19	19	320
32.26.1106	13/16"	3/8"	28	38	22	19	320
32.26.1108	13/16"	1/2"	30.8	48.6	27	27	320
32.26.1306	1"	3/8"	33.5	40.7	22	27	320
32.26.1308	1"	1/2"	33.5	48.6	27	27	320
32.26.1312	1"	3/4"	35.8	51.4	36	30	320
32.26.1408	1.3/16"	1/2"	37.5	49.5	27	30	320
32.26.1412	1.3/16"	3/4"	37.5	51.4	36	30	250
32.26.1512	1.7/16"	3/4"	44.5	55.9	36	36	250
32.26.1516	1.7/16"	1"	41.5	58.4	41	36	250
32.26.2120	1.11/16"	1.1/4"	44.5	60.9	50	41	180

# ADAPTADOR M/F BSP x ORFS

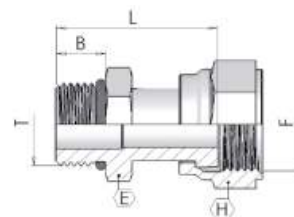
32.28



	FÊMEA	MACHO	DIMENSÕES				PRESSÃO TRABALHO
CÓDIGO	F	T	B	L	E	H	BAR
32.28.0406	9/16"	1/4"	11.8	38	19	19	400
32.28.0409	11/16"	1/4"	20.2	41	19	22	400
32.28.0609	11/16"	3/8"	11.8	40	22	22	400
32.28.0611	13/16"	3/8"	12.2	48	22	24	400
32.28.0811	13/16"	1/2"	14	49.5	27	24	400
32.28.0813	1"	1/2"	14	52	27	30	400
32.28.1214	1.3/16"	3/4"	12.4	57.4	32	36	400
32.28.1614	1.3/16	1				36	400
32.28.1615	1.7/16"	1"	18	67	41	46	400
32.28.2021	1.11/16"	1.1/4"	20	69	50	50	250

# CASQUILHO ORFS x MÉTRICO

32.70

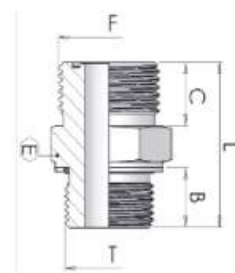

	MACHO	DIMENSÕES		PRESSÃO TRABALHO
CÓDIGO	F	E	T	BAR
32.70.0612	9/16"	17	M 12 x 1.5	630
32.70.0614	9/16		M 14 x 1.5	
32.70.0914	11/16"	19	M 14 x 1.5	630
32.70.0916	11/16"	22	M 16 x 1.5	630
32.70.1118	13/16"	24	M 18 x 1.5	630
32.70.1322	1"	27	M 22 x 1.5	400
32.70.1427	1.3/16	36	M27x2	400
32.70.1533	1.7/16"	41	M 33 X 2.0	400

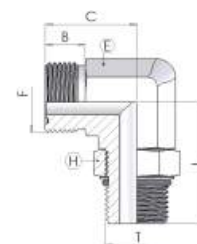
**JOELHO 90º ORFS x MÉTRICO ORIENT.**
**32.72**

	MACHO	MACHO	DIMENSÕES				PRESSÃO TRABALHO
CÓDIGO	F	T	B	C	H	E	BAR
32.72.0612	9/16"	M 12 x 1.5	21.5	33	14	17	400
32.72.0914	11/16"	M 14 x 1.5	25	35.5	19	19	400
32.72.0916	11/16"	M 16 x 1.5	25	37.5	19	22	400
32.72.1118	13/16"	M 18 x 1.5	28	41	19	24	400
32.72.1322	1"	M 22 x 1.5	33.5	49	27	27	400
32.72.1427	1.3/16"	M 27 x 2	38	55	30	36	400
32.72.1533	1.7/16"	M 33 x 2	41.5	59.5	36	41	400

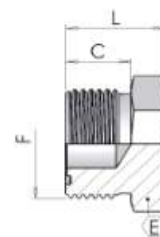
**TAMPAO MACHO ORFS**
**32.30**

	MACHO	DIMENSÕES		
CÓDIGO	F	C	L	E
32.30.06	9/16"	10	16.5	17
32.30.09	11/16"	11	19	19
32.30.11	13/16"	13	22	22
32.30.13	1"	16	26	27
32.30.14	1.3/16"	17	27.5	32
32.30.15	1.7/16"	18	28	41
32.30.21	1.11/16"	18	28	46

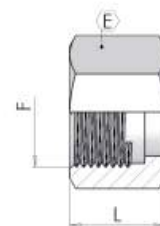

**TAMPAO FEMEA ORFS**
**32.32**

	MACHO	DIMENSÕES	
CÓDIGO	F	E	L
32.32.06	9/16"	17	16.5
32.32.09	11/16"	22.0	18.0
32.32.11	13/16"	24.0	22.0
32.32.13	1"	30.0	24.5
32.32.14	1.3/16"	36.0	27.0
32.32.15	1.7/16"	41.0	28.5
32.32.21	1.11/16"	50.0	28.5

# DIN

## BICONE

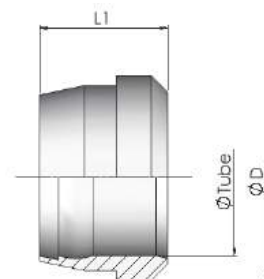
**25.01**

	Ø TUBO	DIMENSÕES		PRESSÃO
CÓDIGO	in	L1	D	
25.01.01	4 LL	6	5.5	100
25.01.02	6 LL	7	8.5	100
25.01.03	8 LL	7.5	10.5	100
25.01.04	10 LL	7	10	100
25.01.05	12 LL	7.5	12	100
25.01.06	6 L/S	9	10	500
25.01.07	8 L/S	9.5	12	500
25.01.08	10 L/S	10	14	500
25.01.09	12 L/S	10	16	400
25.01.10	15 L	10	18	400
25.01.11	18 L	10.5	19	400
25.01.12	22 L	10.5	26	250
25.01.13	28 L	10.5	32	250
25.01.14	35 L	13.5	41	250
25.01.15	42 L	13.5	48	250
25.01.20	14 S	10	18	630
25.01.21	16 S	10.5	21	630
25.01.22	20 S	12.5	26	420
25.01.23	25 S	12	31	420
25.01.24	30 S	13	36	420
25.01.25	38 S	13.5	45	420
25.01.30	5 LL	7.5	7	100
25.01.40	13.25 1/4"	10	13.7	640
25.01.41	16.75 3/8"	10.1	17	400
25.01.42	21.25 1/2"	10.2	21.6	400

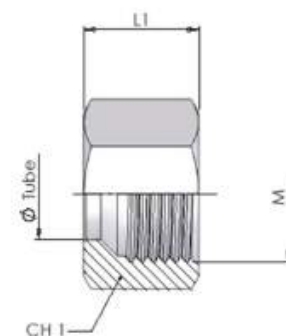
**PORCA**
**25.02**

	Ø TUBO	DIMENSÕES			PRESSÃO TRABALHO
CÓDIGO	in	M	CH1	L1	BAR
25.02.01	4 LL	M 8 x 1.0	10	11.0	100
25.02.02	6 LL	M 10 x 1.0	12	11.5	100
25.02.03	8 LL	M 12 x 1.0	14	12.0	100
25.02.04	10 LL	M 14 x 1.0	17	13.5	100
25.02.05	12 LL	M 16 x 1.0	19	14.0	100
25.02.06	6 L	M 12 x 1.5	14	14.5	500
25.02.07	8 L	M 14 x 1.5	17	14.5	500
25.02.08	10 L	M 16 x 1.5	19	15.5	500
25.02.09	12 L	M 18 x 1.5	22	15.5	400
25.02.10	15 L	M 22 x 1.5	27	17.0	400
25.02.11	18 L	M 26 x 1.5	32	18.0	400
25.02.12	22 L	M 30 x 2.0	36	20.0	250
25.02.13	28 L	M 36 x 2.0	41	21.0	250
25.02.14	35 L	M 45 x 2.0	50	24.0	250
25.02.15	42 L	M 52 x 2.0	60	24.0	250
25.02.16	6 S	M 14 x 1.5	17	16.5	800
25.02.17	8 S	M 16 x 1.5	19	16.5	800
25.02.18	10 S	M 18 x 1.5	22	17.5	800
25.02.19	12 S	M 20 x 1.5	24	17.5	630
25.02.20	14 S	M 22 x 1.5	27	20.5	630
25.02.21	16 S	M 24 x 1.5	30	20.5	400
25.02.22	20 S	M 30 x 2.0	36	24.0	420
25.02.23	25 S	M 36 x 2.0	46	27.0	420
25.02.24	30 S	M 42 x 2.0	50	29.0	420
25.02.25	38 S	M 52 x 2.0	60	32.5	420
25.02.30	5 LL	M 10 x 1.0	12	12	100

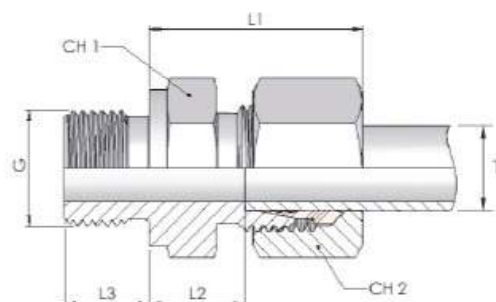

	Ø TUBO	ROSCA	DIMENSÕES			PRESSÃO TRABALHO
CÓDIGO	T (mm)	G	CH1	CH2	L1	
25.03.0602	6 L	1/8"	14	14	23.5	315
25.03.0604	6 L	1/4"	19	14	23.5	315
25.03.0606	6 L	3/8"	22	14	26.5	315
25.03.0702	8 L	1/8"	14	17	24.5	315
25.03.0704	8 L	1/4"	19	17	25	315
25.03.0706	8 L	3/8"	22	17	26.5	315
25.03.0708	8 L	1/2"	22	17	27	315
25.03.0802	10 L	1/8"	27	19	28	315
25.03.0804	10 L	1/4"	19	19	26	315
25.03.0806	10 L	3/8"	19	19	28.5	315
25.03.0808	10 L	1/2"	28	13.0	28	315
25.03.0904	12 L	1/4"	19	22	30	315
25.03.0906	12 L	3/8"	22	22	27.5	315
25.03.0908	12 L	1/2"	27	22	28	315
25.03.1006	15 L	3/8"	24	27	28.5	315
25.03.1008	15 L	1/2"	27	27	29	315
25.03.1012	15 L	3/4"	32	27	30	315
25.03.1108	18 L	1/2"	27	32	31	250
25.03.1112	18 L	3/4"	31	14.5	31	250
25.03.1208	22 L	1/2"	32	36	33	160
25.03.1212	22 L	3/4"	32	36	33	160
25.03.1216	22 L	1"	41	36	34	160
25.03.1312	28 L	3/4"	41	36	34	160
25.03.1316	28 L	1"	41	41	34	160
25.03.1416	35 L	1"	46	50	39	160
25.03.1420	35 L	1.1/4"	50	50	39.5	160
25.03.1520	42 L	1.1/4"	55	60	42	160
25.03.1524	42 L	1.1/2"	55	59	47	160
25.03.1604	6 S	1/4"	19	17	28	400
25.03.1704	8 S	1/4"	17	19	28	640
25.03.1706	8 S	3/8"	22	19	30.5	400
25.03.1804	10 S	1/4"	19	22	31	400
25.03.1806	10 S	3/8"	22	22	31.5	400
25.03.1808	10 S	1/2"	27	22	34	400
25.03.1904	12 S	1/4"	22	24	33	400
25.03.1906	12 S	3/8"	22	24	33.5	400

	Ø TUBO	ROSCA	DIMENSÕES			PRESSÃO TRABALHO
CÓDIGO	T (mm)	G	CH1	CH2	L1	
25.03.1908	12 S	1/2"	27	24	34	400
25.03.2006	14 S	3/8"	24	27	36.5	400
25.03.2008	14 S	1/2"	22	27	37	400
25.03.2106	16 S	3/8"	24	30	36.5	400
25.03.2108	16 S	1/2"	24	30	36.5	400
25.03.2112	16 S	3/4"	32	30	39	400
25.03.2208	20 S	1/2"	32	36	42	400
25.03.2212	20 S	3/4"	32	36	42	400
25.03.2216	20 S	1"	41	36	44	250
25.03.2312	25 S	3/4"	41	46	47	400
25.03.2316	25 S	1"	41	46	47	250
25.03.2416	30 S	1"	46	50	50	160
25.03.2420	30 S	1.1/4"	50	50	50	160
25.03.2520	38 S	1.1/4"	55	60	57	160
25.03.2524	38 S	1.1/2"	55	60	57	160

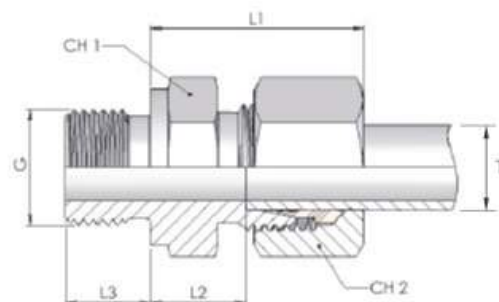

	Ø TUBO	ROSCA	DIMENSÕES		PRESSÃO TRABALHO
CÓDIGO	T (mm)	G	CH1	CH2	
25.04.0108	4 LL	M 8 x 1.0	10	10	100
25.04.0206	6 LL	M 6 x 1.0	11	12	100
25.04.0208	6 LL	M 8 x 1.0	11	12	100
25.04.0210	6 LL	M 10 x 1.0	11	12	100
25.04.0310	8 LL	M 10 x 1.0	12	14	100
25.04.0610	6 L	M 10 x 1.0	14	14	315
25.04.0612	6 L	M 12 x 1.5	17	14	315
25.04.0712	8 L	M 12 x 1.5	17	17	315
25.04.0714	8 L	M 14 x 1.5	19	17	315
25.04.0716	8 L	M 16 x 1.5	22	17	315
25.04.0718	8 L	M 18 x 1.5	24	17	315
25.04.0722	8 L	M 22 x 1.5	27	17	315
25.04.0812	10 L	M 12 x 1.5	17	19	315
25.04.0814	10 L	M 14 x 1.5	19	22	315
25.04.0816	10 L	M 16 x 1.5	22	18.5	315
25.04.0818	10 L	M 18 x 1.5	24	19	315
25.04.0822	10 L	M 22 x 1.5	27	19	315
25.04.0914	12 L	M 14 x 1.5	19	22	315
25.04.0916	12 L	M 16 x 1.5	22	22	315
25.04.0918	12 L	M 18 x 1.5	24	22	315
25.04.0922	12 L	M 22 x 1.5	27	22	315
25.04.1016	15 L	M 22 x 1.5	27	27	315
25.04.1018	15 L	M 18 x 1.5	24	27	315
25.04.1022	15 L	M 22 x 1.5	27	27	315
25.04.1122	18 L	M 22 x 1.5	27	32	315
25.04.1222	22 L	M 22 x 1.5	32	36	160
25.04.1226	22 L	M 26 x 1.5	32	36	160
25.04.1333	28 L	M 32 x 2	41	41	160
25.04.1442	35 L	M 42 x 2.0	50	50	160
25.04.1548	42 L	M 48 x 2.0	55	60	160
25.04.1612	6 S	M 12 x 1.5	17	17	400
25.04.1714	8 S	M 14 x 1.5	19	19	640
25.04.1814	10 S	M 14 x 1.5	19	19	640
25.04.1816	10 S	M 16 x 1.5	22	22	400
25.04.1918	12 S	M 18 x 1.5	24	24	400
25.04.2020	14 S	M 20 x 1.5	27	27	400

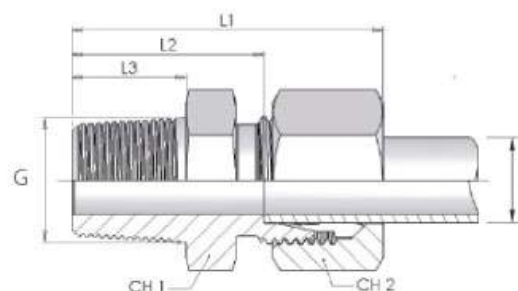

	Ø TUBO	ROSCA	DIMENSÕES		PRESSÃO TRABALHO
CÓDIGO	T (mm)	G	CH1	CH2	
25.04.2122	16 S	M 22 x 1.5	27	30	400
25.04.2227	20 S	M 27 x 2.0	32	36	400
25.04.2333	25 S	M 33 x 2.0	41	46	250
25.04.2442	30 S	M 42 x 2.0	50	50	160



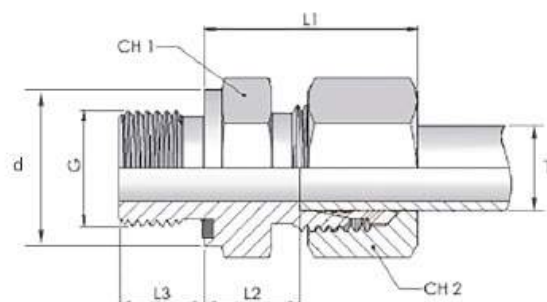

	Ø TUBO	ROSCA	DIMENSÕES				PRESSÃO TRABALHO
CÓDIGO	T (mm)	R	CH1	CH2	L1	L2	
25.05.0102	4 LL	1/8"	11	10	21	11	100
25.05.0202	6 LL	1/8"	11	12	22	10.5	100
25.05.0302	8 LL	1/8"	12	14	24	12.5	100
25.05.0602	6 L	1/8"	12	14	26	11	315
25.05.0604	6 L	1/4"	17	14	31	16	315
25.05.0702	8 L	1/8"	12	14	25.5	14	100
25.05.0704	8 L	1/4"	17	17	31.5	16.5	315
25.05.0706	8 L	3/8"	17	17	31.5	16.5	315
25.05.0708	8 L	1/2"	22	17	36	21	315
25.05.0802	10 L	1/8"	17	19	26.5	8	315
25.05.0804	10 L	1/4"	17	19	32.5	17.5	315
25.05.0806	10 L	3/8"	19	19	33	18	315
25.05.0808	10 L	1/2"	22	19	36	21	315
25.05.0904	12 L	1/4"	19	22	33.5	18.5	315
25.05.0906	12 L	3/8"	19	22	33.5	18.5	315
25.05.0908	12 L	1/2"	22	22	34.5	19.5	315
25.05.1006	15 L	3/8"	24	27	30	10	315
25.05.1008	15 L	1/2"	22	27	37	22	315
25.05.1108	18 L	1/2"	27	32	39	22.5	315
25.05.1112	18 L	3/4"	32	36	41	24.5	315
25.05.1212	22 L	3/4"	32	36	36.5	20	160
25.05.1316	28 L	1"	41	41	38.5	22	160
25.05.1420	35 L	1.1/4"	46	50	44	22.5	160
25.05.1524	42 L	1.1/2"	55	60	46.5	23.5	160
25.05.1604	6 S	1/4"	17	17	37	22	630
25.05.1704	8 S	1/4"	17	19	37	22	630
25.05.1804	10 S	1/4"	19	22	38	21.5	630
25.05.1806	10 S	3/8"	19	22	37	20.5	630
25.05.1904	12 S	1/4"	22	24			630
25.05.1906	12 S	3/8"	22	24	37	20.5	630
25.05.2008	14 S	1/2"	24	27	45	27	630
25.05.2108	16 S	1/2"	32	30	44.5	26	400
25.05.2212	20 S	3/4"	32	36	49.5	28	400
25.05.2316	25 S	1"	41	46	58	34	400
25.05.2420	30 S	1.1/4"	46	50	60	33.5	400
25.05.3002	5 LL	1/8"	11	12	22	10.5	100

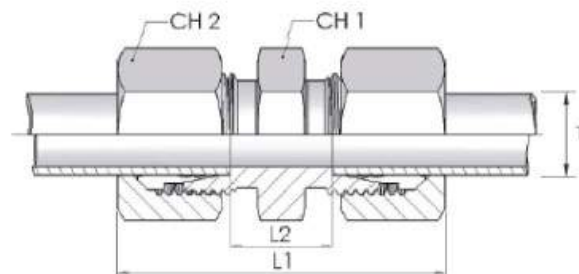

**GE TUBO BSP - WD (Vedante)**
**25.50**

	ROSCA			DIMENSÕES					
CÓDIGO	G	T (mm)	PRESSAO BAR	L1	L2	L3	CH1	CH2	d
25.50.0606	3/8"	6 L	800	26.5	11.5	12	22	14	22
25.50.0804	1/4"	10 L	800	26	11	12	19	19	19
25.50.0806	3/8"	10 L	800	27.5	12.5	12	22	19	22
25.50.0906	3/8"	12 L	800	27.5	12.5	12	22	22	22
25.50.1008	1/2"	15 L	800	29	14	14	27	27	27
25.50.1704	1/4"	8 S	800	30	15	12	19	19	19
25.50.1706	3/8"	8 S	800	30.5	15.5	12	22	19	22
25.50.1808	1/2"	10 S	630	34	17.5	14	27	22	27
25.50.1904	1/4"	12 S	630	33	16.5	12	22	24	19
25.50.1906	3/8"	12 S	630	33.5	17.0	12	22	24	22
25.50.1908	1/2"	12 S	630	34	17.5	14	27	24	27
25.50.2106	3/8"	16 S	630	36.5	18	12	27	30	22
25.50.2108	1/2"	16 S	630	37	18.5	14	27	30	27

**G JUNCAO TUBO TUBO**
**25.11**

	Ø TUBO	DIMENSÕES				
CÓDIGO	T (mm)	CH1	CH2	L1	L2	PRESSÃO BAR
25.11.0101	4 LL	11	10	31	12	100
25.11.0202	6 LL	11	12	32	9	100
25.11.0303	8 LL	12	14	35	12	100
25.11.0404	10 LL	14	17	35	12	100
25.11.0505	12 LL	17	19	35	11	100
25.11.0606	6 L	12	14	39	10	500
25.11.0707	8 L	14	17	40	11	500
25.11.0808	10 L	17	19	42	13	500
25.11.0909	12 L	19	22	43	14	400
25.11.1010	15 L	24	37	46	16	400
25.11.1111	18 L	27	32	48	16	400
25.11.1212	22 L	32	41	52	20	250
25.11.1313	28 L	41	41	54	21	250
25.11.1414	35 L	46	50	63	20	250
25.11.1515	42 L	55	60	66	21	250
25.11.1616	6 S	14	17	45	16	800
25.11.1717	8 S	17	19	47	18	800
25.11.1818	10 S	19	22	49	17	800
25.11.1919	12 S	22	24	51	19	630
25.11.2020	14 S	24	27	57	22	630
25.11.2121	16 S	27	30	57	21	630
25.11.2222	20 S	32	36	66	23	420
25.11.2323	25 S	41	46	74	26	420
25.11.2424	30 S	46	50	80	27	420
25.11.2525	38 S	55	60	90	29	315
25.11.3030	5 LL	11	12	32	9	100

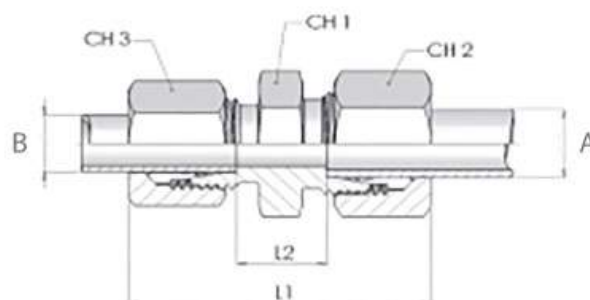
**GR REDUCAO TUBO TUBO**
**25.14**

	Ø TUBO		DIMENSÕES					PRESSÃO
CÓDIGO	A (mm)	B (mm)	CH1	CH2	CH3	L1	L2	PRESSÃO BAR
25.14.0201	6 LL	4 LL	11	12	10	36	9	315
25.14.0706	8 L	6 L	14	17	14	40.5	11	315
25.14.0806	10 L	6 L	17	19	14	41.5	12	315
25.14.0807	10 L	8 L	17	19	17	42.0	12	315
25.14.0906	12 L	6 L	19	22	14	42	13	315
25.14.0907	12 L	8 L	19	22	17	42.5	13	315
25.14.0908	12 L	10 L	19	22	19	43.5	14	315
25.14.1008	15 L	10 L	24	27	19	45	15	315
25.14.1009	15 L	12 L	24	27	22	44.5	15	315
25.14.1109	18 L	12 L	27	32	22	54	15	315
25.14.1110	18 L	15 L	27	32	27	55	15	315
25.14.1210	22 L	15 L	32	36	27	56	15	315
25.14.1211	22 L	18 L	32	36	32	58	15	315
25.14.1312	28 L	22 L	41	41	36	62	16.5	315
25.14.1716	8 S	6 S	17	19	17	48	18	640
25.14.1816	10 S	6 S	19	22	17	48.5	17.5	640
25.14.1817	10 S	8 S	19	22	19	48.5	17.5	640
25.14.1916	12 S	6 S	22	24	17	56	16.5	640
25.14.1917	12 S	8 S	22	24	19	50.5	19.5	640
25.14.1918	12 S	10 S	22	24	22	51	19	640
25.14.2018	14 S	10 S	24	27	22	61	16.5	640
25.14.2019	14 S	12 S	24	27	24	62	17	640
25.14.2119	16 S	12 S	27	30	24	62	17	640
25.14.2120	16 S	14 S	27	30	27	64	17	640
25.14.2219	20 S	12 S	32	36	24	67	20	640
25.14.2221	20 S	16 S	32	36	30	71	20	640
25.14.2422	30 S	20 S	46	50	36	83	22	640

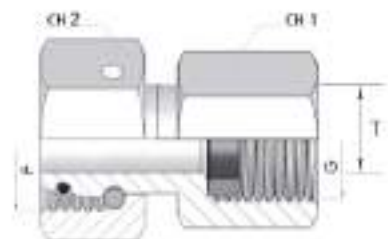
**MAVE JUNCAO MANOMETRO.**
**25.08**

	Ø TUBO	ROSCA		DIMENSÕES		PRESSÃO
CÓDIGO	T (mm)	G	F	CH1	CH2	
25.08.0604	6 L	1/4"	M12X1.5	19	17	315
25.08.0704	8 L	1/4"	M14X1.5	19	17	315
25.08.0804	10 L	1/4"	M16X1.5	19	19	315
25.08.0904	12 L	1/4"	M18X1.5	19	22	315
25.08.1608	6 S	1/2"	M14X1.5	27	17	640
25.08.1708	8 S	1/2"	M16X1.5	27	19	640
25.08.1808	10 S	1/2"	M18X1.5	27	22	640
25.08.1908	12 S	1/2"	M20X1.5	27	24	640

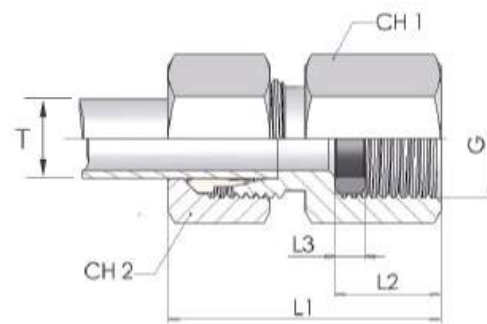

	Ø TUBO	ROSCA	DIMENSÕES			PRESSÃO TRABALHO
CÓDIGO	T (mm)	G	CH1	CH2	L1	BAR
25.44.0602	6 L	1/8	14	14	34	315
25.44.0604	6 L	1/4	19	14	39	315
25.44.0704	8 L	1/4	19	17	39	315
25.44.0706	8 L	3/8	24	17	40	315
25.44.0804	10 L	1/4	19	19	40	315
25.44.0806	10 L	3/8	22	19	44.2	315
25.44.0906	12 L	3/8	24	22	41	315
25.44.0908	12 L	1/2	27	22	44	315
25.44.1006	15 L	3/8	22	27	42	315
25.44.1008	15 L	1/2	27	27	46	315
25.44.1108	18 L	1/2	27	32	47	315
25.44.1112	18 L	3/4	32	32	51	315
25.44.1212	22 L	3/4	36	36	52	160
25.44.1316	28 L	1	41	41	54.5	160
25.44.1604	6 S	1/4	19	17	41	400
25.44.1704	8 S	1/4	19	19	41	400
25.44.1806	10 S	3/8	24	22	43	400
25.44.1808	10 S	1/2	27	22	49	400
25.44.1906	12 S	3/8	24	24	43	400
25.44.1908	12 S	1/2	27.1		50	400
25.44.2108	16 S	1/2	30	30	50	400
25.44.2212	20 S	3/4	36	36	56	315
25.44.2316	25 S	1	41	46	62	315

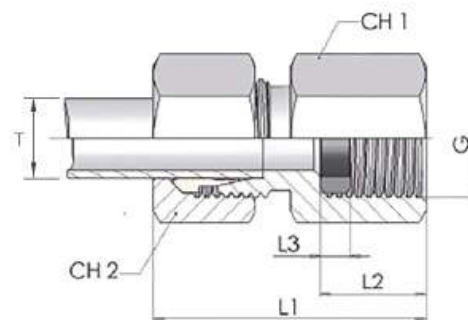
**GAJUNCAO TUBO / ROSCA MET.**
**25.46**

	Ø TUBO	ROSCA	DIMENSÕES			
CÓDIGO	T (mm)	G	CH1	CH2	L1	PRESSÃO BAR
25.46.0610	6 L	M 10 x 1.0	14	14	37	
25.46.0712	8 L	M 12 x 1.5	17	17	42	
25.46.0714	8 L	M 14 x 1.5	19	17	44	
25.46.0814	10 L	M 14 x 1.5	19	19	43	
25.46.0916	12 L	M 16 x 1.5	22	22	44	
25.46.1018	15 L	M 18 x 1.5	24	27	47	
25.46.1122	18 L	M 22 x 1.5	27	32	48	
25.46.1226	22 L	M 26 x 1,5	32	36	55	
25.46.1612	6 S	M 12 x 1.5	19	17	44	
25.46.1714	8 S	M 14 x 1.5	19	19	44	
25.46.1816	10 S	M 16 x 1.5	22	22	46	
25.46.1918	12 S	M 18 x 1.5	24	24	47	
25.46.2122	16 S	M 22 x 1.5	27	30	53	

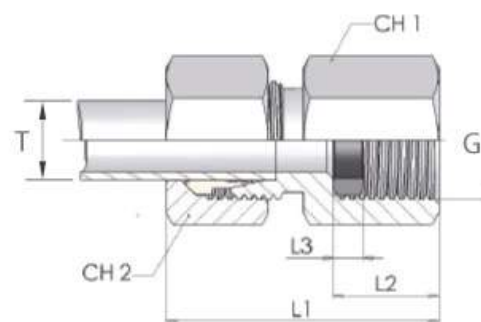
**MAV JUNCAO MANOMETRO**
**25.07**

	Ø TUBO	ROSCA	DIMENSÕES				
CÓDIGO	T (mm)	G	CH1	CH2	L3	L2	BAR
25.07.0604	6 L	1/4"	19	14	37	13	315
25.07.0704	8 L	1/4"	19	17	37	13	315
25.07.0804	10 L	1/4"	19	19	38	13	315
25.07.0904	12 L	1/4"	19	22	38	13	315
25.07.1608	6 S	1/2"	27	17	46	19	640
25.07.1708	8 S	1/2"	27	19	46	19	630
25.07.1808	10 S	1/2"	27	22	47	19	630
25.07.1908	12 S	1/2"	27	24	47	19	640

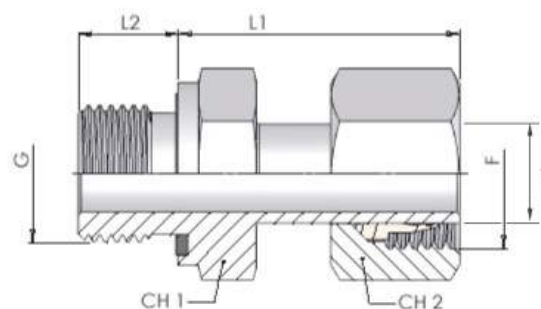
**EGE JUNCAO REGULAVEL BSP**
**25.06**

	Ø TUBO	ROSCA	DIMENSÕES				PRESSÃO TRABALHO
CÓDIGO	T (mm)	G	CH1	CH2	L1	L2	
25.06.0602	6 L	1/8"	14	14	8	24.5	500
25.06.0604	6 L	1/4"	19	17	12	1/4	500
25.06.0704	8 L	1/4"	19	17	12	29.5	500
25.06.0804	10 L	1/4"	19	19	12	27.5	500
25.06.0806	10 L	3/8"	22	22	12	34	500
25.06.0808	10 L	1/2"	27	19			500
25.06.0904	12 L	1/4"	19	22	12	29.5	400
25.06.0906	12 L	3/8"	22	22	12	34.0	400
25.06.0908	12 L	1/2"	27	22	14	34.5	400
25.06.1006	15 L	3/8"	22	27	12	31.5	400
25.06.1008	15 L	1/2"	27	27	14	32.0	400
25.06.1108	18 L	1/2"	27	32	14	31.5	400
25.06.1212	22 L	3/4"	32	36	16	32.5	250
25.06.1316	28 L	1"	41	41	18	35.0	250
25.06.1420	35 L	1.1/4"	50	50	20	42.5	250
25.06.1524	42 L	1.1/2"	55	60	22	46.5	250
25.06.1604	6 S	1/4"	19	17	12	27	800
25.06.1704	8 S	1/4"	19	19	12	29.5	800
25.06.1806	10 S	3/8"	22	22	12	32.0	800
25.06.1906	12 S	3/8"	22	24	12	34.0	630
25.06.1908	12 S	1/2"	27	24	12	34.5	630
25.06.2008	14 S	1/2"	27	27	14	36.5	630
25.06.2108	16 S	1/2"	27	30	14.0	37	630
25.06.2212	20 S	3/4"	32	36	16	43.0	420
25.06.2316	25 S	1"	41	46	18	48.0	420
25.06.2416	30 S	1"	41	49	18	51	420
25.06.2420	30 S	1.1/4"	50	50	20	51	420
25.06.2524	38 S	1.1/2"	55	60	22	60	420

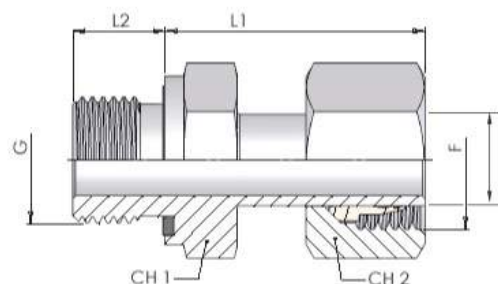

**EGE JUNCAO REGULAVEL MET.**
**25.30**

	Ø TUBO	ROSCA	DIMENSÕES				PRESSÃO TRABALHO
CÓDIGO	T (mm)	G	CH1	CH2	L2	L1	
25.30.0610	6 L	M 10 x 1	14	14	8	24.5	315
25.30.0712	8 L	M 12 x 1.5	17	17	12	26.5	315
25.30.0814	10 L	M 14 x 1.5	19	19	12	27.5	315
25.30.0916	12 L	M 16 x 1.5	22	22	12	30.5	315
25.30.1018	15 L	M 18 x 1.5	24	27	12	31.5	315
25.30.1122	18 L	M 22 x 1.5	27	32	14	31.5	315
25.30.1612	6 S	M 12 x 1.5	17	17	12	27	630
25.30.1714	8 S	M 14 x 1.5	19	19	12	29.5	630
25.30.1816	10 S	M 16 x 1.5	22	22	12	32	630
25.30.1918	12 S	M 18 x 1.5	24	24	12	34	630
25.30.2122	16 S	M 22 x 1.5	27	30	14	37	400

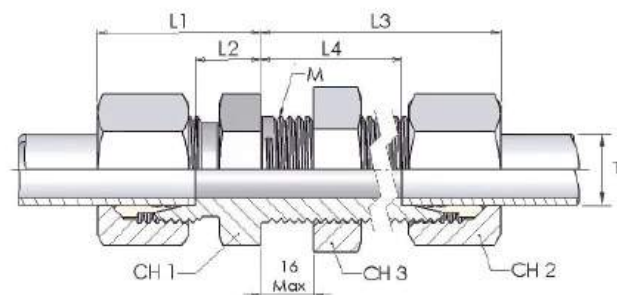

	Ø TUBO	ROSCA	DIMENSÕES						
CÓDIGO	T (mm)	M	CH1	CH2	L1	L2	L3	L4	CH3
25.12.0606	6 L	M 12 x 1.5	17	14	22	7	42	27	17
25.12.0707	8 L	M 14 x 1.5	19	17	23	8	42	27	19
25.12.0808	10 L	M 16 x 1.5	22	19	25	10	43	28	22
25.12.0909	12 L	M 18 x 1.5	24	22	25	10	44	29	24
25.12.1010	15 L	M 22 x 1.5	27	27	27	12	46	31	30
25.12.1111	18 L	M 26 x 1.5	32	32	30	13.5	49	32.5	36
25.12.1212	22 L	M 30 x 2.0	36	36	33	16.5	51	34.5	41
25.12.1313	28 L	M 36 x 2.0	41	41	35	18.5	52	35.5	46
25.12.1414	35 L	M 45 x 2.0	50	50	40		58	36.5	17
25.12.1515	42 L	M 52 x 2.0	60	60		19	59	36	65
25.12.1616	6 S	M 14 x 1.5	19	17	27	12	44	29	19
25.12.1717	8 S	M 16 x 1.5	22	19	28	13	44	29	22
25.12.1818	10 S	M 18 x 1.5	24	22	31	14.5	46	29.5	24
25.12.1919	12 S	M 20 x 1.5	27	24	31	14.5	47	30.5	27
25.12.2020	14 S	M 22 x 1.5	30	27	35	17	50	32	30
25.12.2121	16 S	M 24 x 1.5	32	30	35	16.5	50	31.5	32
25.12.2222	20 S	M 30 x 2.0	41	36	39	17.5	55	33.5	41
25.12.2323	25 S	M 36 x 2.0	46	46	44	20	59	35	46
25.12.2424	30 S	M 42 x 2.0	50	50	48	21.5	64	37.5	50
25.12.2525	38 S	M 52 x 2.0	65	60	53	22	68	30	65

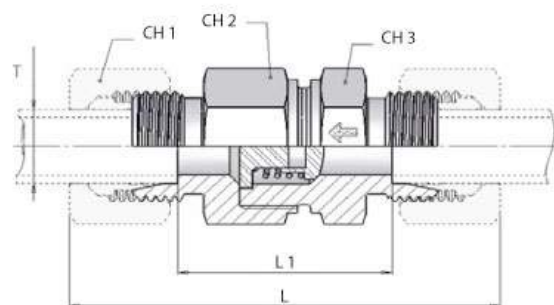
**RHD VALV. DE RETENÇÃO**
**25.26**

	Ø TUBO	DIMENSÕES					PRESSÃO
CÓDIGO	T (mm)	CH1	CH2	CH3	L	L1	
25.26.06	6 L	17	14	17	58	29	400
25.26.07	8 L	19	17	19	59	30	400
25.26.08	10 L	22	19	24	69.5	40.5	400
25.26.09	12 L	27	22	30	72.5	43.5	400
25.26.10	15 L	27	27	32	77.5	47.5	400
25.26.11	18 L	36	32	41	83.5	51.5	400
25.26.12	22 L	41	36	46	93.5	61.5	250
25.26.13	28 L	50	41	55	102.5	69.5	250
25.26.16	6 S	19	17	19	63.5	34.5	420
25.26.17	8 S	19	19	19	63.5	34.5	420
25.26.18	10 S	22	22	24	72.5	40.5	420
25.26.19	12 S	24	24	27	74.5	42.5	420
25.26.20	14 S	27	27	32	82.5	47.5	420
25.26.21	16 S	32	30	36	86.5	50.5	420
25.26.22	20 S	41	36	50	97.5	54.5	420
25.26.23	25 S	46	46	55	106.5	58.5	420

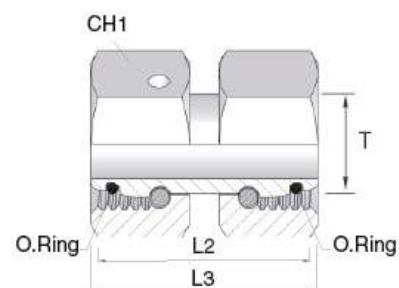

	Ø TUBO	DIMENSÕES			PRESSÃO
CÓDIGO	T (mm)	CH1	L2	L3	
25.79.06	6 L	14	34	35	315
25.79.07	8 L	17	34	35	315
25.79.08	10 L	19	36	37	315
25.79.09	12 L	22	36	37	315
25.79.10	15 L	27	39	40	315
25.79.11	18 L	32	40.5	41.5	315
25.79.12	22 L	36	45	46	315
25.79.16	6 S	17	37	38	315
25.79.17	8 S	19	37	38	315
25.79.18	10 S	22	41	43	315
25.79.19	12 S	24	42	44	315
25.79.20	14 S	27	45	48	315
25.79.21	16 S	30	46	49	315

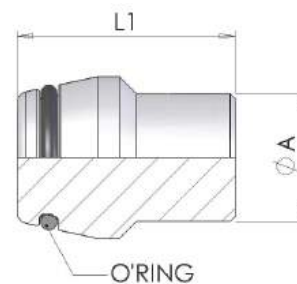
**BUTZEN**
**25.80**

	Ø TUBO	ROSCA	DIMENSÕES	PRESSÃO
CÓDIGO	A (mm)	R	L1	
25.80.06	6 L/S	M 12 x 1.5	19	500
25.80.07	8 L/S	M 14 x 1.5	19	500
25.80.08	10 L/S	M 16 x 1.5	21	500
25.80.09	12 L/S	M 18 x 1.5	21	400
25.80.10	15 L	M 26 x 1.5	21	400
25.80.11	18 L	M 26 x 15	22	400
25.80.12	22 L	M 30 x 2.0	23	250
25.80.13	28 L	M 36 x 2.0	22	250
25.80.14	35 L	M 42 x 2.0	25	250
25.80.15	42 L	M 52 x 2.0	26	250
25.80.20	14 S	M 22 x 1.5	21	630
25.80.21	16 S	M 30 x 2.0	22	630
25.80.22	20 S	M 30 x 2.0	23	420
25.80.23	25 S	M 36 x 2.0	26	420
25.80.24	30 S	M 42 x 2.0	27	420
25.80.25	38 S	M 52 x 2.0	31	420

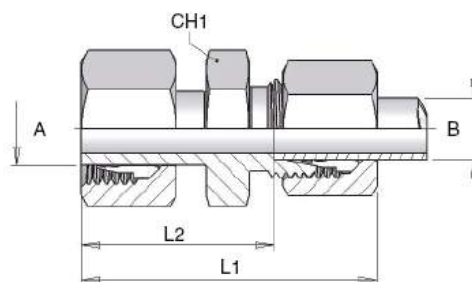
**KOR REDUCAO REGULAVEL**
**25.13**

	REGULÁVEL	Ø TUBO	DIMENSÕES			PRESSÃO
CÓDIGO	A	B	CH1	L1	L2	Bar
25.13.0706	8 L	6 L	14	40	25.5	315
25.13.0806	10 L	6 L	14	42	27	315
25.13.0807	10 L	8 L	17	42	27	315
25.13.0906	12 L	6 L	14	42	27	315
25.13.0907	12 L	8 L	17	42	27	315
25.13.0908	12 L	10 L	17	43	28	315
25.13.1006	15 L	6 L	17	41.5	27	315
25.13.1007	15 L	8 L	17	42	27	315
25.13.1008	15 L	10 L	17	43	28	315
25.13.1009	15 L	12 L	19	44	29	315
25.13.1106	18 L	6 L	19	44	30	160
25.13.1107	18 L	8 L	19	45	29.5	160
25.13.1108	18 L	10 L	19	45.5	31	160
25.13.1109	18 L	12 L	19	45	30.5	160
25.13.1110	18 L	15 L	24	46.5	32	160
25.13.1206	22 L	6 L	24	45	30.5	160
25.13.1207	22 L	8 L	24	45.5	31	160
25.13.1208	22 L	10 L	24	47	31.5	160
25.13.1209	22 L	12 L	24	46	32	160
25.13.1210	22 L	15 L	24	48	32.5	160
25.13.1211	22 L	18 L	27	49	33	160
25.13.1310	28 L	15 L	32	49	34	160
25.13.1311	28 L	18 L	32	50	34	160
25.13.1312	28 L	22 L	32	52	35.5	160
25.13.1409	35 L	12 L	46	60	43	160
25.13.1411	35 L	18 L		52	34	160
25.13.1412	35 L	22 L	46	65	43	160
25.13.1413	35 L	28 L	46	65	43	160
25.13.1511	42 L	18 L	46	63	43	160
25.13.1512	42 L	22 L	50	61	40	160
25.13.1513	42 L	28 L	50	63	40	160
25.13.1514	42 L	35 L		61	35	160
25.13.1716	8 S	6 S	17	44	29	640
25.13.1816	10 S	6 S	17	46.5	31.5	640
25.13.1817	10 S	8 S	17	49	34	640
25.13.1916	12 S	6 S	17	46	31	640
25.13.1917	12 S	8 S	17	48	33	640
25.13.1918	12 S	10 S	19	48.5	32.5	640

	REGULÁVEL	Ø TUBO	DIMENSÕES			PRESSÃO
CÓDIGO	A	B	CH1	L1	L2	Bar
25.13.2016	14 S	6 S	17	50	35	640
25.13.2017	14 S	8 S	17	50	35	640
25.13.2018	14 S	10 S	19	51	35	640
25.13.2019	14 S	12 S	22	52.5	36.5	640
25.13.2116	16 S	6 S	17	51	36	400
25.13.2117	16 S	8 S	17	51	36	400
25.13.2118	16 S	10 S	19	52	36	400
25.13.2119	16 S	12 S	22	53.5	37.5	400
25.13.2120	16 S	14 S	24	57	39	400
25.13.2217	20 S	8 S	22	57	42	400
25.13.2218	20 S	10 S	22	57	41	400
25.13.2219	20 S	12 S	22	57	41	400
25.13.2220	20 S	14 S	24	60.5	42.5	400
25.13.2221	20 S	16 S	27	61	42	400
25.13.2317	25 S	8 S	27	55	37	400
25.13.2319	25 S	12 S	27	60	44	400
25.13.2320	25 S	14 S	27	63	45	400
25.13.2321	25 S	16 S	27	63	45	400
25.13.2322	25 S	20 S	32	68	46.5	400
25.13.2421	30 S	16 S	32	67.5	49	400
25.13.2422	30 S	20 S	32	71	49	400
25.13.2423	30 S	25 S	41	84	56	315
25.13.2517	38 S	8 S		59	41	315
25.13.2522	38 S	20 S	50	84	61	315
25.13.2523	38 S	25 S	50	87	60	315
25.13.2524	38 S	30 S	50	76	46	315

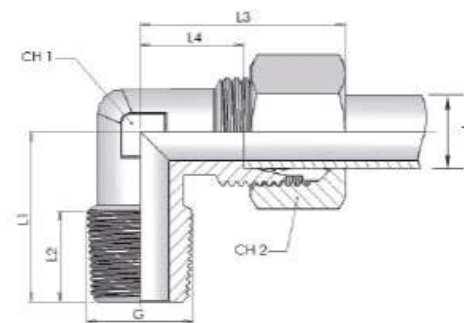
**WE JOELHO TUBO BSPT**
**25.10**

	Ø TUBO	ROSCA	DIMENSÕES					
CÓDIGO	mm		CH1	CH2	L1	L1	L3	
25.10.0102	4 LL	1/8"	9	10	11.5	17	20.5	100
25.10.0202	6 LL	1/8"	9	12	11.5	17	21	100
25.10.0302	8 LL	1/8"	12	14	14.5	20	23	100
25.10.0602	6 L	1/8"	12	14	14.5	20	27	315
25.10.0604	6 L	1/4"	12	17	18	26	29	315
25.10.0702	8 L	1/8"	12	17		26	31	315
25.10.0704	8 L	1/4"	12	17	18	26	29	315
25.10.0706	8 L	3/8"	16.5	17		28	12	315
25.10.0802	10 L	1/8"	13	19		27	32	315
25.10.0804	10 L	1/4"	14	19	18	27	30	315
25.10.0806	10 L	3/8"	17	19		22	34	315
25.10.0904	12 L	1/4"	16.5	22		27	34	315
25.10.0906	12 L	3/8"	17	22	20	28	32	315
25.10.0908	12 L	1/2"	19	22		34	39	315
25.10.1006	15 L	3/8"	19	22		34	39	315
25.10.1008	15 L	1/2"	19	27	22.5	34	36	315
25.10.1108	18 L	1/2"	24	32	24.5	36	40	315
25.10.1112	18 L	3/4"	24	32		37	44	315
25.10.1212	22 L	3/4"	27	36	28.5	42	44	160
25.10.1316	28 L	1"	36	41	32.5	48	47	160
25.10.1420	35 L	1.1/4"	41	50	25.6	54	56	160
25.10.1524	42 L	1.1/2"	50	60	44	61	63	160
25.10.1604	6 S	1/4"	12	17	18	26	31	630
25.10.1704	8 S	1/4"	14	19		27	32	630
25.10.1806	10 S	3/8"	17	22	19	28	34	630
25.10.1906	12 S	3/8"	17	24	19.0	28	38	630
25.10.1908	12 S	1/2"	19	24		35	40	
25.10.2008	14 S	1/2"	19	27	19.5	32	40	630
25.10.2106	16 S	3/8"	24	30		32	43	
25.10.2108	16 S	1/2"	24	30	21.5	32	43	400
25.10.2212	20 S	3/4"	27	36	27.5	42	48	400
25.10.2316	25 S	1"	36	46	32.5	48	54	400
25.10.2416	30 S	1"	41	50		50	66	400
25.10.2420	30 S	1.1/4"	41	50	37	54	62	400
25.10.2524	38 S	1.1/2"	50	60	44	61	72	315

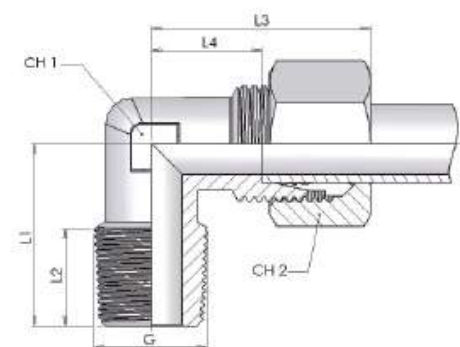

**WE JOELHO TUBO MET**
**25.28**

	Ø TUBO	ROSCA	DIMENSÕES				PRESSÃO
CÓDIGO	mm	F	CH1	CH2	L1	L3	BAR
25.28.0108	4 LL	M 8 x 1	9	10	17	20.5	100
25.28.0210	6 LL	M 10 x 1.0	9	12	17	21	100
25.28.0310	8 LL	M 12 x 1.5	12	14	24	23	100
25.28.0610	6 L	M 10 x 1	12	14	20	27	315
25.28.0612	6 L	M 12 x 1.5	18	14		24	315
25.28.0712	8 L	M 12 x 1.5	12	17	26	29	315
25.28.0812	10 L	M 12 x 1.5	14	19	28	36	100
25.28.0814	10 L	M 14 x 1.5	14	19	27	30	315
25.28.0916	12 L	M 16 x 1.5	17	22	28	32	315
25.28.1018	15 L	M 18 x 1.5	19	27	32	36	315
25.28.1022							
25.28.1122	18 L	M 22 x 1.5	24	32	36	40	315

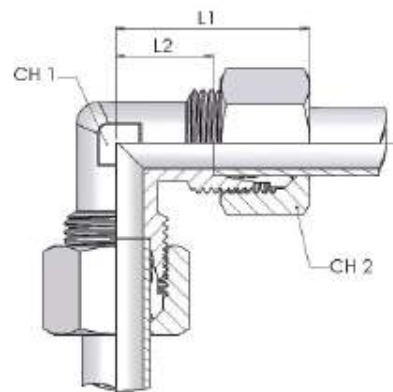
**W JOELHO TUBO TUBO**
**25.15**

	Ø TUBO	DIMENSÕES				PRESSÃO
CÓDIGO	mm	CH1	CH2	L1	L2	BAR
25.15.0101	4 LL	9	10	21	11	100
25.15.0202	6 LL	12	9	21	9.5	100
25.15.0303	8 LL	12	14	23	11.5	100
25.15.0404	10 LL	9	12	21	9.5	100
25.15.0505	12 LL	12	14	23	11.5	100
25.15.0606	6 L	12	14	27	12	500
25.15.0707	8 L	12	17	29	14	500
25.15.0808	10 L	14	19	30	15	500
25.15.0909	12 L	19	22	32	17	400
25.15.1010	15 L	19	27	36	21	400
25.15.1111	18 L	24	32	40	23.5	400
25.15.1212	22 L	27	36	44	27.5	250
25.15.1313	28 L	36	41	47	30.5	250
25.15.1414	35 L	41	50	56	34.5	250
25.15.1515	42 L	50	60	63	40	250
25.15.1616	6 S	12	17	31	16	800
25.15.1717	8 S	14	19	32	17	800
25.15.1818	10 S	19	22	34	17.5	800
25.15.1919	12 S	17	24	38	21.5	640
25.15.2020	14 S	19	27	40	22	630
25.15.2121	16 S	24	30	43	24.5	420
25.15.2222	20 S	27	36	48	26.5	420
25.15.2323	25 S	36	46	54	30	420
25.15.2424	30 S	41	50	62	35.5	420
25.15.2525	38 S	50	60	72	41	315

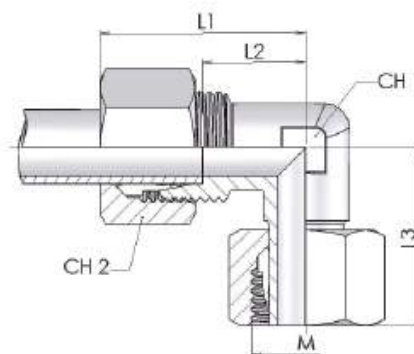
**EW JOELHO REGULAVEL**
**25.17**

	Ø TUBO	ROSCA	DIMENSÕES					PRESSÃO
CÓDIGO	mm	M	CH1	CH2	L1	L2	L3	
25.17.0606	6 L	M 14 x 1.5	12	14	29	14	27	315
25.17.0707	8 L	M 14 x 1.5	12	17	29	14	27	315
25.17.0808	10 L	M 16 x 1.5	14	19	30	15	29	315
25.17.0909	12 L	M 18 x 1.5	17	22	32	17	29.5	315
25.17.1010	15 L	M 22 x 1.5	19	27	36	21	32.5	250
25.17.1111	18 L	M 26 x 1.5	24	32	40.5	23.5	35.5	250
25.17.1212	22 L	M 30 x 2	27	36	44	27.5	38.5	160
25.17.1313	28 L	M 36 x 2.0	36	41	47	30.5	41.5	160
25.17.1414	35 L	M 45 x 2.0	41	50	56	34.5	51	160
25.17.1515	42 L	M 52 x 2.0	50	60	63	40	56	160
25.17.1616	6 S	M 14 x 1.5	12	17	31	16	27	640
25.17.1717	8 S	M 10 x 1.5	14	19	32	17	27.5	400
25.17.1818	10 S	M 18 x 1.5	17	22	34	17.5	30	400
25.17.1919	12 S	M 20 x 1.5	17	24	38	21.5	31	400
25.17.2020	14 S	M 22 x 1.5	19	27	40	22	35	640
25.17.2121	16 S	M 24 x 1.5	24	30	43	24.5	36.5	400
25.17.2222	20 S	M 30 x 2.0	27	36	48	26.5	44.5	400
25.17.2323	25 S	M 36 x 2.0	36	46	54	30	49.5	250
25.17.2424	30 S	M 42 x 2.0	41	50	62	65.5	55	160
25.17.2525	38 S	M 52 x 2.0	50	60	72	41	63	315

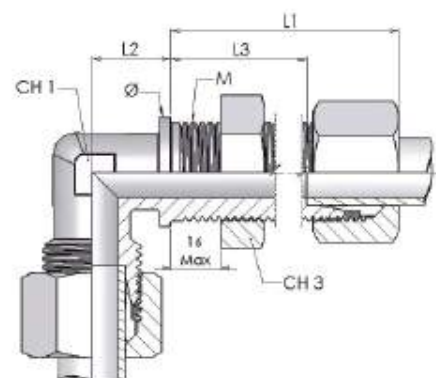
**WSV JOELHO TRESPASSE**
**25.16**

	Ø TUBO	ROSCA	DIMENSÕES							PRESSÃO
CÓDIGO	mm	M	CH1	CH3	E6	L3	L1	L2	L1	
25.16.0606	6 L	M 12 x 1.5	12	14	17	27	14	29	42	315
25.16.0707	8 L	M 14 x 1.5	12	17	17	27	14	29	42	315
25.16.0808	10 L	M 16 x 1.5	14	19	18	28	15	30	43	315
25.16.0909	12 L	M 18 x 1.5	17	22	20	29	17	32	44	315
25.16.1010	15 L	M 22 x 1.5	19	27	23	31	21	36	46	315
25.16.1111	18 L	M 26 x 1.5	24	32	24	32.5	23.5	40	49	315
25.16.1212	22 L	M 30 x 2.0	27	36	30	34.5	27.5	44	51	160
25.16.1313	28 L	M 36 x 2.0	36	41	34	35.5	30.5	47	52	160
25.16.1414	35 L	M 45 x 2.0	41	50		36.5	34.5	56	58	160
25.16.1515	42 L	M 52 x 2.0	50	60	43	36	40	63	59	160
25.16.1616	6 S	M 14 x 1.5	12	17		29	16	31	44	630
25.16.1717	8 S	M 16 x 1.5	14	19		29	17	32	44	630
25.16.1818	10 S	M 18 x 1.5	17	22		29.5	17.5	34	46	630
25.16.1919	12 S	M 20 x 1.5	19	24	21	30.5	21.5	38	47	630
25.16.2020	14 S	M 22 x 1.5	19	27	23	32	22	40	50	630
25.16.2121	16 S	M 24 x 1.5	24	30		31.5	24.5	43	50	400
25.16.2222	20 S	M 30 x 2.0	27	36	36	30	26.5	48	26.5	400
25.16.2323	25 S	M 36 x 2.0	36	46			59	34	35	400
25.16.2424	30 S	M 42 x 2.0	41	50	39	37.5	35.5	62	64	400
25.16.2525	38 S	M 52 x 2.0	50	60	43	37	41	72	68	315

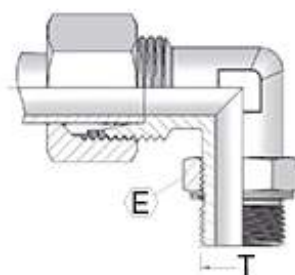
**CBB JOELHO TUBO BSP ORIENT.**
**25.34**

	Ø TUBO	ROSCA	DIMENSÕES				PRESSÃO TRABALHO
CÓDIGO		T	L3	L4	CH1	E	
25.34.0602	6 L	1/8	26	14	12	14	315
25.34.0704	8 L	1/4	32	16	12	19	315
25.34.0804	10 L	1/4	34	17	17	19	315
25.34.0906	12 L	3/8	40.5	17	17	22	315
25.34.1008	15 L	1/2	43	21	19	27	315
25.34.1108	18 L	1/2	49	23.5	24	27	315
25.34.1212	22 L	3/4	49	27.5	27	36	160
25.34.1316	28 L	1	59	30.5	36	41	160
25.34.1604	6 S	1/4	32	15	12	19	630
25.34.1704	8 S	1/4	36	17	14	19	630
25.34.1806	10 S	3/8	38	17.5	17	22	630
25.34.1906	12 S	3/8	38	21.5	19	22	630
25.34.2108	16 S	1/2	49	25	24	27	400
25.34.2212	20 S	3/4	51	28	27	36	400
25.34.2316	25 S	1	59	30	36	41	400

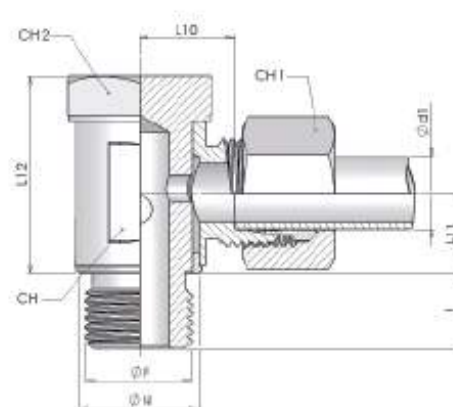

	Ø TUBO	ROSCA	DIMENSÕES							
CÓDIGO	mm	ROSCA	I	L10	I	L11	L12	CH1	CH	CH2
25.09.0102	4 LL	1/8"	6	11.5	21.5	9	21.5	10	14	14
25.09.0202	6 LL	1/8"	6	12	21.5	9	23.5	12	14	14
25.09.0302	8 LL	1/8"	6	12	21.5	9	23.5	12	14	14
25.09.0602	6 L	1/8"	6	10.5	21.5	9	25.5			
25.09.0604	6 L	1/4"	6	10.5	21.5	9	28.5	14	14	14
25.09.0704	8 L	1/4"	9	13.5	26	12	28.5	17	19	17
25.09.0804	10 L	1/4"	9	13.5	27	13	28.5	19	19	19
25.09.0806	10 L	3/8"	9	15	32	15	30	22	22	22
25.09.0906	12 L	3/8"	12		32					
25.09.0908	12 L	1/2"	9	15	32	15	30	22	22	22
25.09.1008	15 L	1/2"		17	37	17	32	27	24	24
25.09.1108	18 L	1/2"	11.5	20.5	43.5	20.5	37	32	32	27
25.09.1212	22 L	3/4"	13	24.5	48	23	41	36	36	32
25.09.1604	6 S	1/4"	9	14.5	26	12	29.5	17	19	17
25.09.1704	8 S	1/4"	9	14.5	27	13	29.5	19	19	19
25.09.1806	10 S	3/8"	9	16.5	32	15	33.5	22	22	22
25.09.1906	12 S	3/8"	9	17	37	17		24	24	24
25.09.2008	14 S	1/2"	11	19.5	38	17	37.5	27	27	27
25.09.2108	16 S	1/2"	11.5	21.5	43.5	24.5	40	30	32	27
25.09.2212	20 S	3/4"	13	24.5	48	23	46	36	36	32
25.09.2316	25 S	1"	13							

## SWVE BANJO MÉTRICO

25.24

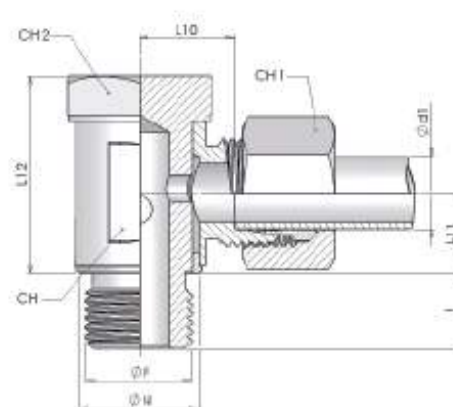

	Ø TUBO	ROSCA	PRESSÃO	DIMENSÕES							
CÓDIGO	mm	R	BAR	CH	CH1	CH2	I	L1	L2	L3	L4
25.24.0610	6 L	M10x1	250	14	14	14	6	10.5	9	21.5	25.5
25.24.0712	8 L	M12x1.5	160	19	17	17	9	13.5	26	12	28.5
25.24.0814	10 L	M14x1.5	160	19	19	19	9	13.5	13	27	28.5
25.24.0916	12 L	M16x1.5	250	22	22	22	9	15	15	32	30
25.24.1018	15 L	M18x1.5	100	24	27	27	9	18.5	17	38	32
25.24.1122	18 L	M22x1.5	100	32	32	27	11.5	20.5	20.5	43.5	37
25.24.1226	22 L	M26x1.5	100	36	36	32	13	24.5	23	48	37
25.24.1612	6 S	M12x1.5	160	19	17	17	9	14.5	26	12	29.5
25.24.1714	8 S	M14x1.5	160	19	19	19	9	14.5	27	13	29.5
25.24.1816	10 S	M16x1.5	100	22	22	22	9	16.5	32	15	33.5
25.24.1918	12 S	M18x1.5	100	24	24	22	9	17	37	17	33
25.24.2020	14 S	M20x1.5	100	27	27	27	11	19.5	38	17	37.5
25.24.2122	16 S	M22x1.5	100	32	30	27	11.5				
25.24.2227	20 S	M27x2	100	36	36	32	13	24.5	48	23	

**SWVE WHS BANJO**
**25.25**
**CÓDIGO**

25.25.1704

25.25.1906

25.25.2108

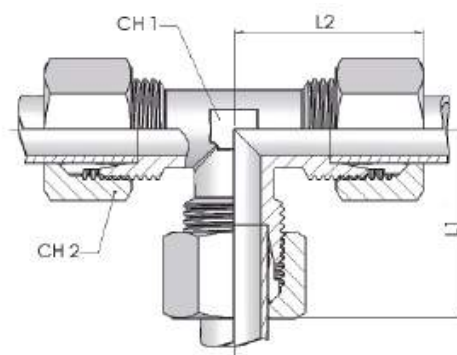
**T TUBO TUBO**
**25.18**

	Ø TUBO	DIMENSÕES				PRESSÃO
CÓDIGO	mm	CH1	CH2	L1	L2	
25.18.0101	4 LL	12	10	11	21	100
25.18.0202	6 LL	12	12	9.5	21	100
25.18.0303	8 LL	12	14	23	11.5	100
25.18.0404	10 LL	14	17	27	15	100
25.18.0606	6 L	12	12	9.5	21	500
25.18.0707	8 L	12	17	14	29	500
25.18.0808	10 L	14	19	15	30	500
25.18.0909	12 L	17	22	17	32	400
25.18.1010	15 L	19	27	21	36	400
25.18.1111	18 L	24	32	40	23.5	400
25.18.1212	22 L	27	36	27.5	44	250
25.18.1313	28 L	36	41	30.5	47	250
25.18.1414	35 L	41	50	34.5	56	250
25.18.1515	42 L	50	60	40	63	250
25.18.1616	6 S	12	17	16	31	800
25.18.1717	8 S	14	19	17	32	800
25.18.1818	10 S	17	22	17.5	34	800
25.18.1919	12 S	17	24	21.5	38	630
25.18.2020	14 S	19	27	22	40	630
25.18.2121	16 S	24	30	24.5	43	630
25.18.2222	20 S	27	36	20	48	420
25.18.2323	25 S	36	46	30	54	420
25.18.2424	30 S	41	50	35.5	62	420
25.18.2525	38 S	50	60	41	72	315



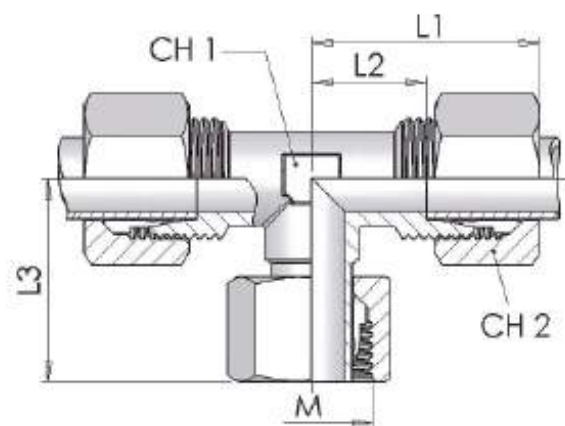

	Ø TUBO	ROSCA	DIMENSÕES					PRESSÃO
CÓDIGO	mm	M	CH1	CH2	L1	L2	L3	
25.19.0606	6 L	M12x1.5	12	14	29	14	27	315
25.19.0707	8 L	M14x1.5	12	17	29	14	27	315
25.19.0808	10 L	M16x1.5	14	19	30	15	29	315
25.19.0909	12 L	M18x1.5	17	22	32	17	29.5	315
25.19.1010	15 L	M22x1.5	19	27	36	21	32.5	250
25.19.1111	18 L	M 26 x 1.5	24	32	40.5	23.5	35.5	250
25.19.1212	22 L	M 30 x 2.0	27	36	44	27.5	38.5	160
25.19.1313	28 L	M 36 x 2.0	36	41	47	30.5	41.5	160
25.19.1414	35 L	M 45 x 2.0	41	50	56	34.5	51	160
25.19.1515	42 L	M 52 x 2.0	50	60	63	40	56	160
25.19.1616	6 S	M 14 x 1.5	12	17	31	16	27	400
25.19.1717	8 S	M 16 x 1.5	14	19	32	17	27	400
25.19.1818	10 S	M 18 x 1.5	17	22	34	17.5	30	400
25.19.1919	12 S	M 20 x 1.5	17	24	38	21.5	31	640
25.19.2020	14 S	M 22 x 1.5	19	27	40	22	35	640
25.19.2121	16 S	M 24 x 1.5	24	30	43	24.5	36.5	400
25.19.2222	20 S	M 30 x 2.0	27	36	48	26.5	44.5	400
25.19.2323	25 S	M 36 x 2.0	36	46	54	30	50	250
25.19.2424	30 S	M 42 x 2.0	41	50	62	35.5	55	160
25.19.2525	38 S	M 52 x 2.0	50	60	72	41	63	315

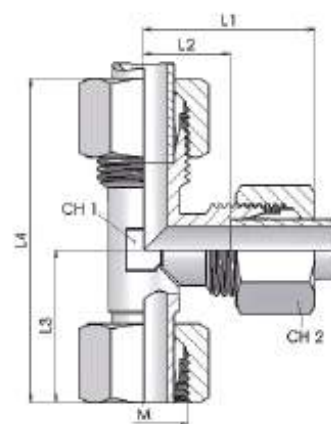

	Ø TUBO	ROSCA	DIMENSÕES					PRESSÃO TRABALHO
CÓDIGO	mm	M	CH2	L1	L2	L3	L4	
25.20.0606	6 L	M 12 x 1.5	14	29	14	27	53	315
25.20.0707	8 L	M 14 x 1.5	17	29	14	27	56	315
25.20.0808	10 L	M 16 x 1.5	19	30	15	29	58.5	315
25.20.0909	12 L	M 18 x 1.5	22	32	17	29.5	61	315
25.20.1010	15 L	M 22 x 1.5	27	36	21	32.5	68	315
25.20.1111	18 L	M 26 x 1.5	36	40,5	23.5	35.5	75	250
25.20.1212	22 L	M 30 x 1.5	36	44	27.5	38.5	82	160
25.20.1313	28 L	M 36 x 2.0	41	47	30.5	41.5	88.5	160
25.20.1414	35 L	M 45 x 2.0	50	56	34.5	51	107	160
25.20.1515	42 L	M 52 x 2.0	60	63	40	56	119	160
25.20.1616	6 S	M 14 x 1.5	17	31	16	27	58	640
25.20.1717	8 S	M 16 x 1.5	19	32	17	27	59	640
25.20.1818	10 S	M 18 x 1.5	22	34	17.5	30	63.5	630
25.20.1919	12 S	M 20 x 1.5	24	38	21.5	31	68.85	630
25.20.2020	14 S	M 22 x 1.5	27	40	22	34.5	74.5	640
25.20.2121	16 S	M 24 x 1.5	30	43	24.5	36	79	640
25.20.2222	20 S	M 30 x 2.0	36	48	26.5	44	92	400
25.20.2323	25 S	M 36 x 2.0	46	54	30	50	103.5	250
25.20.2424	30 S	M 42 x 2.0	50	62	35.5	55	117	160
25.20.2525	38 S	M 52 x 2.0	60	72	41	63	135	315

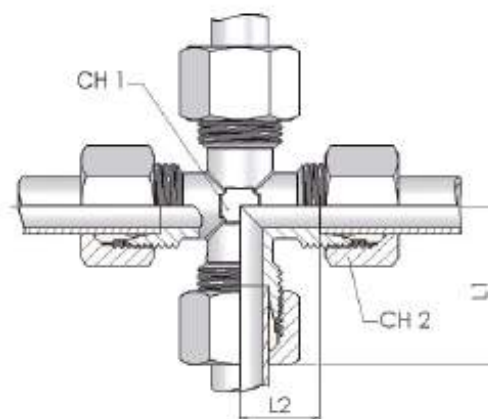
**K CRUZETA**
**25.22**

	Ø TUBO	DIMENSÕES				PRESSÃO
CÓDIGO	mm	CH1	CH2	L1	L2	
25.22.06	6 L	12	14	12	27	315
25.22.07	8 L	12	17	14	29	315
25.22.08	10 L	14	19	15	30	315
25.22.09	12 L	17	22	17	32	315
25.22.10	15 L	19	27	21	36	315
25.22.11	18 L	24	32	23.5	40	
25.22.12	22 L	27	36	27.5	44	160
25.22.16	6 S	12	17	16	31	640
25.22.17	8 S	14	19	17	32	640
25.22.18	10 S	17	22	17.5	34	
25.22.19	12 S	17	24	21.5	38	640
25.22.21	16 S	24	30	24.5	43	400
25.22.22	20 S	27	36	26.5	48	315
25.22.23	25 S	36	46	30	54	315

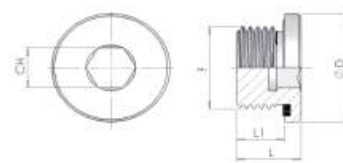
**VSTI TAMPAO MACHO**
**25.84**

	Ø TUBO	ROSCA	DIMENSÕES	
CÓDIGO			L	L1
25.84.10	14	M 10 x 1	12	8
25.84.12	17	M 12 x 1.5	17	12
25.84.14	19	M 14 x1.5	17	12
25.84.16	22	M 16 x1.5	17	12
25.84.18	24	M 18 x 1.5	17	12
25.84.20	26	M 20 x 1.5	19	14
25.84.22	27	M 22 x 1.5	19	14
25.84.24	32	M24x1,5	19	13
25.84.26	32	M 26 x 1.5	21	16
25.84.27	32	M 27 x 1.5	21	16
25.84.33	40	M 33 x 2	22.5	16
25.84.42	50	M 42 x 2	22.5	16

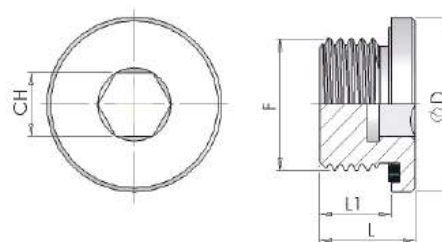
**VSTI TAMPAO MACHO BSP**
**25.81**

**CÓDIGO**

25.81.02

25.81.04

25.81.06

25.81.08

25.81.12

25.81.16

25.81.20

25.81.24

25.81.32

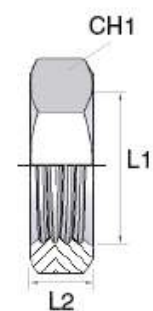
**FEMEA KML**
**25.82**

CÓDIGO	CH1	L1	L2	M
25.82.06	17	10.5	6	M 12 x 1.5
25.82.07	19	12	6	M 14 x 1.5
25.82.08	22	14.5	6	M 16 x 1.5
25.82.10	30	20.5	7	M 22 x 1.5
25.82.11	36	24.5	8	M 26 x 1.5
25.82.18	24	16.5	6	M 18 x 1.5
25.82.19	27	18.5	6	M 20 x 1.5
25.82.21	32	22.5	7	M 24 x 1.5
25.82.22	41	28	8	M 30 x 1.5
25.82.23	46	34	9	M 36 x 2.0

# FLANGES

## PAR FLANGE SAE3000

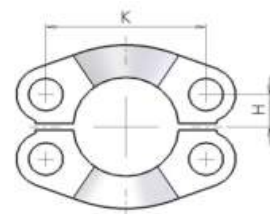
**30.95**

	P/ FLANGE SAE 3000		DIMENSÕES		PRESSÃO TRABALHO
CÓDIGO	in	mm	H	K	BAR
30.95.08	1/2"	30.2	8.7	38.1	207
30.95.12	3/4"	38.10	11.1	47.6	207
30.95.16	1"	44.50	13.1	52.4	207
30.95.20	1.1/4"	50.80	15.1	58.7	207
30.95.24	1.1/2"	60.30	17.8	69.8	207
30.95.32	2"	71.40	21.4	77.8	207
30.95.40	2.1/2"	84.3	25	88	207

## PAR FLANGE SAE6000

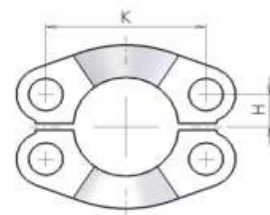
**30.96**

	P/ FLANGE SAE 6000		DIMENSÕES		PRESSÃO TRABALHO
CÓDIGO	in	mm	H	K	BAR
30.96.08	1/2"	31.70	9.2	40.5	413
30.96.12	3/4"	41.30	11.9	50.8	413
30.96.16	1"	47.60	13.9	57.1	413
30.96.20	1.1/4"	54.00	15.8	66.7	413
30.96.24	1.1/2"	63.50	18.2	79.4	413
30.96.32	2"	79.40	22.2	96.8	413

**FLANGE SAE3000 ROSCA FÊMEA BSP**

**30.92**

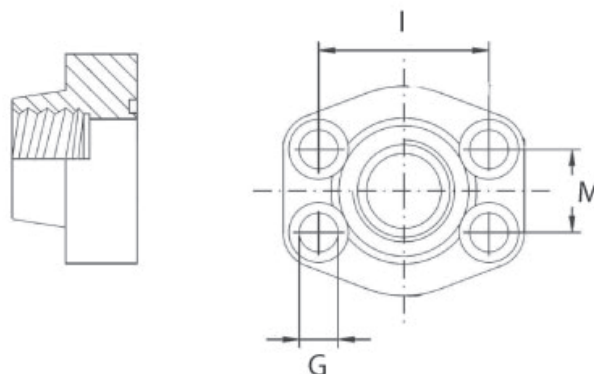

	P/ FLANGE SAE 3000		ROSCA FÊMEA	DIMENSÕES			PRESSÃO TRABALHO
CÓDIGO	In	mm	In	G	I	M	BAR
30.92.0808	1/2"	30.2	1/2"	M 8	38	17.5	348
30.92.1212	3/4"	38.1	3/4"	M 10	47.6	22.2	348
30.92.1616	1"	44.5	1"	M 10	52.4	26.2	348
30.92.2020	1.1/4"	50.8	1.1/4"	M 10	58.7	30.2	278
30.92.2424	1.1/2"	60.3	1.1/2"	M 12	69.85	35.7	210
30.92.3232	2"	71.4	2"	M 12	77.8	42.9	210
30.92.4040	2.1/2"	84.3	2.1/2"	M 12	88.9	50.8	210
30.92.4848	3"	101.6	3"	M 16	106.38	61.93	210

**Flange SAE6000 ROSCA FÊMEA BSP**

**30.93**

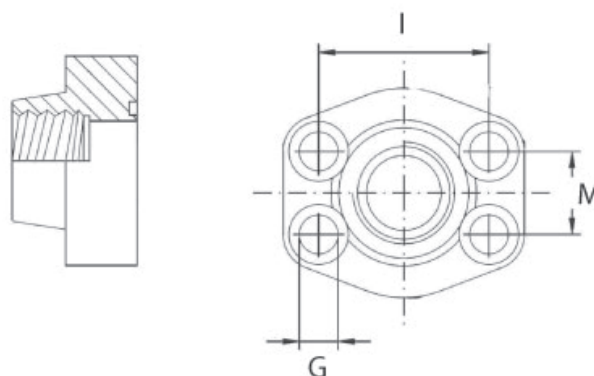

	P/ FLANGE SAE 6000		ROSCA FÊMEA	DIMENSÕES			PRESSÃO TRABALHO
CÓDIGO	In	mm	In	G	I	M	BAR
30.93.0808	1/2	31.8	1/2"	M 8	40.5	18.3	420
30.93.1212	3/4	41.3	3/4"	M 10	50.8	23.8	420
30.93.1616	1"	47.6	1"	M 12	57.1	27.8	420
30.93.2020	1.1/4"	54.0	1.1/4"	M 14	66.7	31.6	420

	P/ FLANGE SAE 6000		ROSCA FÊMEA	DIMENSÕES			PRESSÃO TRABALHO
CÓDIGO	In	mm	In	G	I	M	BAR
30.93.2424	1.1/2	63.5	1.1/2"	M 16	79.4	36.5	420
30.93.3232	2	79.4	2"	M 20	96.8	44.4	420



**CONTRA-FLANGE SAE3000 ROSCA FÊMEA BSP**

**30.90**

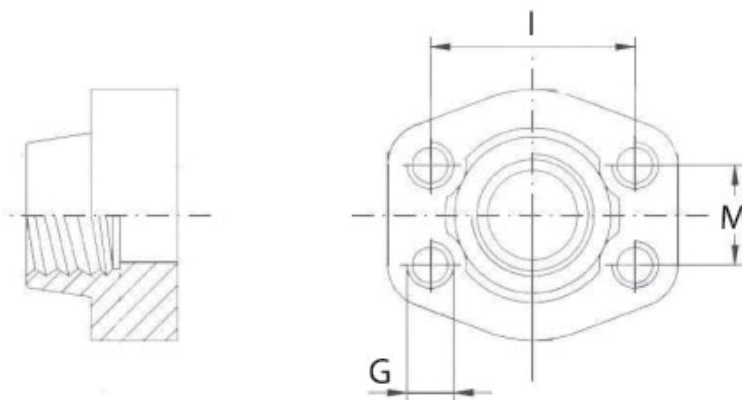

	P/ FLANGE SAE 3000		ROSCA FÊMEA	DIMENSÕES			PRESSÃO TRABALHO
CÓDIGO	In	mm	In	G	I	M	BAR
30.90.0808	1/2"	30.2	1/2"	M 8	38	17.5	348
30.90.1212	3/4"	38.1	3/4"	M 10	47.6	22.2	348
30.90.1616	1"	44.5	1"	M 10	52.4	26.2	348
30.90.2020	1.1/4	50.8	1.1/4"	M 10	58.7	30.2	278
30.90.2424	1.1/2	60.3	1.1/2"	M 12	69.85	35.7	210
30.90.3232	2	71.4	2"	M 12	77.8	42.9	210

**CONTRA-FLANGE SAE6000 ROSCA FÊMEA BSP**

**30.91**

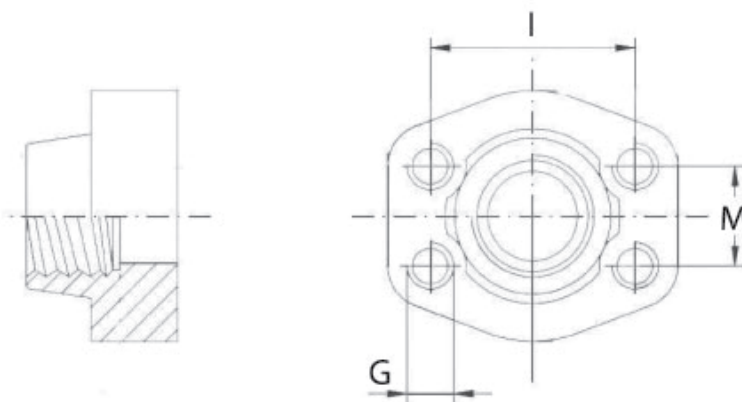

	P/ FLANGE SAE 6000		ROSCA FÊMEA	DIMENSÕES			PRESSÃO TRABALHO
CÓDIGO	In	mm	In	G	I	M	BAR
30.91.0808	1/2	31.8	1/2"	M 8	40.5	18.3	420

	P/ FLANGE SAE 6000		ROSCA FÊMEA	DIMENSÕES			PRESSÃO TRABALHO
CÓDIGO	In	mm	In	G	I	M	BAR
30.91.1212	3/4	41.3	3/4"	M 10	50.8	23.3	420
30.91.1616	1"	47.6	1"	M 12	57.1	27.8	420
30.91.2020	1.1/4	54.0	1.1/4"	M 14	66.7	31.6	420
30.91.2424	1.1/2	63.5	1.1/2"	M 16	79.4	36.5	420
30.91.3232	2"	79.4	2"	M 20	96.8	44.4	420

# ANILHAS E USITOS

## ANILHA DE COBRE BSP

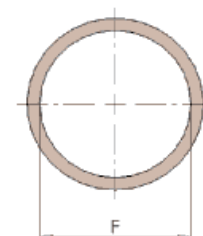
**30.98**

CÓDIGO	F	DI (mm)	DE (mm)
30.98.02	1/8"	10	16
30.98.04	1/4"	13,5	19
30.98.06	3/8"	17	22
30.98.08	1/2"	21	27
30.98.10	5/8"	24	30
30.98.12	3/4"	27	33
30.98.16	1"	33	40
30.98.20	1.1/4"	42	50
30.98.24	1.1/2"	48	55
30.98.32	2"	60	68

## USITO METRICO

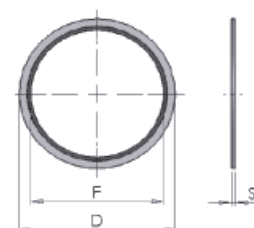
**30.94**

CÓDIGO	F	D
30.94.06	6.7	11
30.94.08	8.7	13
30.94.10	10.7	16
30.94.12	12.7	18
30.94.14	14.7	22
30.94.16	16.7	24
30.94.18	18.7	26
30.94.20	20.7	28
30.94.22	22.7	30
30.94.24	24.7	32

CÓDIGO	F	D
30.94.26	26.7	35
30.94.30	30.7	39
30.94.36	35.9	44.5
30.94.42	42.7	53

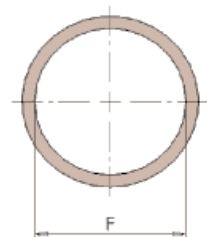
**ANILHA DE COBRE**
**30.99**

CÓDIGO	F	DE (mm)	EXPESSURA
30.99.06	M6	10	1.5
30.99.08	M8	14	1.5
30.99.10	M10	16	1.5
30.99.10/14	M10	14	1.5
30.99.12	M12	18	1.5
30.99.14	M14	20	1.5
30.99.14/18	M14	18	1.5
30.99.16	M16	22	1.5
30.99.18	M18	24	1.5
30.99.20	M20	26	1.5
30.99.22	M22	28	1.5
30.99.24	M24	30	1.5
30.99.26	M26	32	1.5
30.99.28	M28	34	1.5
30.99.30	M30	36	1.5

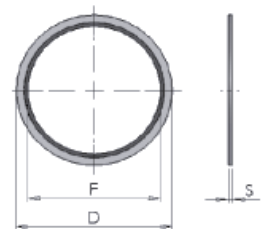
**USITO BSP**
**30.97**

CÓDIGO	F	DI (mm)
30.97.02	1/8"	1/8"
30.97.04	1/4"	13.74
30.97.06	3/8"	17.28
30.97.08	1/2"	21.54

CÓDIGO	F	DI (mm)
30.97.10	5/8"	
30.97.12	3/4"	27.05
30.97.16	12	33.89
30.97.20	1.1/4"	42.93
30.97.24	1.1/2"	48.44
30.97.32	2"	60.58

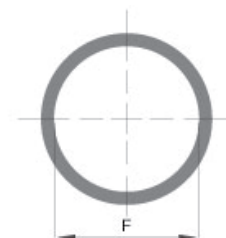
**ANILHA CARTAO BSP Rollmart**
**30.87**

CÓDIGO	Int. mm	Ext. mm	EXPESSURA
30.87.04	13	19	1.5
30.87.06	16.6	22	1.5
30.87.08	20.8	26	1.5
30.87.12	26.4	33	1.5
30.87.16	33	40	1.5
30.87.20	42	50	1.5

**KIT ANILHAS E USITOS**
**30.KIT**





CÓDIGO	DESCRIÇÃO	DADOS TÉCNICOS
30.KIT-02	ANILHA COBRE + USITO (419UN)	
30.KIT-03	USITO BSP + USITO MET (195 UN)	
30.KIT-04	ANILHA COBRE + UST MET (425UN)	

# O-RING

KIT O-RING

OR.KIT



CÓDIGO	DESCRIÇÃO	DADOS TÉCNICOS
OR.KIT.01	KIT O-RING POLGADAS	
OR.KIT.02	KIT O-RING MILIMETROS	
OR.KIT.03	KIT O-RING NBR-90 P/ MACHO OR	

## ÍNDICE

### A

ADAPTADOR M/F BSP 13  
ADAPTADOR M/F BSP x MET. 38  
ADAPTADOR M/F BSP x ORFS 101  
ADAPTADOR M/F GIRATORIO UNF x JIC 62  
ANILHA CARTAO BSP Rollmart 149  
ANILHA DE COBRE 148  
ANILHA DE COBRE BSP 147

### B

BANJO C/ROSCA GAS 48  
BANJO C/ROSCA MET. 49  
BICONE 106  
BICONE JIC 84  
BUTZEN 125

### C

CASQ. M/F GIRATORIO JIC x JIC 61  
CASQ. REDUCAO M/M BSP 12  
CASQ. TRESPASSE M/M BSP 17  
CASQUILHO JIC 53  
CASQUILHO JIC x BSP 56  
CASQUILHO JIC x BSPT 57  
CASQUILHO JIC X JIC 54  
CASQUILHO JIC x MET 59  
CASQUILHO M/M 36  
CASQUILHO M/M BSP 10  
CASQUILHO M/M BSP/NPT 11  
CASQUILHO M/M JIC x UNF 58  
CASQUILHO M/M ORFS 88  
CASQUILHO M/M ORFS x UNF 95  
CASQUILHO ORFS x MÉTRICO 102  
CASQUILHO REDUÇÃO M/M BSP/MÉTRICO 60º 37  
CASQUILHO TRESPASSE JIC 55  
CASQUILHO TRESPASSE ORFS 89  
CASQUILO M/M ORFS BSP 88  
CBB JOELHO TUBO BSP ORIENT. 133  
CONTRA-FLANGE SAE3000 ROSCA FÊMEA BSP 145  
CONTRA-FLANGE SAE6000 ROSCA FÊMEA BSP 145

### E

EGE JUNCAO REGULAVEL BSP 120  
EGE JUNCAO REGULAVEL MET. 121  
EL REGULAVEL 138  
ET REGULAVEL 137  
EW JOELHO REGULAVEL 131

### F

FEMEA KML 141  
FLANGE SAE3000 ROSCA FÊMEA BSP 143  
Flange SAE6000 ROSCA FÊMEA BSP 143

### G

GAI JUNCAO TUBO / ROSCA BSP 117  
GAI JUNCAO TUBO / ROSCA MET. 118  
GE TUBO BSP 108  
GE TUBO BSP - WD (Vedante) 113

GE TUBO BSPT 112  
GE TUBO MÉTRICA 110  
G JUNCAO TUBO TUBO 114  
GR REDUCAO TUBO TUBO 115  
GZ UNIAO F/F 124

### J

JOELHO 45º JIC x BSP ORIENT. 65  
JOELHO 45º JIC x MET ORIENT. 66  
JOELHO 45º JIC x UNF ORIENT. 64  
JOELHO 45º M/F BSPT/BSP GIRATÓRIO 29  
JOELHO 45º M/F GIRATÓRIO JIC 67  
JOELHO 45º M/M ORFS x BSP 99  
JOELHO 45º M/M ORFS x UNF 95  
JOELHO 45º M/M ORIENTAVEL BSP 28  
JOELHO 90º M/M ORIENTAVEL BSP 21  
JOELHO 90º ORFS x BSP ORIENTAVEL 100  
JOELHO 90º ORFS x MÉTRICO ORIENT. 103  
JOELHO 90º ORFS x UNF ORIENTAVEL 97  
JOELHO 90º TRESPASSE JIC 74  
JOELHO BSP x UNF ORIENT. 73  
JOELHO F/F GIRATORIO BSP 27  
JOELHO FF BSP 25  
JOELHO JIC 68  
JOELHO JIC x BSP ORIENT. 71  
JOELHO JIC x BSPT 69  
JOELHO JIC x MET ORIENT. 72  
JOELHO M/F BSP ORIENTÁVEL / GIRATÓRIO 23  
JOELHO M/F GIRATORIO BSP 22  
JOELHO M/F GIRATORIO JIC 75  
JOELHO M/F ORFS 91  
JOELHO M/M BSP-BSPT 20  
JOELHO M/M JIC x UNF ORIENT. 70  
JOELHO M/M ORFS 90

### K

K CRUZETA 139  
KIT ANILHAS E USITOS 149  
KIT O-RING 150  
KOR REDUCAO REGULAVEL 126

### M

MAVE JUNCAO MANOMETRO. 116  
MAV JUNCAO MANOMETRO 119

### P

PARAFUSO BANJO BSP 44  
PARAFUSO BANJO DUPLO BSP 45  
PARAFUSO BANJO DUPLO MET. 47  
PARAFUSO BANJO MET. 46  
PAR FLANGE SAE3000 142  
PAR FLANGE SAE6000 142  
PORCA 107  
PORCA BSP 50  
PORCA JIC 83, 85  
PROLONGAMENTO F/F BSP 16  
PROLONGAMENTO M/F BSP LONGO 14

## R

RACORD F. GIRATORIO JIC x M. BSP 63  
RACORD JIC x F. BSP 60  
REDUCAO BSP M/F 14  
RHD VALV. DE RETENÇÃO 123

## S

SV JUNCAO TRESPASSE 122  
SWVE BANJO BSP 134  
SWVE BANJO MÉTRICO 135  
SWVE WHS BANJO 136

## T

TAMPAO FEMEA JIC 87  
TAMPAO FEMEA MET 50  
TAMPAO FEMEA ORFS 105  
TAMPAO GIRATORIO FEMEA BSP 41  
TAMPAO MACHO BSP 39  
TAMPAO MACHO JIC 86  
TAMPAO MACHO MET 51  
TAMPAO MACHO ORFS 104  
Tampão Macho Cônico DIN906 42, 43  
TE BSP M/M FEMEA CENTRAL 31  
TE BSP M/M FEMEA LATERAL 32  
TE FEMEA BSP 30  
TE M/M BSP ORIENTAVEL CENTRAL 35  
TE M/M BSP ORIENTAVEL LATERAL 33  
TE MACHO BSP 34  
T JIC 76  
T JIC M/M FEMEA CENTRAL 81

T JIC M/M FEMEA LATERAL 82  
T JIC M/M ORINT. LATERAL UNF 78  
T JIC x BSP CENTRAL 79  
T JIC x BSP LATERAL 80  
T M/M JIC X UNF CENTRAL ORIENT. 77  
T M/M ORFS 92  
T M/M ORFS x UNF CENTRAL 98  
T ORFS M/M FEMEA CENTRAL 94  
T ORFS M/M FEMEA LATERAL 93  
T TUBO TUBO 136

## U

UNIAO CURVA F/F 26  
UNIAO CURVA M/F 24  
UNIAO F/F GIRATORIA BSP 19  
UNIAO M/F GIRATORIA 18  
UNIÃO F/F GIRATÓRIA JIC 52  
USITO BSP 148  
USITO METRICO 147

## V

VSTI TAMPAO MACHO 140  
VSTI TAMPAO MACHO BSP 40, 141

## W

WE JOELHO TUBO BSPT 128  
WE JOELHO TUBO MET 129  
W JOELHO TUBO TUBO 130  
WSV JOELHO TRESPASSE 132